

BOARDWALK SHOPPES II

RETAIL SPACE AVAILABLE FOR LEASE
IN ALTAMONTE SPRINGS

📍 1076 W SR 436 | ALTAMONTE SPRINGS, FL 32714



LOCATED OFF MAJOR
THOROUGHFARE, SR 436



ENTRANCE POSITIONED AT
HIGH TRAFFIC SIGNALIZED
INTERSECTION

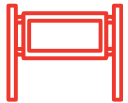

MONUMENT SIGNAGE
OPPORTUNITY

JOIN THE DIVERSE TENANT LINEUP:



BLOOM
BODY ART

4 PETS[®]

EST. 2011



LICENSED REAL ESTATE BROKER



BOARDWALK SHOPPES II



PROPERTY HIGHLIGHTS:

- **AVAILABLE: 2,209 SF**
- Located on SR 436, a major thoroughfare through Altamonte Springs, Longwood, and more
- Signalized intersection at entrance on a busy retail corridor
- Monument signage opportunity
- Newly paved parking lot
- High Traffic Counts - 57,500 + cars traveling on SR 436 daily

📍 ALTAMONTE SPRINGS

Altamonte Springs is a suburban city just north of Orlando, boasting a diverse economy with a mix of retail, healthcare, and service industries. The city is well connected by major highways such as I-4, making it an idyllic location for business professionals and families traveling to Orlando and other areas of Central Florida.

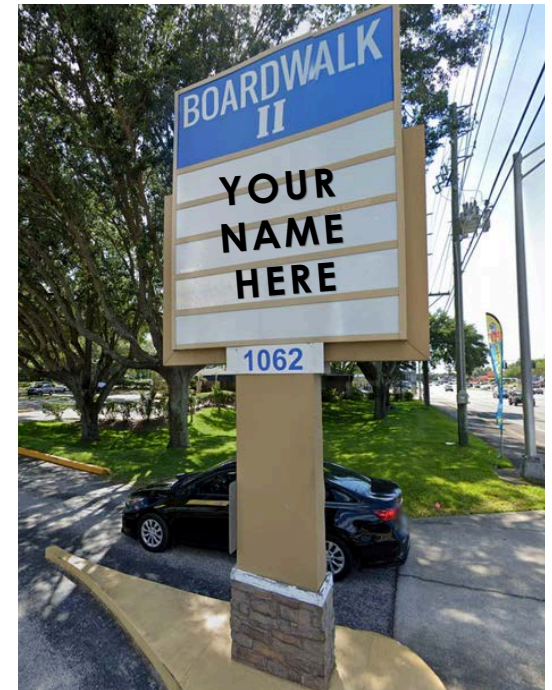

SITE PLAN

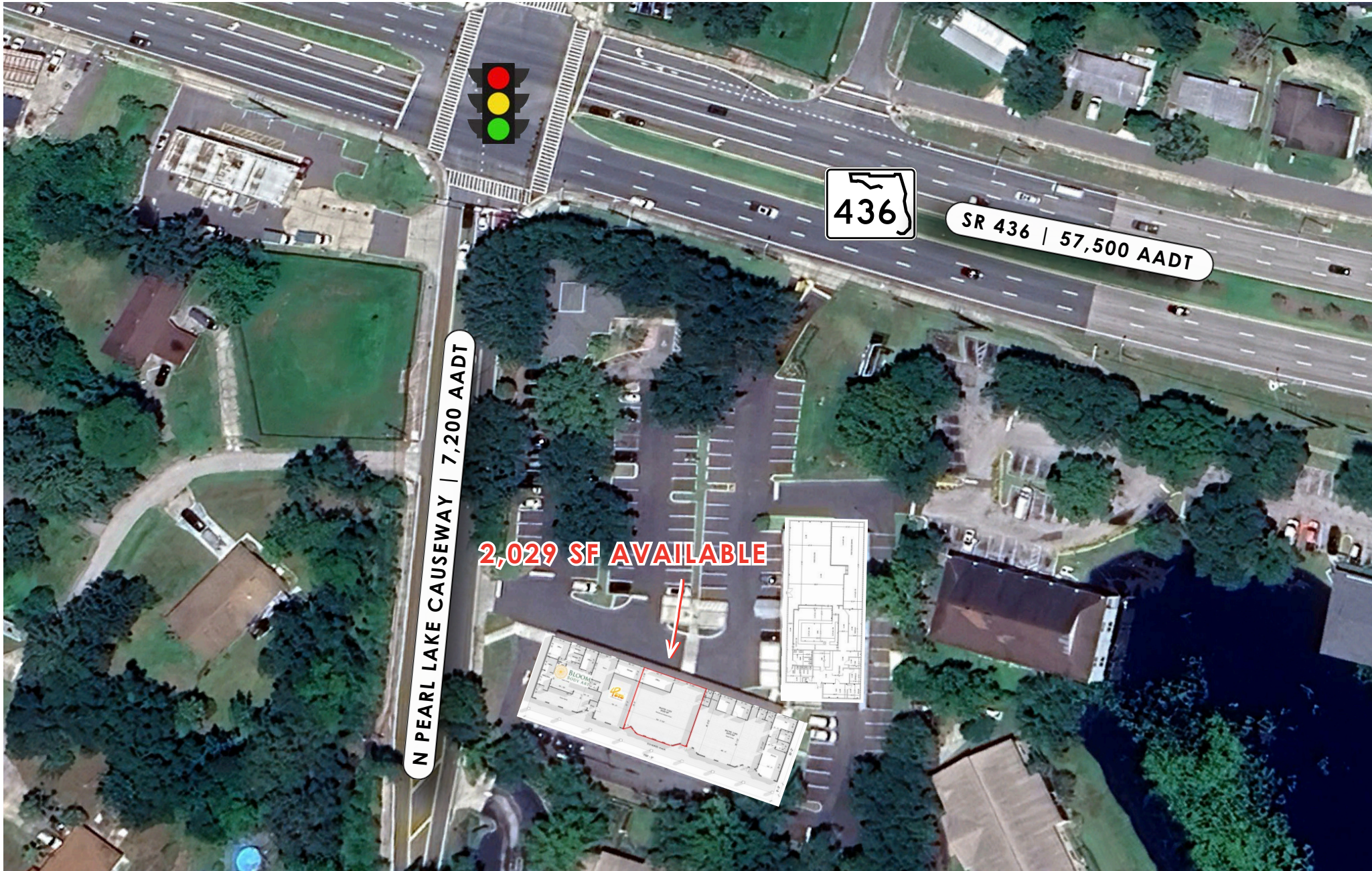

BOARDWALK SHOPPES II

SITE PLAN

2,029 SF AVAILABLE →

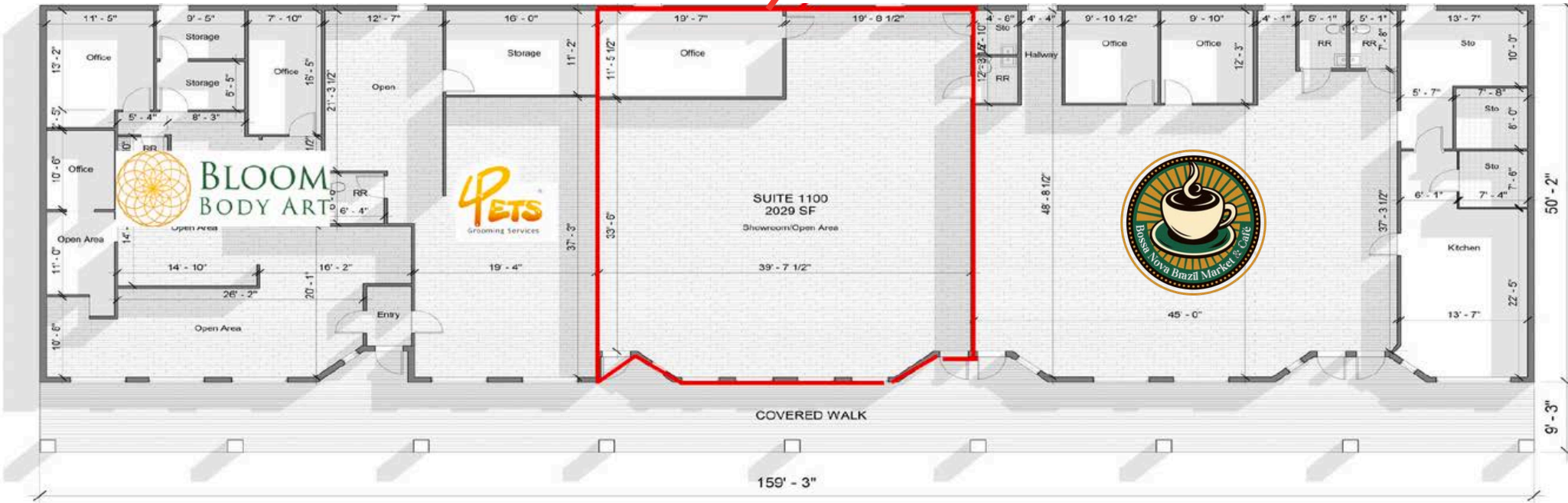
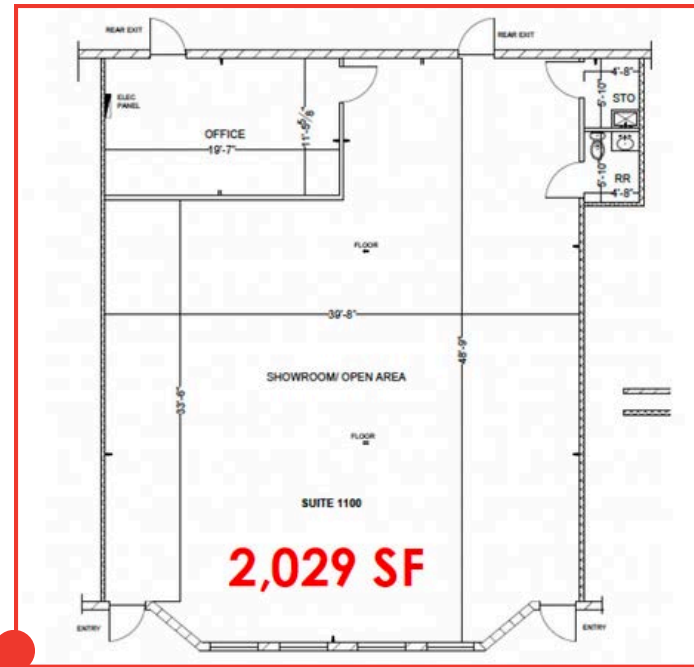

SUITE 1000
BLOOM BODY ART
1,683 SF

SUITE 1050
4PETS
1,300 SF

SUITE 1100
AVAILABLE
2,029 SF

SUITE 1150
BOSA NOVA BRAZIL MARKET & CAFE
2,870 SF

SITE PLAN

LEASED

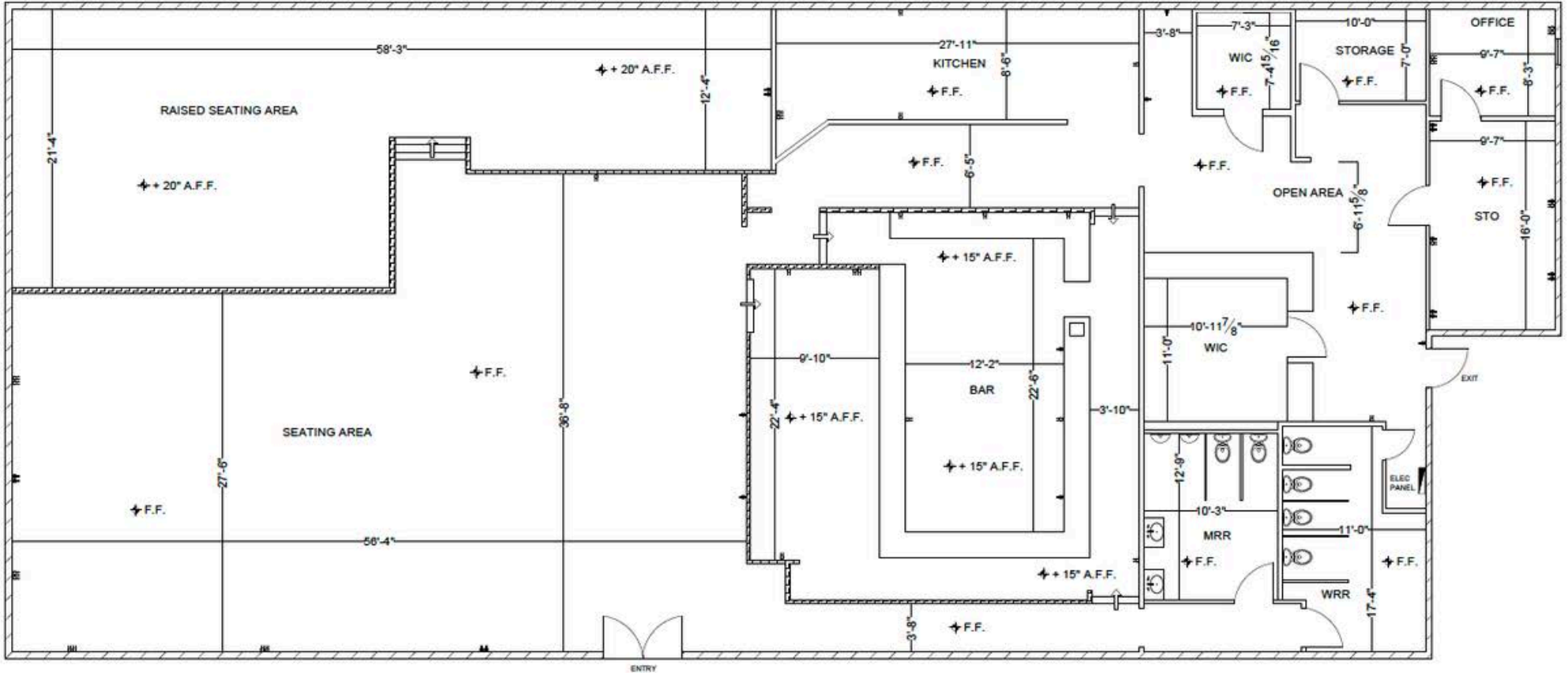

FREESTANDING 2ND GENERATION RESTAURANT SPACE
LEASE SIGNED
5,760 SF

DEMOGRAPHICS

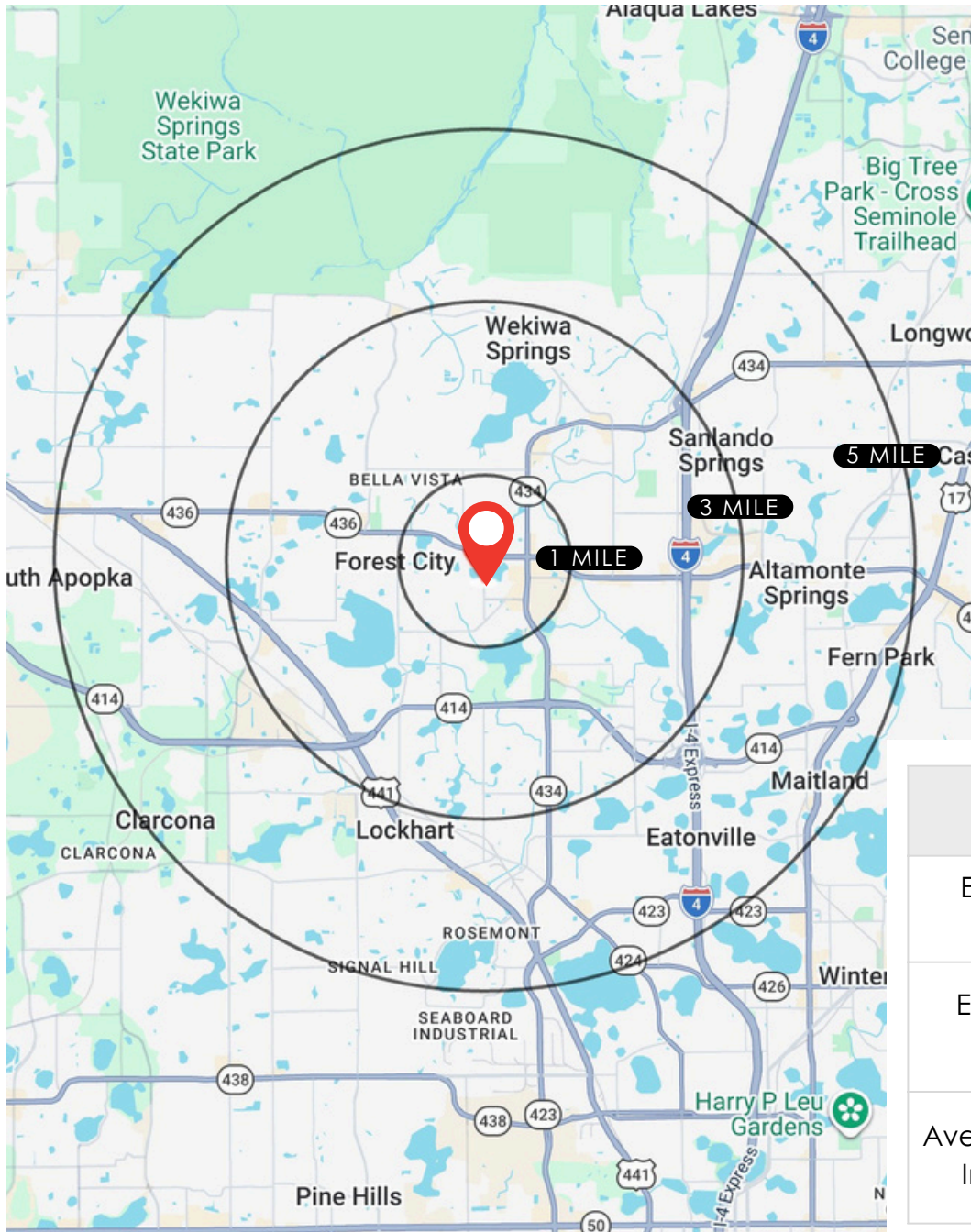

AFFLUENT, HIGH NET WORTH TRADE AREA

\$1.02M **AVG. HOUSEHOLD NET WORTH**
(3 Mile Radius)

Affluent household net worths exceeding \$1 million, supports premium retail.

\$108,415 **AVG. HOUSEHOLD INCOME**
(3 Mile Radius)

Exceptional household wealth, with average household incomes exceeding \$108,000 within 3 miles.

DENSE, ESTABLISHED TRADE AREA

222,285 **EST. POPULATION (2025)**
(5 Mile Radius)

A highly populated corridor, delivering consistent daily traffic from a large and stable residential base.

67,854 **TOTAL EMPLOYEES**
(3 Mile Radius)

A dense daytime population supports sustained weekday traffic.

	1 MILE	3 MILE	5 MILE
Est. Population (2025)	13,349	106,984	222,285
Est. Households (2025)	5,577	45,571	91,555
Average Household Income (2025)	\$106,575	\$108,415	\$105,767

BOARDWALK SHOPPES II TRADE AREA

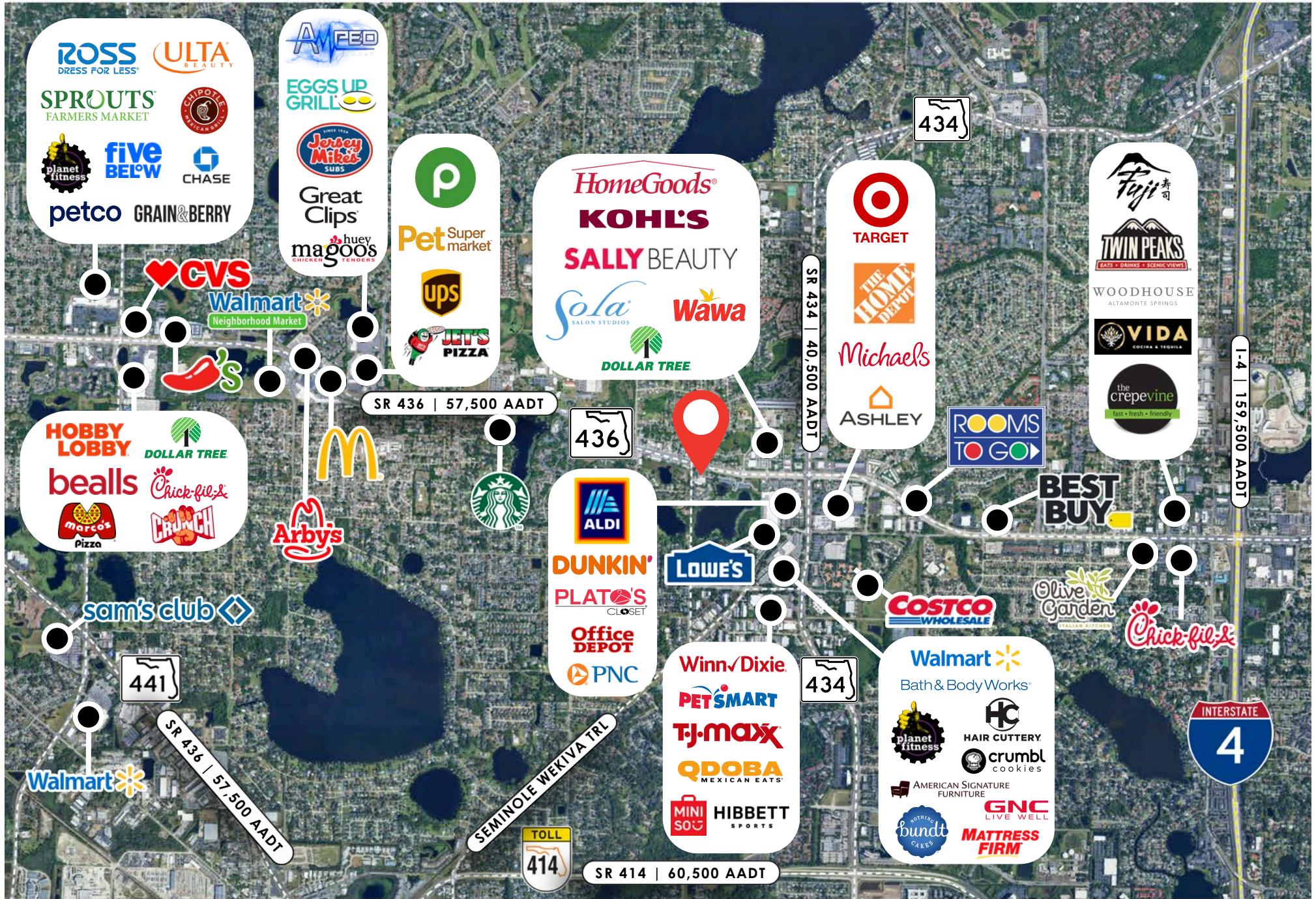



FOR MORE INFORMATION ON BOARDWALK SHOPPES II:

CONTACT

SAMMY GABBAI

LEASING ASSOCIATE

sammy@acrefl.com

407.402.9194

SANDI BARGFREDE

MANAGING PARTNER

sandi@acrefl.com

407.491.8149



 ACREFLORIDA  ACREFLORIDA  ACREFLORIDA

407.392.2055
WWW.ACREFL.COM
INFO@ACREFL.COM

This presentation is provided for informational purposes only and does not constitute legal, financial, or investment advice. It is intended solely to provide general information about the properties and services offered by ACRE Commercial, its affiliates, partners, and subsidiaries. All information contained herein is obtained from sources deemed reliable; however, we make no representations or warranties, express or implied, regarding the accuracy, completeness, or reliability of any information provided. Prospective buyers, sellers, landlords, tenants, investors, or other parties should conduct their own due diligence and consult with appropriate professionals (including legal, financial, and real estate advisors) before making any decisions or entering into any agreements. ©2026. All rights reserved.

LICENSED REAL ESTATE BROKER