



TD Bank

12200 W Colonial Dr, Winter Garden, FL 34787

EXCHANGE PLACE
REAL ESTATE & DEVELOPMENT



PROPERTY OVERVIEW

PROPERTY OVERVIEW

Located on Hwy 50 and seconds from the Florida turnpike, this modern office suite is perfect for many companies in the Central Florida market. Enjoy being nearby to local coffee shops, new restaurants, and an easy commute.



PROPERTY DETAILS



PROPERTY NAME	TD Bank
PROPERTY ADDRESS	12200 W Colonial Dr
YEAR BUILT	2000
# OF FLOORS	3
AVAILABLE UNITS	2
PROPERTY TYPE	Office



PROPERTY HIGHLIGHTS

PRIME LOCATION

Minutes from Plant St. and Downtown Winter Garden. Close to dozens of eateries and shopping boutiques. Seconds from 429, W Colonial, 408, and Florida Turnpike.

MODERN DESIGN

Modern office suites are the perfect locations for growing Central Florida companies.





AVAILABLE UNITS

FLOOR	UNIT	SQ FT	AVAILABILITY
2	200A	865 SF	October 1, 2025
3	300G	836 SF	October 1, 2025

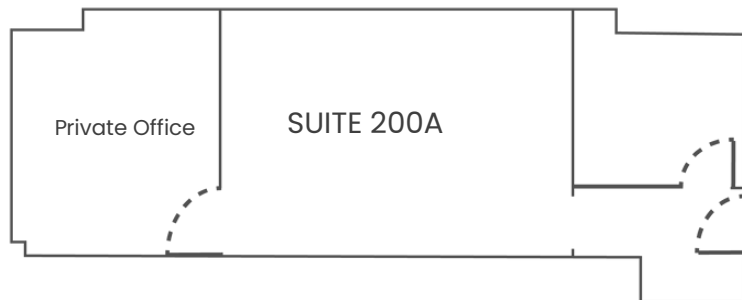

Size: 867 SF

Rate: \$32/SF/YR

CAM: \$8

Available Oct 2025

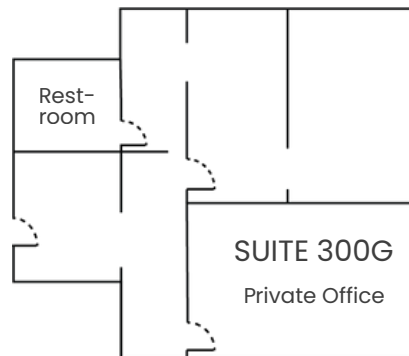

Size: 836 SF

Rate: \$36.49/SF/YR

CAM: \$8

Available Oct 2025

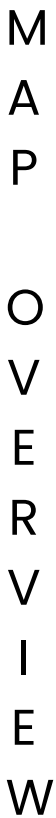

Turnpike
429

TD Bank

Offer subject to withdrawal from the market, due to prior sale of cancellation without notice. All information contained here in is believed to be accurate but is not warranted.

TD Bank

12200 W Colonial Dr, Winter Garden, FL 34787

SHARON WILLIAMS | BROKER

☎ c. 689.407.5818 | o. 407.347.4247

✉ sharon@exchangeplace.net

🌐 www.exchangeplace.net

EXCHANGE PLACE
REAL ESTATE & DEVELOPMENT

Offer subject to withdrawal from the market, due to prior sale of cancellation without notice. All information contained here in is believed to be accurate but is not warranted.