



SEC Canoa Ranch & Camino Del Sol

GREEN VALLEY, AZ | 85622

FOR SALE



Commercial Zoned Corner Lot

±86,465 SF or 1.98 AC lot

LOCATED 1.5 Mi North of the only regional hospital in the area, Santa Cruz Valley Regional Hospital

ADJACENT to Canoa Ranch Golf Resort and Green Valley Golf Course

LESS than 1 Mi to Interstate 19 (to the East)

ZONED CB-2, Pima County

CALL for pricing

TIM HURLEY
602.513.5168
tim.hurley@kidder.com

TRASK SWITZENBERG
480.363.0670
trask.switzenberg@kidder.com

FOR SALE

SEC Canoa Ranch & Camino Del Sol

GREEN VALLEY, AZ | 85622

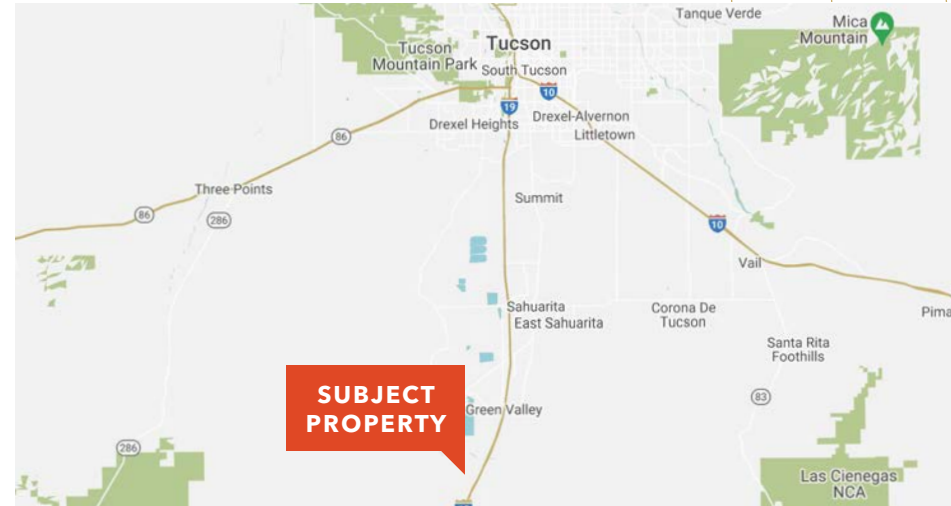

DEMOGRAPHICS

2021	1 Mile	3 Miles	5 Miles
Population	1,916	7,251	12,978
Households	989	4,006	7,088
Avg HH Income	\$103,324	\$86,862	\$80,297
Daytime Employment	152	590	1,864

TIM HURLEY
602.513.5168
tim.hurley@kidders.com

TRASK SWITZENBERG
480.363.0670
trask.switzenberg@kidders.com

KIDDER.COM

This information supplied herein is from sources we deem reliable. It is provided without any representation, warranty, or guarantee, expressed or implied as to its accuracy. Prospective Buyer or Tenant should conduct an independent investigation and verification of all matters deemed to be material, including, but not limited to, statements of income and expenses. Consult your attorney, accountant, or other professional advisor.



FOR SALE

SEC Canoa Ranch & Camino Del Sol

GREEN VALLEY, AZ | 85622



KIDDER.COM

This information supplied herein is from sources we deem reliable. It is provided without any representation, warranty, or guarantee, expressed or implied as to its accuracy. Prospective Buyer or Tenant should conduct an independent investigation and verification of all matters deemed to be material, including, but not limited to, statements of income and expenses. Consult your attorney, accountant, or other professional advisor.

km Kidder Mathews