

# 400 SW 8th Street

Des Moines, Iowa  
[www.cbre.com/desmoines](http://www.cbre.com/desmoines)

## Flex/Office Space

Office space available for lease located in the vibrant Riverpoint Business District, which is just south of Des Moines' Central Business District. The property is currently zoned DX-2 allowing for office or flex users. The building is directly adjacent to a variety of new living and retail amenities as well as multiple public transit routes, which allows for quick and easy access to area activities and businesses.

### Available Space

- + 8,000 - 16,047 SF For Lease
- + Building: 40,080 SF total

### Pricing

- + Base Lease Rate: \$8.50 PSF
- + CAMIT: \$9.50/SF (Full Service)
- + Sale Price: \$3,600,000 (\$90/SF)

### Space Features

- + Dock high loading area
- + Exterior Signage and Possible Monument Signage
- + Centurylink fiber optic service available



# Building Features

- + Building Size: 40,080 RSF
- + Free on-site surface parking available
- + Owned and professionally managed by Hubbell Realty Company
- + Adjacent to multiple mass transit routes
- + Convenient access to downtown CBD. A central location that provides convenient access to all of the Metro.
- + Nearby amenities including hotels with conference facilities, restaurants, retail, medical, and Court Avenue Entertainment District

Demographics	1-Mile	3-Mile	5-Mile
Population 2023	10,328	99,213	208,699
Daytime Population 2023	61,022	161,400	255,892
Median Age 2023	35.6	34.3	36.2
Average Household Income 2023	\$85,069	\$77,332	\$81,488



# Floor Plan

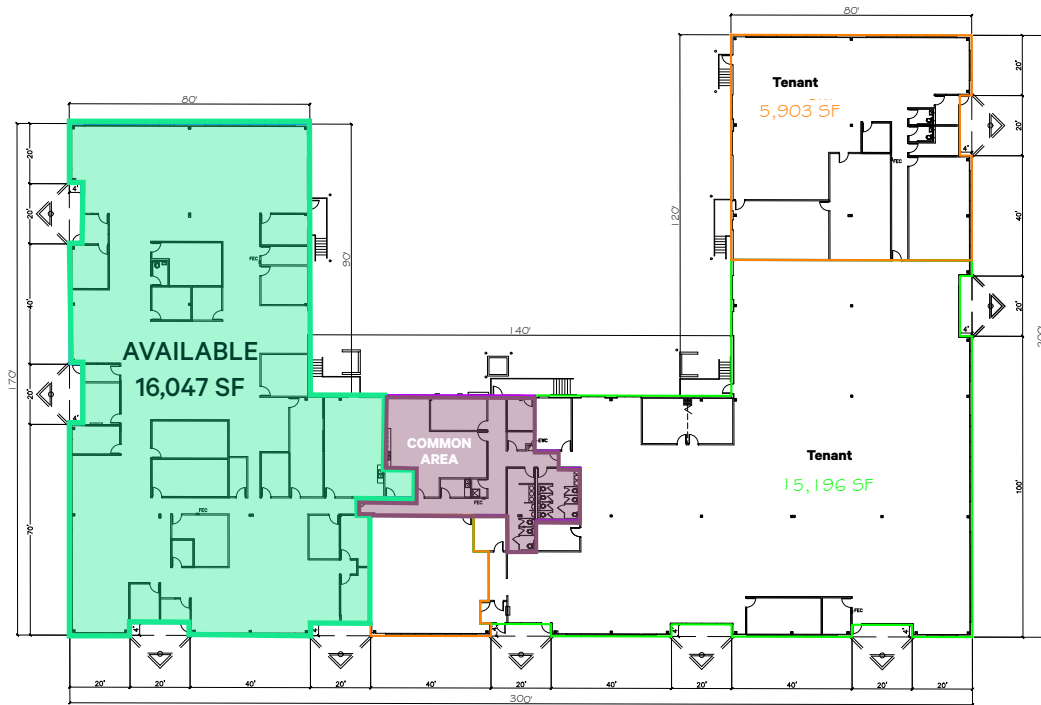

# Photos

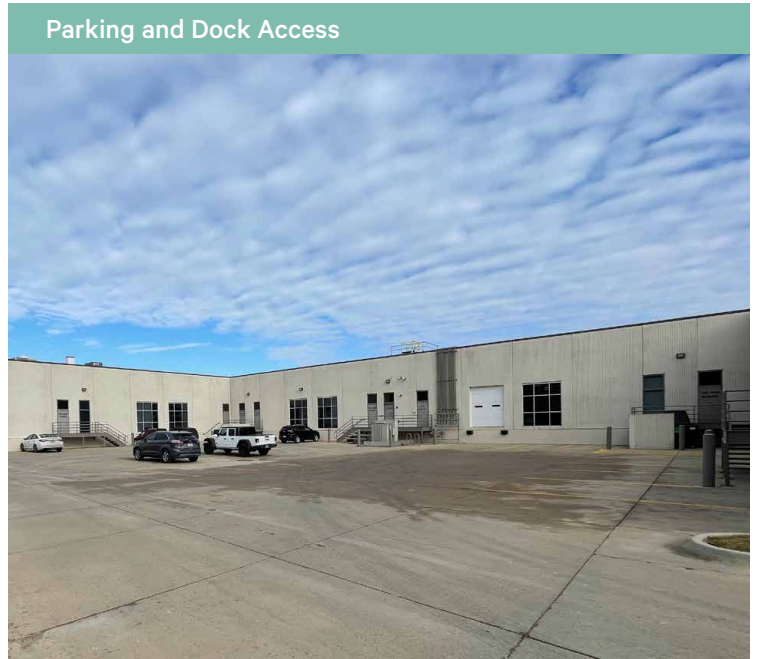

# Location



## Contact Us

### Bill Wright

Senior Vice President  
+1 515 210 3050  
bill.wright2@cbre.com  
Licensed in the State of Iowa.

### TJ Jacobs, CCIM

Vice President  
+1 515 415 6119  
thomas.jacobs@cbre.com  
Licensed in the State of Iowa.

### Chris Pendroy, CCIM, SIOR

Senior Vice President  
+1 515 402 6600  
chris.pendroy@cbre.com  
Licensed in the State of Iowa.

### Grant Wright, CCIM

First Vice President  
+1 515 745 5113  
grant.wright@cbre.com  
Licensed in the State of Iowa.

© 2024 CBRE, Inc. All rights reserved. This information has been obtained from sources believed reliable, but has not been verified for accuracy or completeness. You should conduct a careful, independent investigation of the property and verify all information. Any reliance on this information is solely at your own risk. CBRE and the CBRE logo are service marks of CBRE, Inc. All other marks displayed on this document are the property of their respective owners, and the use of such logos does not imply any affiliation with or endorsement of CBRE. Photos herein are the property of their respective owners. Use of these images without the express written consent of the owner is prohibited.