

NEW LEASES SIGNED!

drybar® **SISTERS** *of the*
COFFEE CO **WAY WEST**



JACK\$TRAW

Ground Floor Commercial Leasing Opportunities

RETAIL & RESTAURANT SPACE

310 SW INDUSTRIAL WAY, BEND, OR 97702

COMPASS 
COMMERCIAL

REAL ESTATE
SERVICES

1

ABOUT

JACKSTRAW



Property Information

4.7 ACRES | 480,000 SF | 7 STORIES

- 313 residential units
- Mix of rental townhomes and apartments
- 10,207 SF of ground floor commercial with opportunities for restaurant or retail spaces
- Environmentally friendly building
- Lava Pass - a community focused living-street for retailers, pedestrians, cyclists and low-speed motor vehicles between Box Factory and Jackstraw
- Residential amenities include pet facilities and rooftop terraces
- Ample parking to be shared with retail and residential

COMMERCIAL SPACE: 952-5,716 SF
CONTACT BROKER FOR LEASE RATES

AVAILABLE NOW!

2 FLOOR PLAN

JACKSTRAW

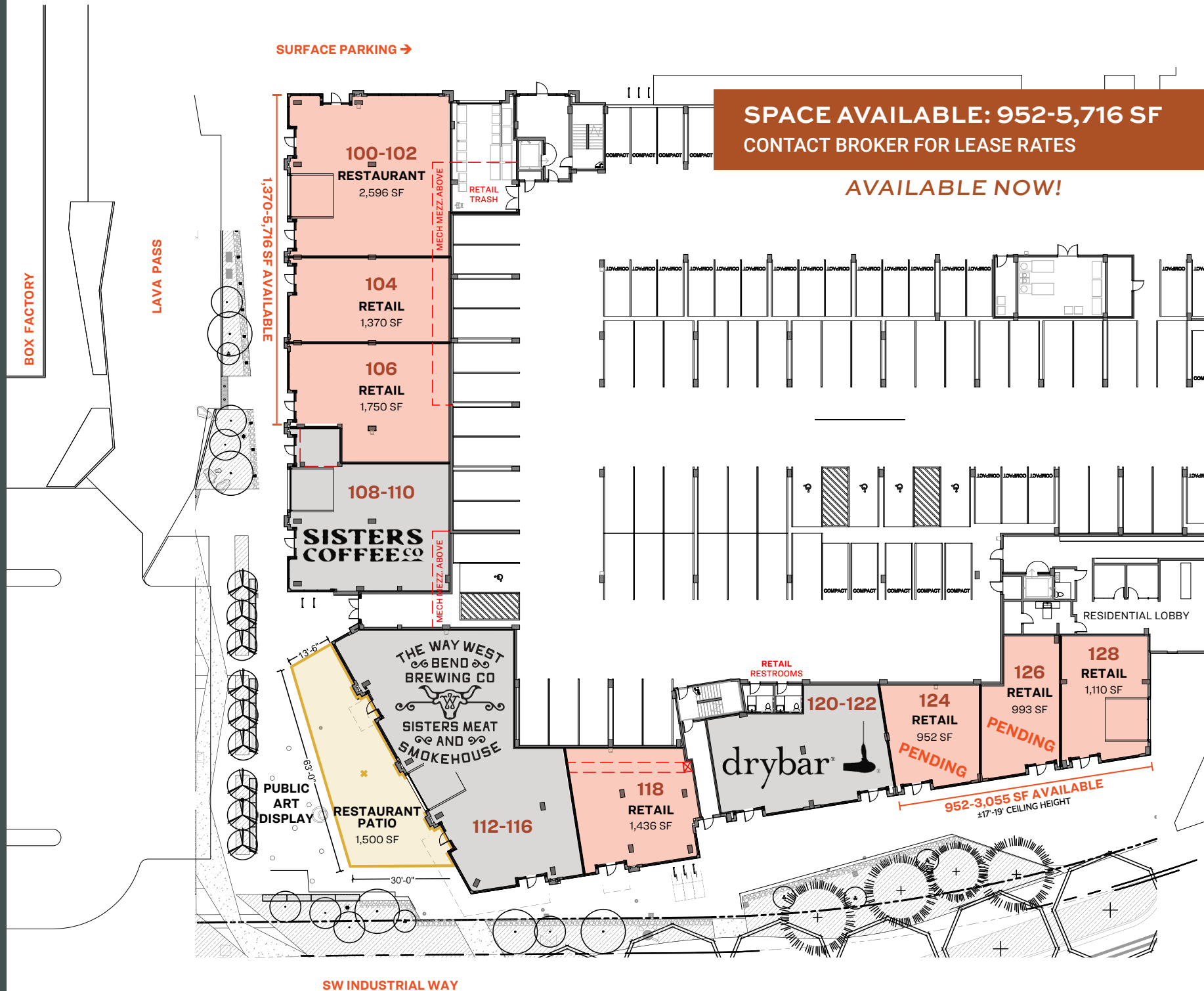

3 LOCATION

Jackstraw is centrally located to access a full range of outdoor recreation, including parks, trails, the Deschutes river, lakes, and more.

- Surrounded by beautifully converted mill buildings, which now house retail and restaurants with a unique historical charm
- Ideally situated between The Old Mill District to the south and downtown Bend to the north, making it a bridge between two quintessential shopping districts
- Adjacent to the Box Factory for diverse dining, shopping, and entertainment options
- Close to the Deschutes River and outdoor recreation areas for active lifestyles
- Across the street from Market of Choice, an Oregon grocer offering the finest and freshest organic, natural, and conventional products
- Conveniently located near major transportation routes, making commuting a breeze, whether by car, bike, or public transit
- Just a few blocks from Hwy 97/Bend Parkway, the main thoroughfare to and from Bend

95
BIKE SCORE
Bikers Paradise

76
WALK SCORE
Very Walkable



JACKSTRAW



Rendering of Lava Pass for illustrative purposes only. Final design may vary.

COMPASS
COMMERCIAL

**REAL ESTATE
SERVICES**

FOR COMMERCIAL LEASING INFORMATION, CONTACT:

Russell Huntamer, CCIM

rhuntamer@compasscommercial.com

541.419.2634

Jay Lyons, SIOR, CCIM

jlyons@compasscommercial.com

541.410.6519

Eli Harrison, Broker

eharrison@compasscommercial.com

541.977.2890

Brokers are licensed in the state of Oregon. This information has been furnished from sources we deem reliable, but for which we assume no liability. This is an exclusive listing. The information contained herein is given in confidence with the understanding that all negotiations pertaining to this property be handled through Compass Commercial Real Estate Services. All measurements are approximate.