

Waterfront on West Bay 4.4 Acres

Moonlight Bay Drive, Panama City Beach, Florida

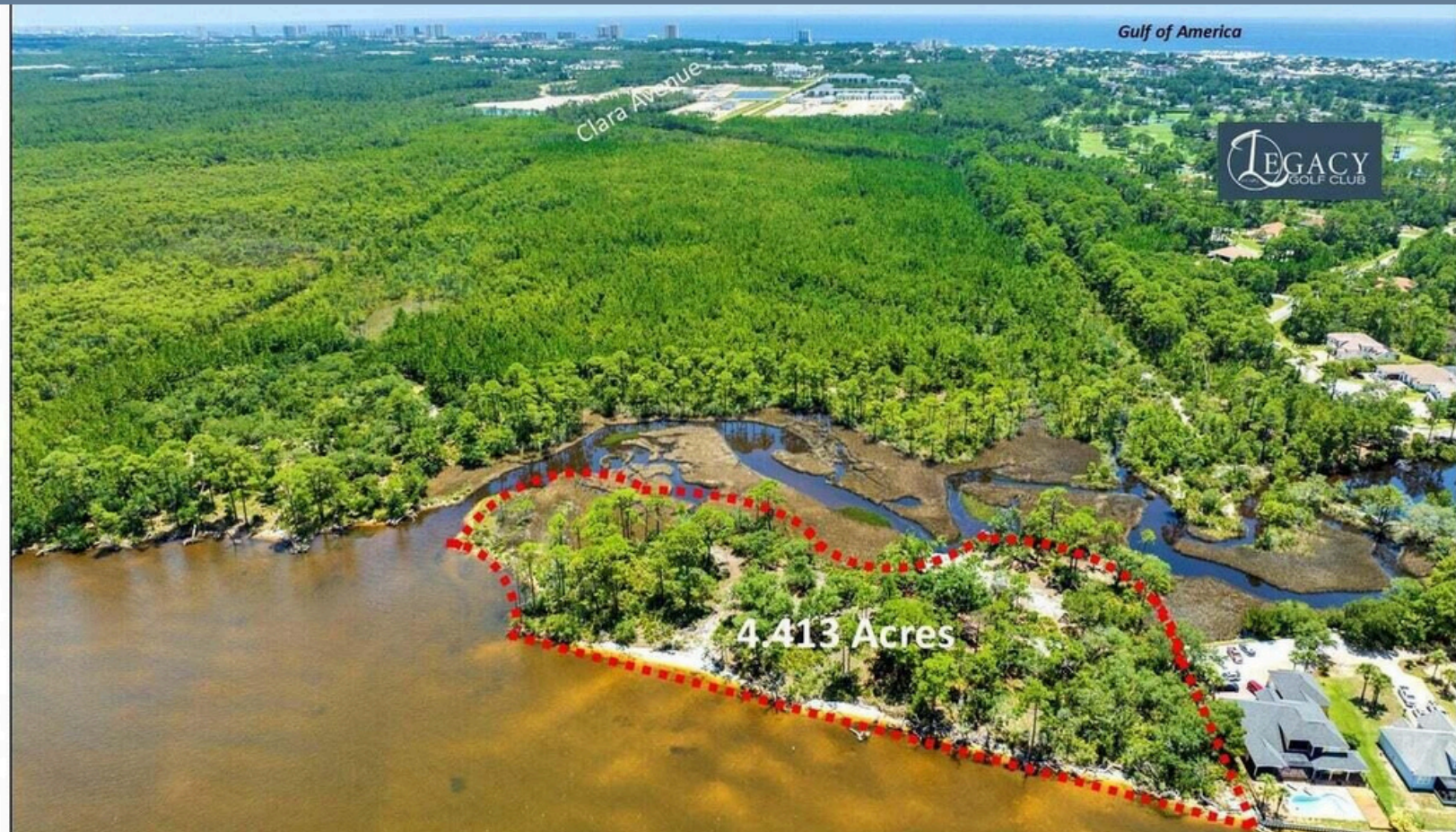

Location: Moonlight Bay Drive
Panama City Beach,
FL 32407

Acreage 4.4+/- Acres - 700' Waterfront

Zoning: PUD
Conservation

List Price: \$2,000,000

Gorgeous +/-4.4 acre secluded property on West Bay. Located at the east-end of Moonlight Bay Drive, which dead-ends into the property. It is known as the 'Oak Grove' as the property has several large oak trees. West Bay on the north side with expansive views across the Bay and a bayou on the south side. Zoned Planned Unit Development (P.U.D.) within the City of Panama City Beach. We believe the highest and best use is single-family residential development. Several large estate sized Bay-front lots could be developed, or one massive estate. The property is accessed via a 30' access easement.. Conceptual site plans, wetlands delineation, surveys and maps are available.

Chris McCall, SIOR
Senior Director/Partner
850.814.9889
Chris1@CountsRealEstate.com



www.CountsCommercial.com

INFORMATION IS BELIEVED TO BE ACCURATE BUT IS NOT WARRANTED OR
GUARANTEED AND SHOULD BE INDEPENDANTLY VERIFIED.



SIOR®

INDUSTRIAL & OFFICE
SPECIALIST

000 Moonlight Bay Drive, Panama City Beach, FL

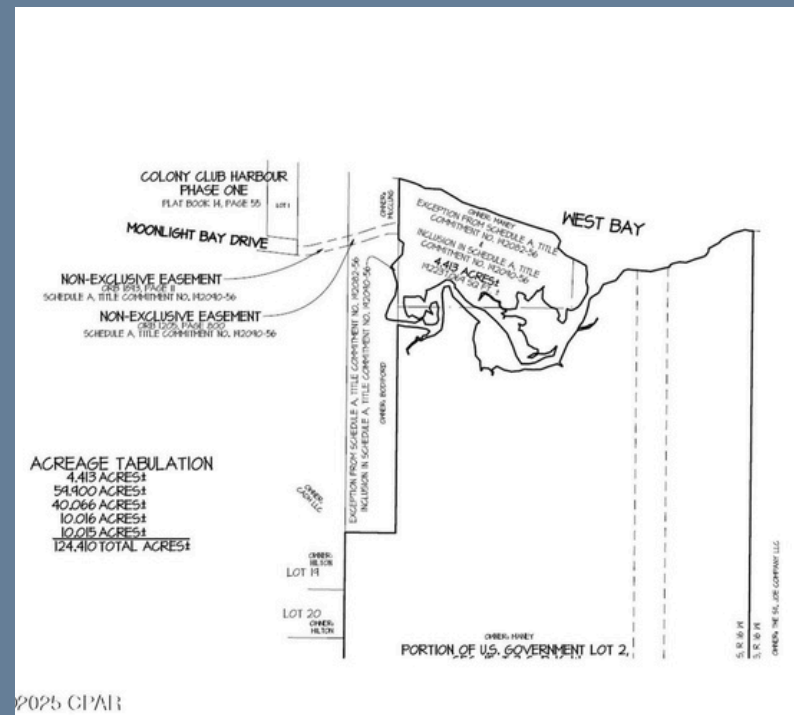

850.814.9889

Chris1@CountsRealEstate.com

www.CountsCommercial.com