

± 9.70 ACRES

GROUND LEASE AVAILABLE

6000 SW 44TH STREET
OKLAHOMA CITY, OK 73179



HOBBY LOBBY

TRANE Supply

NORTEK

REGIONAL FOOD BANK

Centek

SIEMENS

Aaron's

MCKESSON

amazon

SOLD

DOWNTOWN OKC

NEWCASTLE RD

AIRPORT RD

SW 44TH ST

S MACARTHUR BLVD

AVAILABLE NOW GROUND LEASE

6000 SW 44TH STREET
OKLAHOMA CITY, OK 73179

An excellent opportunity for a ground lease due to the increasing daytime population in the surrounding area.

PROPERTY FEATURES

SITE AREA: ± 9.70 Acres

LEASE RATE: \$2,750 / month

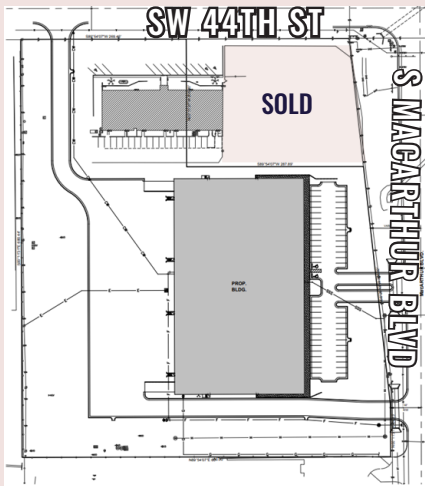

Demographics	1 Mile	3 Miles	5 Miles
2020 Population	109	23,941	111,767
2024 Population	83	24,089	115,090
2029 Est Population	84	24,176	118,264
2024 Daytime Population	5,344	46,032	105,922

