

OFFICE/MEDICAL SPACE FOR LEASE

# 22 OLD CANAL DRIVE

Lowell, Massachusetts



OFFICE/MEDICAL **OPPORTUNITY**

## 6,896 SF Available



303 Congress Street, Boston, MA 02210 617.457.3400 [www.hunneanre.com](http://www.hunneanre.com)

# 22 OLD CANAL DRIVE

Lowell, Massachusetts



## PROPERTY SPECIFICATIONS

**BUILDING SIZE:** 31,604 SF

**AVAILABLE SPACE:** 6,896 SF

**STORIES:** 1

**PROPERTY TYPE:** Office/Medical

**PARKING:** 2.0/1,000 SF

**CEILING HEIGHT:** 14'

**YEAR BUILT:** 1986

**CONDITION:** Excellent, Move-in Ready

# FLOOR PLAN | 6,896 SF

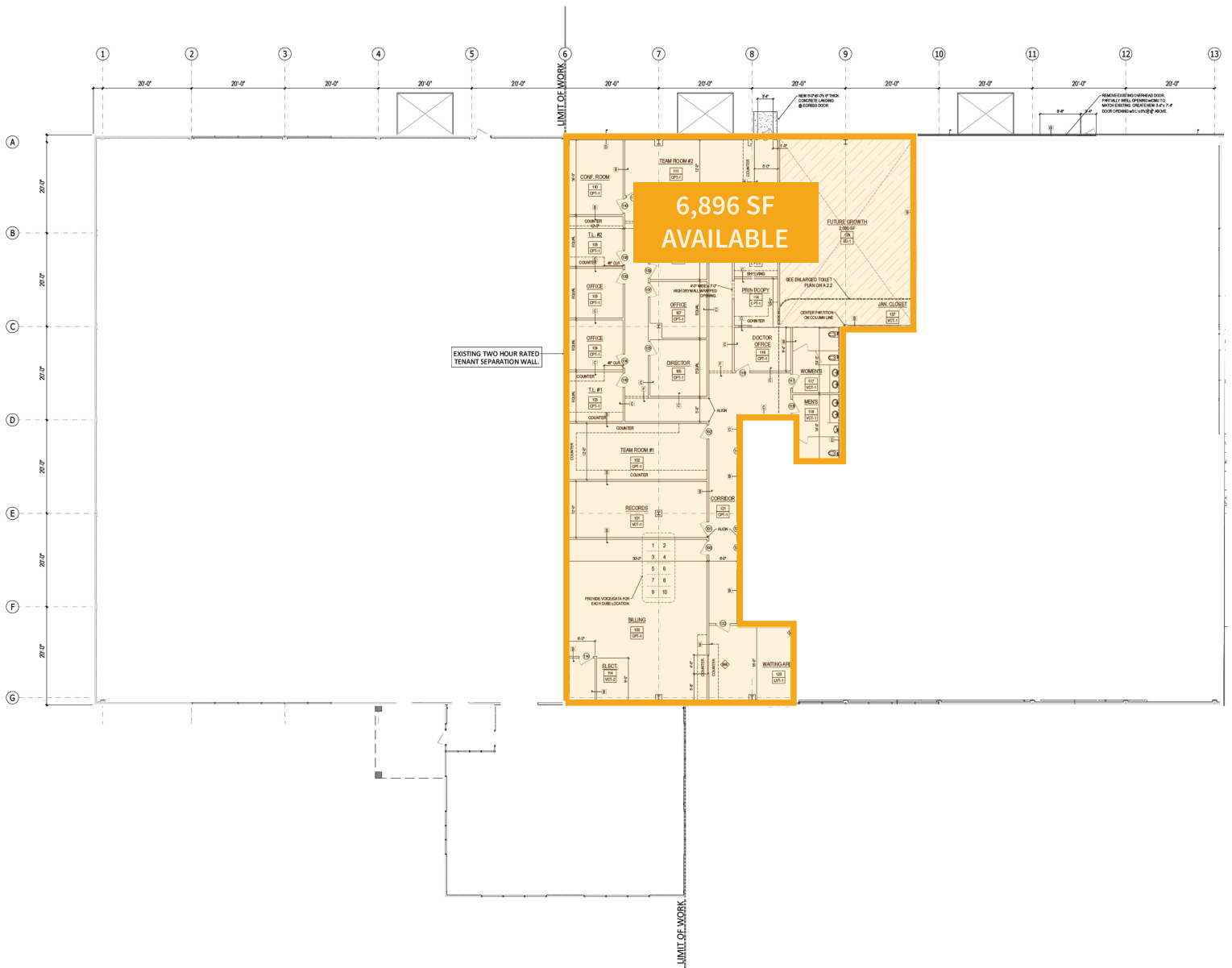

6,896 SF AVAILABLE

# 22 OLD CANAL DRIVE

Lowell, Massachusetts



## CONTACT US TO ARRANGE A TOUR

### PATRICK GRADY

Vice President

781.820.9881

pgrady@hunnemanre.com

### TYLER EWING

Executive Vice President

617.448.1894

tewing@hunnemanre.com



1.4 Miles  
to I-495



1.7 Miles  
to Route 3



303 Congress Street, Boston, MA 02210 617.457.3400 [www.hunnemanre.com](http://www.hunnemanre.com)

©2024 Hunneman. All rights reserved. All information has been obtained from sources believed reliable but no warranty or representation is verified for accuracy or completeness. Caution and independent investigation of property and information should be verified. Reliance on this information is at your own risk.