

FOR LEASE

RETAIL SPACE AVAILABLE
6300 Delmar Blvd. | University City, MO 63130



PROPERTY HIGHLIGHTS

- 5,000± SF retail space available
- Located in the vibrant Delmar Loop business district adjacent to Washington University in University City, MO
- 6,400± SF total building size
- 16 Surface parking spaces in the rear of the building
- Additional street parking available along Delmar Blvd.
- Popular retail and commercial area
- **LEASE RATE: \$30.00 PSF**

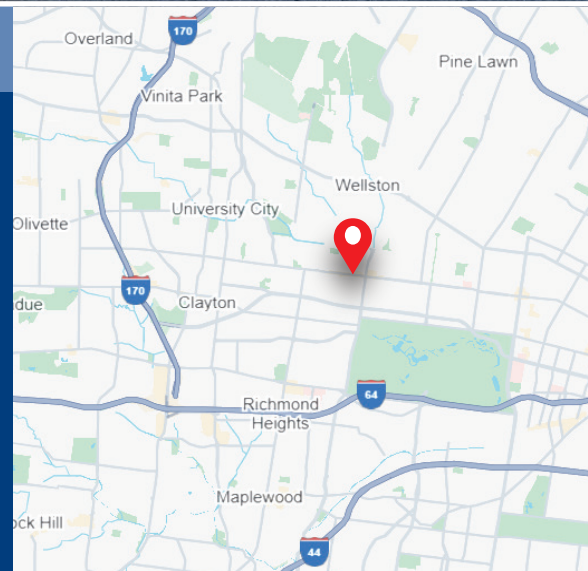

CONTACT US:

Dean Burns

Senior Vice President

Mobile: 314-757-1284

Direct: 636-728-5133

dburns@gundakercommercial.com

Jim Alexander

Vice President

Mobile: 314-954-0540

Direct: 636-728-5100

jalexander@gundakercommercial.com



GUNDAKER
COMMERCIAL GROUP

55 Westport Plaza Drive, Ste. 200

St. Louis, MO 63146

M: 636-728-5100 | F: 636-728-5140

gundakercommercial.com [in](#) [@](#) [f](#)

FLOOR PLAN AND DEMOGRAPHICS

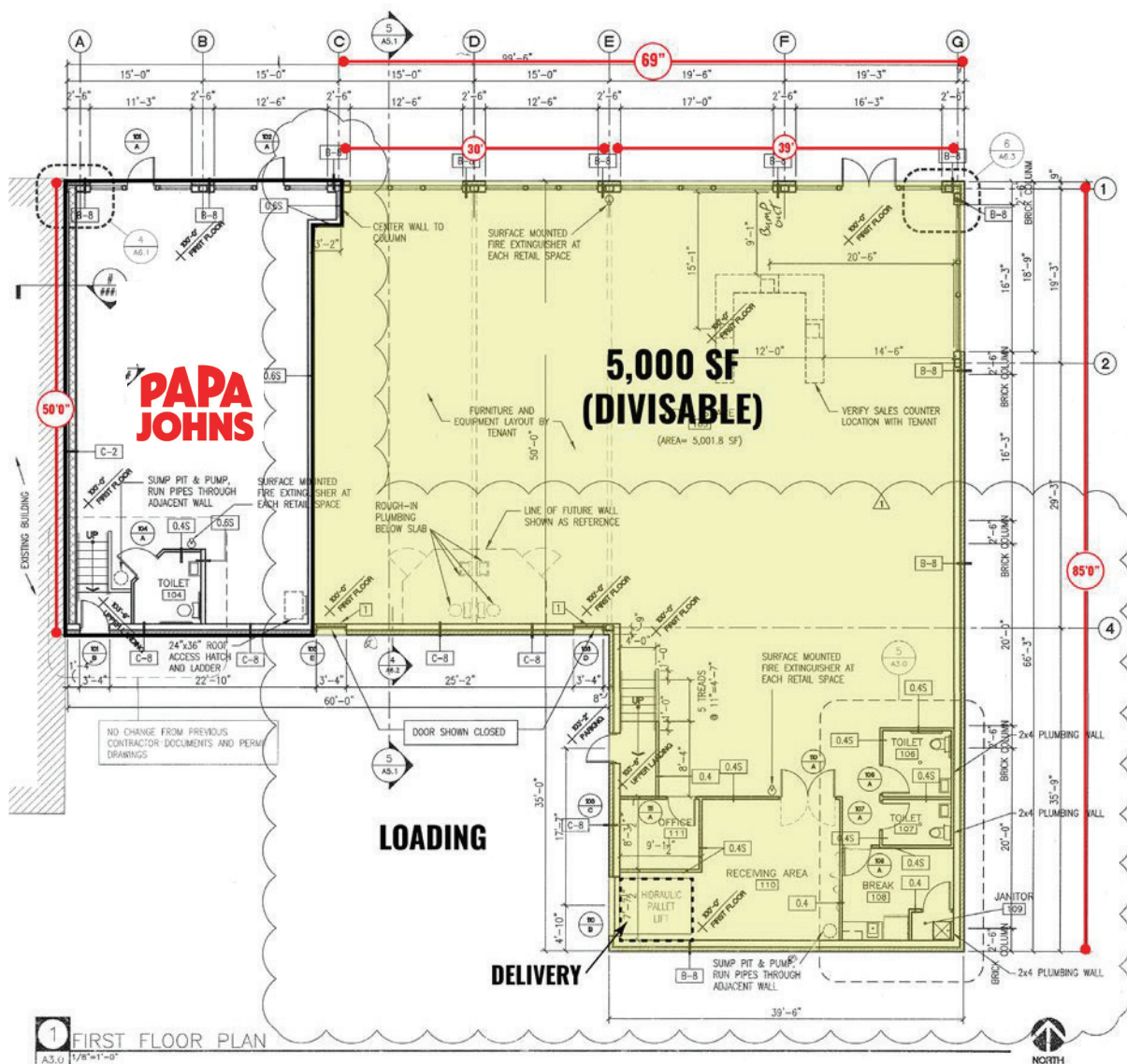

Demographics	1 mile	3 miles	5 miles
Population	22,051	137,391	334,042
Avg HH Income	\$94,386	\$90,357	\$82,510

Traffic Counts	VPD
Delmar Blvd.	11,899

CONTACT US:

Dean Burns

Senior Vice President

Mobile: 314-757-1284

Direct: 636-728-5133

dburns@gundakercommercial.com

Jim Alexander

Vice President

Mobile: 314-954-0540

Direct: 636-728-5100

jalexander@gundakercommercial.com



GUNDAKER
COMMERCIAL GROUP

55 Westport Plaza Drive, Ste. 200

St. Louis, MO 63146

M: 636-728-5100 | F: 636-728-5140

gundakercommercial.com [in](#) [@](#) [f](#)