

West Monroe Street
Commercial Buildings
Alleyway
Secured Loading Area

South Clinton Street

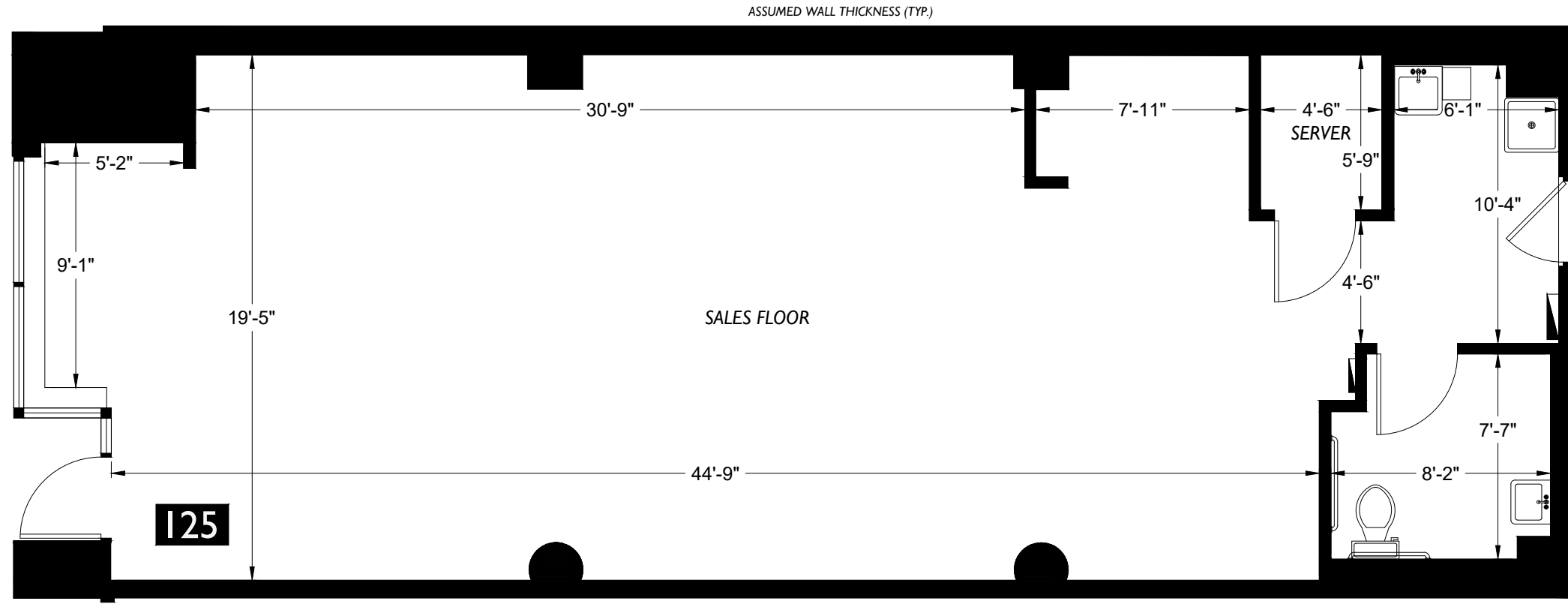

ASSUMED WALL THICKNESS (TYP.)

SALES FLOOR

SERVER

125

Adjacent Retail Suite
West Adams Street

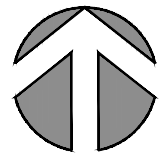

Common Hallway
South Canal Street

<p>Bianco Properties 680 Craig Road Suite 240 Creve Coeur, MO 63141</p> <p>Client</p>	<p>Retail Space 125 South Clinton Street Chicago, IL 60661</p> <p>Subject</p>	<p>Floor Plan 1</p> <p>Floor</p>	<p>Scale 0 5</p>	<p>2DFLOORPLANS.COM 425-677-7511 600 NW Gilman Blvd. Suite E Issaquah, WA 98027</p> <p>2-D AS-BUILT FLOOR PLANS</p> <p>Measured: November 2018 Project: C18-1021</p>
--	--	---	----------------------	---