

# OFFICE/ POTENTIAL MEDICAL OFFICE With EXTRA LOT

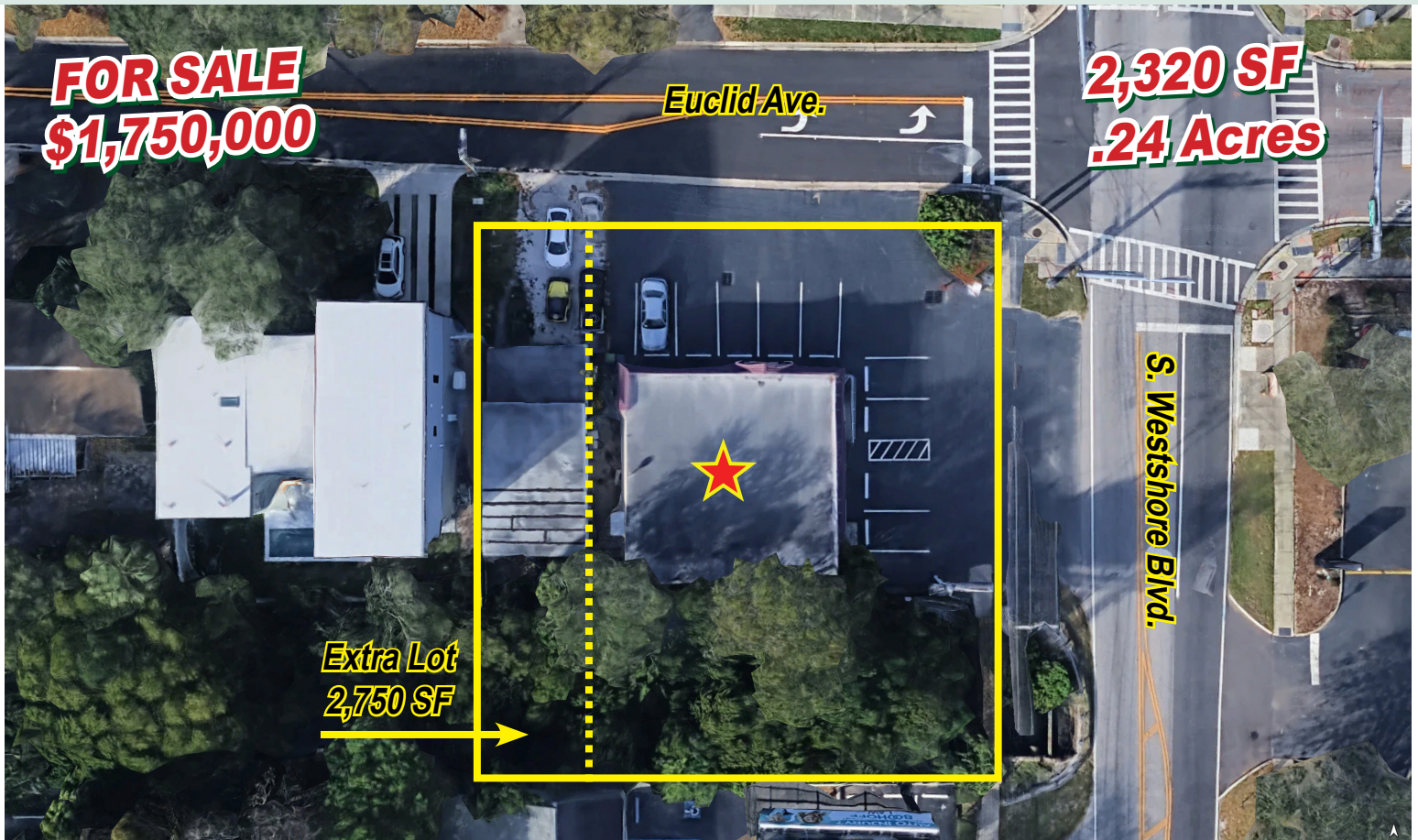

**3801 S. Westshore Blvd., Tampa, FL 33611**



Property is located at a traffic light on Euclid Ave and S. Westshore Blvd.

## Property Highlights

- Concrete block
- Extra lot (2,750 SF)
- 6 private offices
- Open area
- Breakroom
- Conference room
- Computer room

## FOR MORE INFORMATION CONTACT

**Anthony Lefler, Broker**

Off 813.242.6464 Ext 21

Cel 813.493.6464

[anthony@alcommercialinc.com](mailto:anthony@alcommercialinc.com)

[www.alcommercialinc.com](http://www.alcommercialinc.com)



Licensed Real Estate Broker

# OFFICE/ POTENTIAL MEDICAL OFFICE With EXTRA LOT

## Map

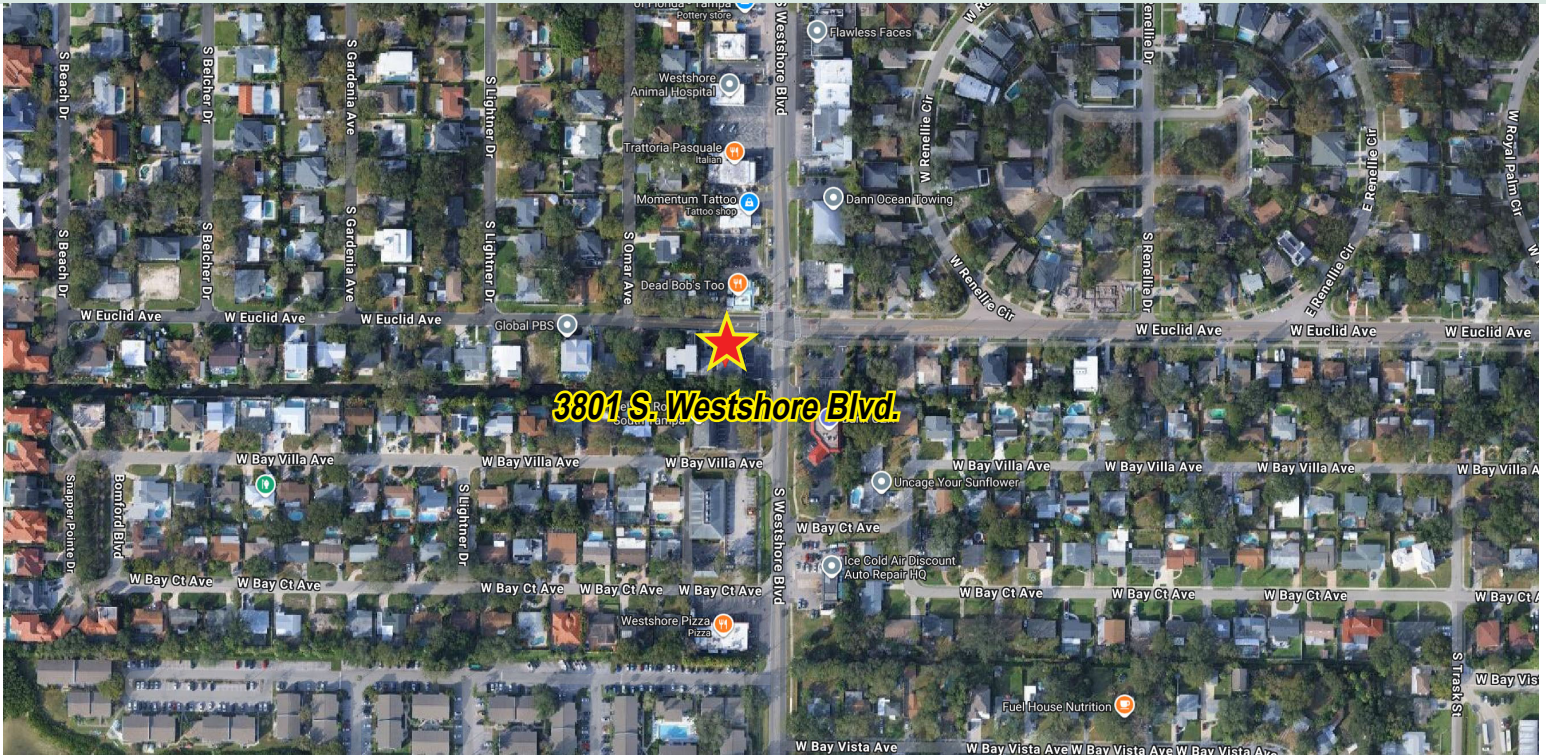

## Fenced Lot



## Population Map

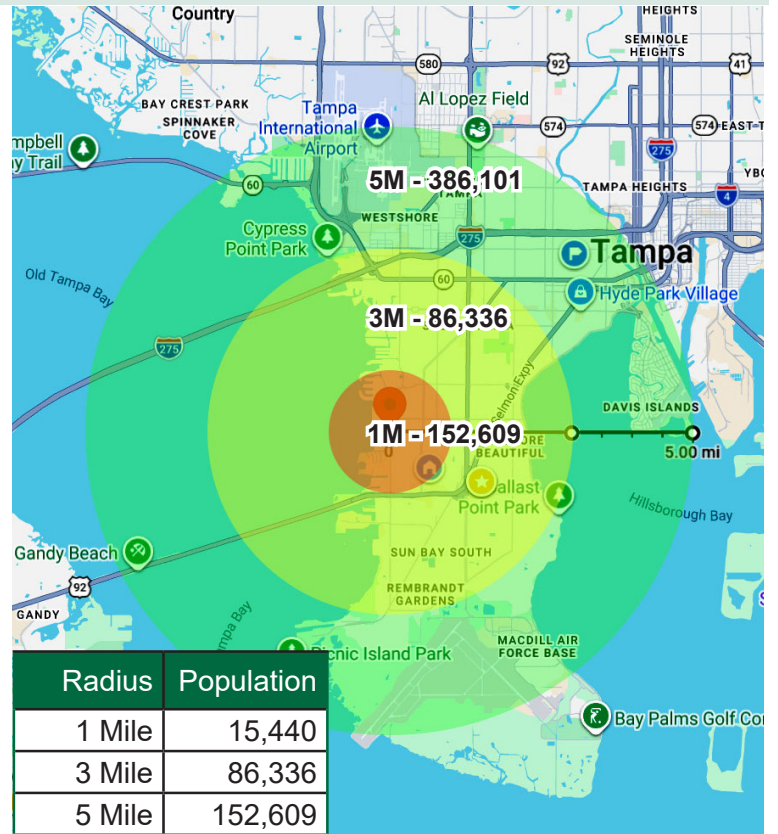

## FOR MORE INFORMATION CONTACT

**Anthony Lefler, Broker**

Off 813.242.6464 Ext 21

Cel 813.493.6464

[anthony@alcommercialinc.com](mailto:anthony@alcommercialinc.com)

[www.alcommercialinc.com](http://www.alcommercialinc.com)



Licensed Real Estate Broker