

# 1810 FIFTH AVENUE

RIVER GROVE IL

## 85,475 SF AVAILABLE FOR SUBLEASE



FOR MORE INFORMATION, PLEASE CONTACT:

Brett Kroner  
Vice Chair  
+1 847 720 1367  
[brett.kroner@cushwake.com](mailto:brett.kroner@cushwake.com)

Marc Samuels  
Director  
+1 847 720 1368  
[marc.samuels@cushwake.com](mailto:marc.samuels@cushwake.com)

Gabe Strauss  
Associate  
+1 847 518 3226  
[gabriel.strauss@cushwake.com](mailto:gabriel.strauss@cushwake.com)



# PROPERTY HIGHLIGHTS

Conveniently located 15 minutes from **O'Hare International Airport** between **I-90, I-290 & I-294**, this distribution/manufacturing space is available for Sublease.



**SITE SIZE**  
4.34 ACRES



**SPACE AVAILABLE**  
85,475 SF



**OFFICE AREA**  
5,120 SF



**POWER**  
1800A / 480V



**INTERIOR DOCKS**  
3



**CLEAR HEIGHT**  
20'



**SPRINKLER**  
WET



**YEAR BUILT**  
1975



**SUBLEASE RATE**  
\$8.50/SF Gross

FOR MORE INFORMATION, PLEASE CONTACT:

Brett Kroner  
Vice Chair  
+1 847 720 1367  
brett.kroner@cushwake.com

Marc Samuels  
Director  
+1 847 720 1368  
marc.samuels@cushwake.com

Gabe Strauss  
Associate  
+1 847 518 3226  
gabriel.strauss@cushwake.com



# SITE PLAN

85,475 SF  
AVAILABLE

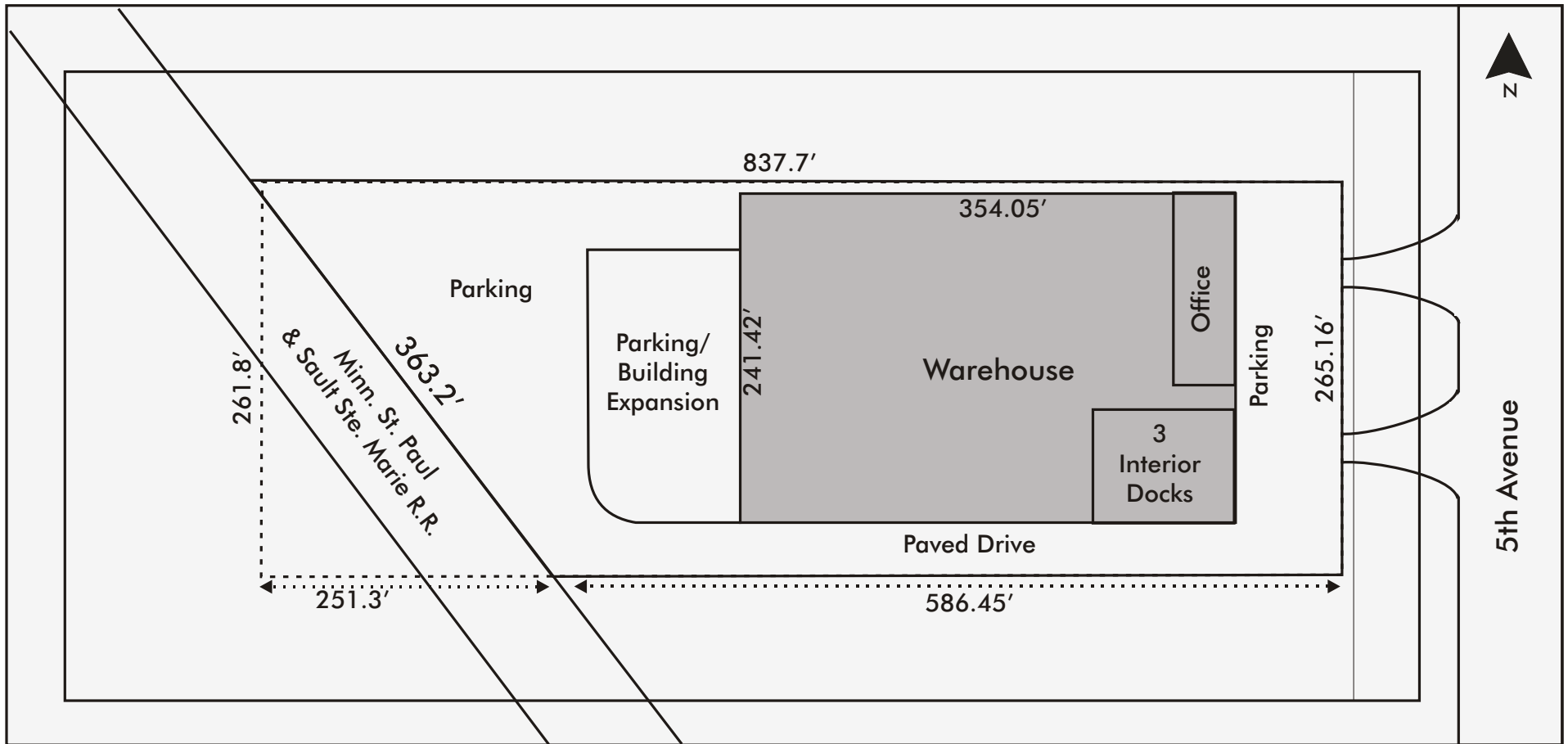

FOR MORE INFORMATION, PLEASE CONTACT:

Brett Kroner  
Vice Chair  
+1 847 720 1367  
brett.kroner@cushwake.com

Marc Samuels  
Director  
+1 847 720 1368  
marc.samuels@cushwake.com

Gabe Strauss  
Associate  
+1 847 518 3226  
gabriel.strauss@cushwake.com



# AERIAL MAP



FOR MORE INFORMATION, PLEASE CONTACT:

Brett Kroner  
Vice Chair  
+1 847 720 1367  
brett.kroner@cushwake.com

Marc Samuels  
Director  
+1 847 720 1368  
marc.samuels@cushwake.com

Gabe Strauss  
Associate  
+1 847 518 3226  
gabriel.strauss@cushwake.com

