

FOR LEASE
857 Merchant St.
VACAVILLE, CA

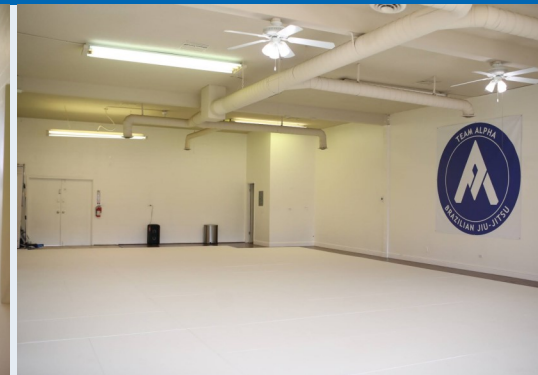

**PRIME RETAIL EXPOSURE IN THRIVING, ESTABLISHED STRIP CENTER.
LOCATED ON PRIMARY THROUGHFARE OF HISTORIC DOWNTOWN VACAVILLE.**



- PREMISES SF:** APPROX. 1,800 SF
GLA SF: 11,850 SF
YEAR BUILT: 1958
BUILD-OUT: OPEN PLAN - SHOWROOM
AMENITIES:
- AMPLE ON-SITE PARKING
 - EXCELLENT STREET VISIBILITY
 - IDEAL FOR RETAIL, HOME DÉCOR, FITNESS
 - ACCESS TO PUBLIC TRANSPORTATION
 - 1/4 MILE TO INTERSTATE- 80

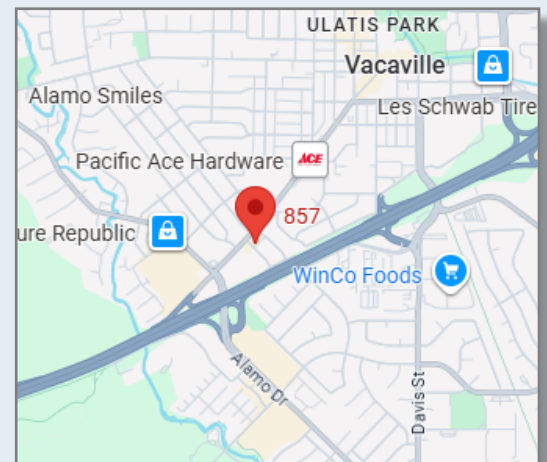

The information provided herein has been obtained from sources deemed reliable. Summit Properties does not guaranty its accuracy.

CONTACT:

Mary Ann Rollison
marollison@sbcglobal.net
707-479-0465
DRE #01055428

MORIEL BUILDING

857 Merchant St.
Vacaville, CA 95688

THE MORIEL BUILDING is located in northern Solano County, midway between San Francisco and Sacramento. Over 104,000 residents enjoy its affordable housing, quality schools, wide array of youth activities. Residents and visitors alike enjoy an expanding choice of restaurants in the revitalized, historic downtown, and some of the best shopping in the area with a thriving retail district along Interstate 80 that includes one of the largest factory outlets complexes in California.

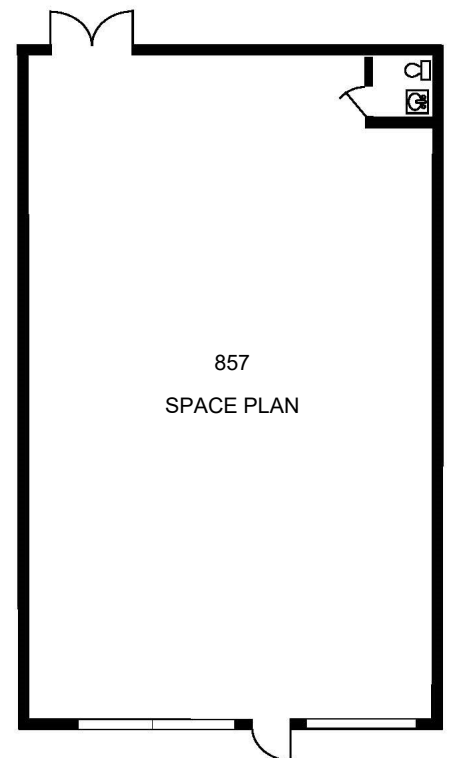
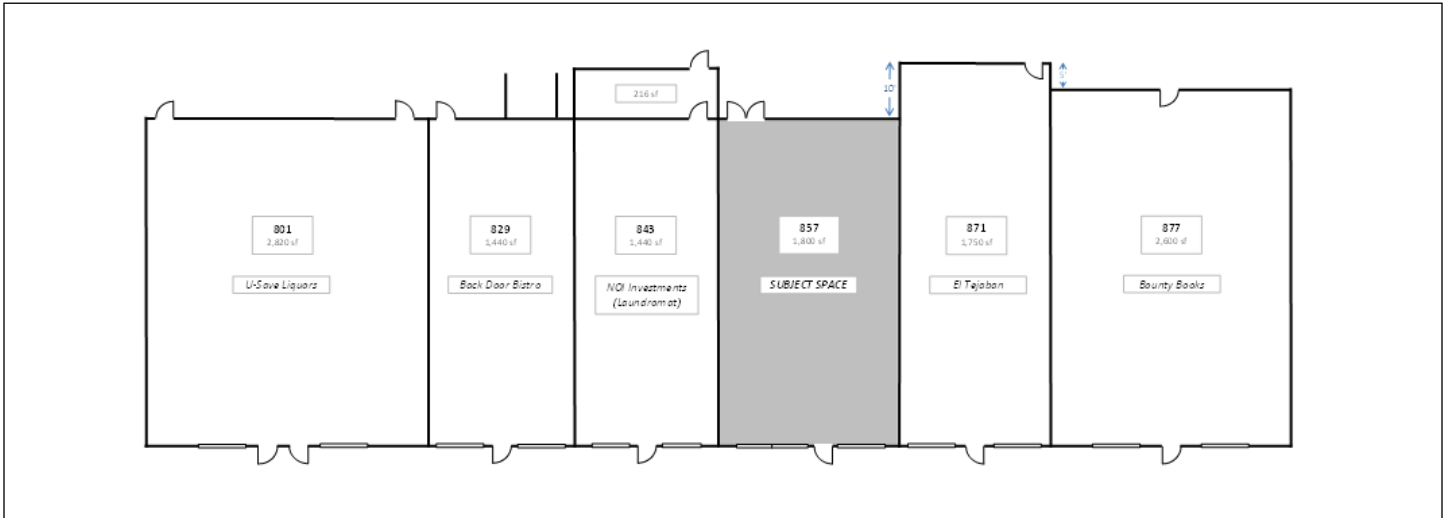

Mary Ann Rollison
maryann@summitprops.com
707-479-0465
BRE #01055428