

PHILADELPHIA STREET

2821 E. PHILADELPHIA STREET - UNIT B • ONTARIO, CA



Voit
REAL ESTATE SERVICES

RYAN MOORE, SIOR
Senior Vice President, Partner
rmoore@voitco.com
909.545.8011
Lic. #01821438

RYAN SHATTUCK
Associate
rshattuck@voitco.com
714.514.5792
Lic. #02228315

±17,331 SF FOR LEASE

PROPERTY HIGHLIGHTS

- ±17,331 SF Industrial Building
- ±2,213 SF Office Space
- 2 Dock High Doors
- 1 Ground Level Doors
- 24'-26' Ceiling Clearance (Verify)
- 400 Amps, 480 Volt, 3 Phase Power (Verify)
- Concrete Truck Court
- .60/3,000 Sprinkler System (Verify)
- Close Proximity to 60 Fwy and Ontario Airport

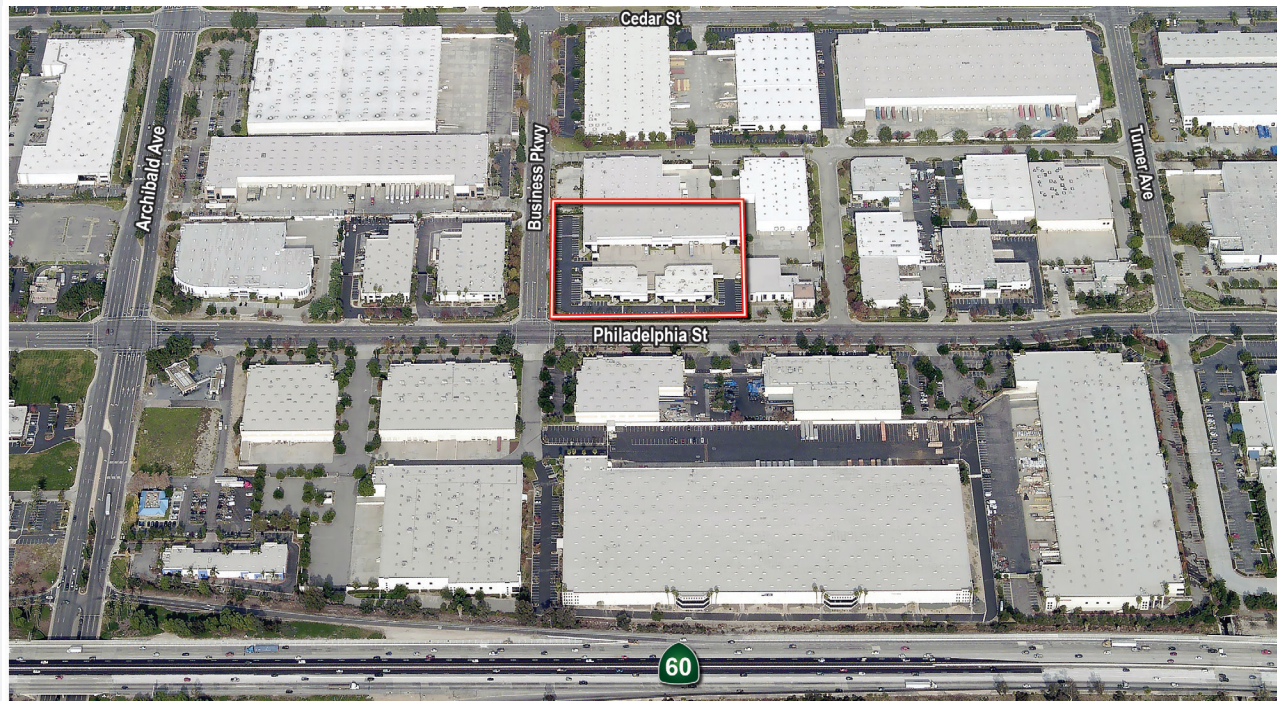

SITE PLAN

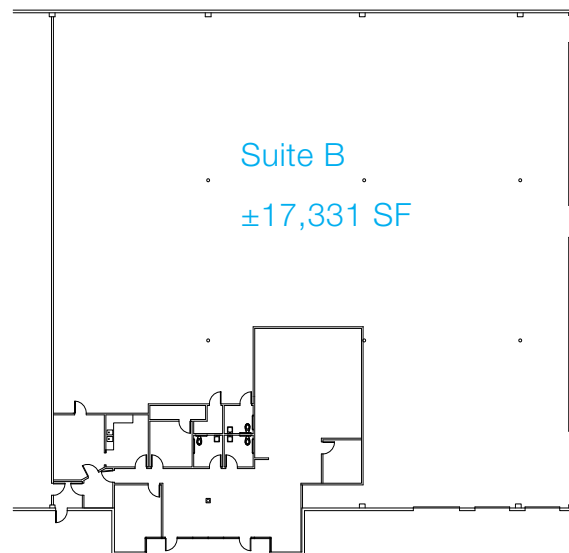
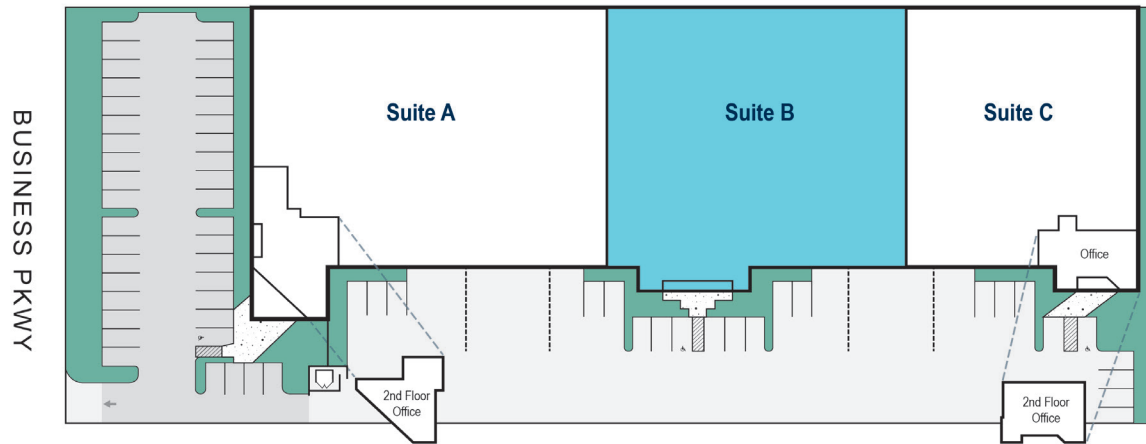

PHILADELPHIA STREET

2821 E. PHILADELPHIA STREET - UNIT B • ONTARIO, CA



RYAN MOORE, SIOR
 Senior Vice President, Partner
rmoore@voitco.com
 909.545.8011
 Lic. #01821438

RYAN SHATTUCK
 Associate
rshattuck@voitco.com
 714.514.5792
 Lic. #02228315

Voit
 REAL ESTATE SERVICES

2400 E. Katella Avenue, Suite 750
 Anaheim, CA 92806
 714.978.7880 | 714.978.9431 Fax
 Lic #01991785 | www.voitco.com

Licensed as Real Estate Salespersons by the DRE. The information contained herein has been obtained from sources we deem reliable. While we have no reason to doubt its accuracy, we do not guarantee it. ©2022 Voit Real Estate Services, Inc. All Rights Reserved. Lic. #01991785