



OFFICE SUITE | FOR LEASE

10001 BROADWAY EXT. , OKLAHOMA CITY, OK 73114

BRAD RICE

brice@newmarkrp.com
C: 405.269.8586

NEWMARK
ROBINSON PARK

10001 BROADWAY EXT / FOR LEASE

PROPERTY OVERVIEW

5,581 SF office/lab space featuring a flexible floorplan suitable for a variety of laboratory uses. The previous tenant, an engineering firm, conducted concrete street and bridge testing, while the current tenant has focused on chemical and materials testing. Approximately half of the space is dedicated to lab use, with convenient access to a loading dock and ample parking, making it ideal for a medical practice, medical spa, or medical testing facility.

DETAILS

Price / SF	\$18 / SF
Suite B Size	5,581 SF
Building Size	18,246 SF
Year Built / Remodeled	1984/2020
Lot Size	1.52
Market	North Oklahoma City

HIGHLIGHTS

- Remodeled in 2020
- Prime visibility from Broadway Extension
- Provides +/- 80 surface parking spaces
- Includes a single dock-high overhead door at the rear of the building
- 9-foot ceilings throughout the interior

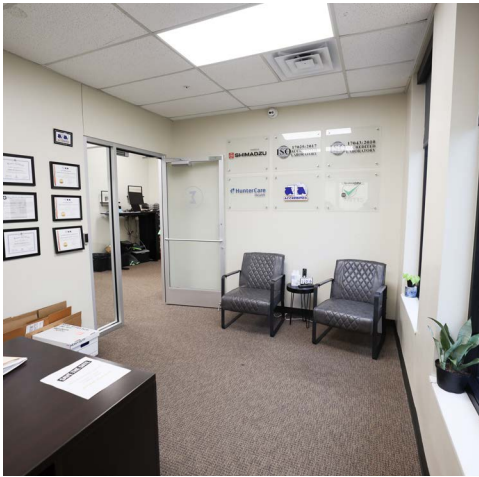
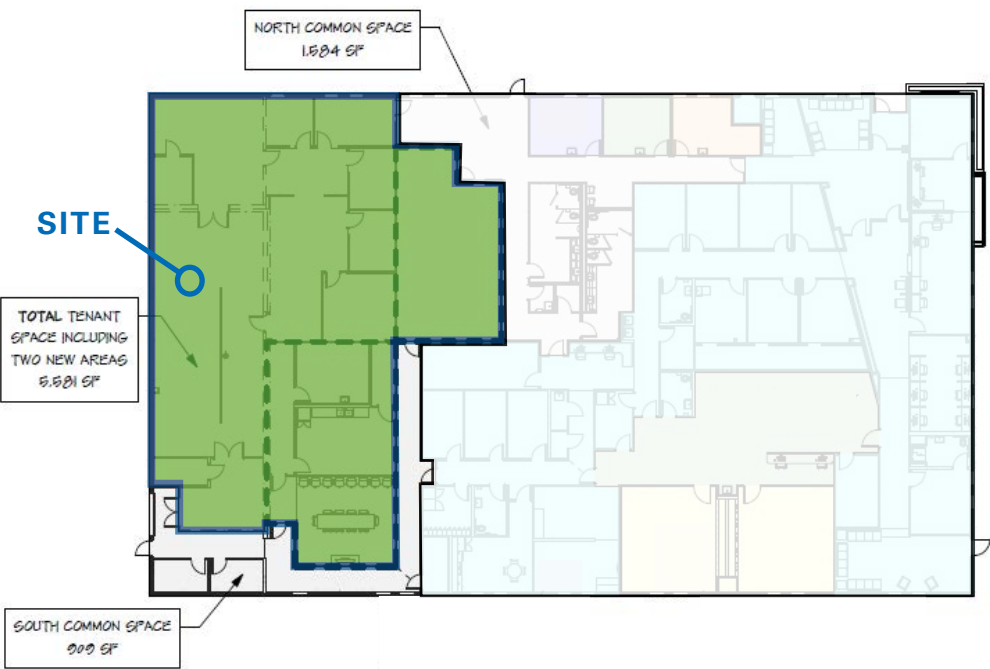

10001 BROADWAY EXT / FOR LEASE

