

**FOR
LEASE**

Turnpike 3

2170 French Settlement Road | Dallas, Texas 75212

141,750 SF AVAILABLE

ACTIVE RAIL ACCESS!



- Total available SF: 141,750 SF
- Office SF: 2,775 SF
- Warehouse break room: 763 SF
- 24' clear height
- 225' building depth
- Power: up to 800 Amps
- Fully sprinklered
- Easy access to major thoroughfares I-30, I-35, and Loop 12
- Rail served - Genesee & Wyoming (DNGO)



HOLT LUNSFORD
COMMERCIAL

ROCKPOINT

John Gorman
972.280.8329
jgorman@holtlunsford.com

Luke Floyd
972.585.5109
lfloyd@holtlunsford.com

**FOR
LEASE**

Turnpike 3

2170 French Settlement Road | Dallas, Texas 75212

**SUITE 2170
141,750 SF**

- Main office: 2,775 SF
- Warehouse break room: 763 SF
- Warehouse SF: 139,975 SF
- Twenty-two (22) dock high doors
- Fourteen (14) dock levelers
- Two (2) oversized ramped doors
- Thirteen (13) rail doors
- 24' clear height
- Power: up to 800 Amps

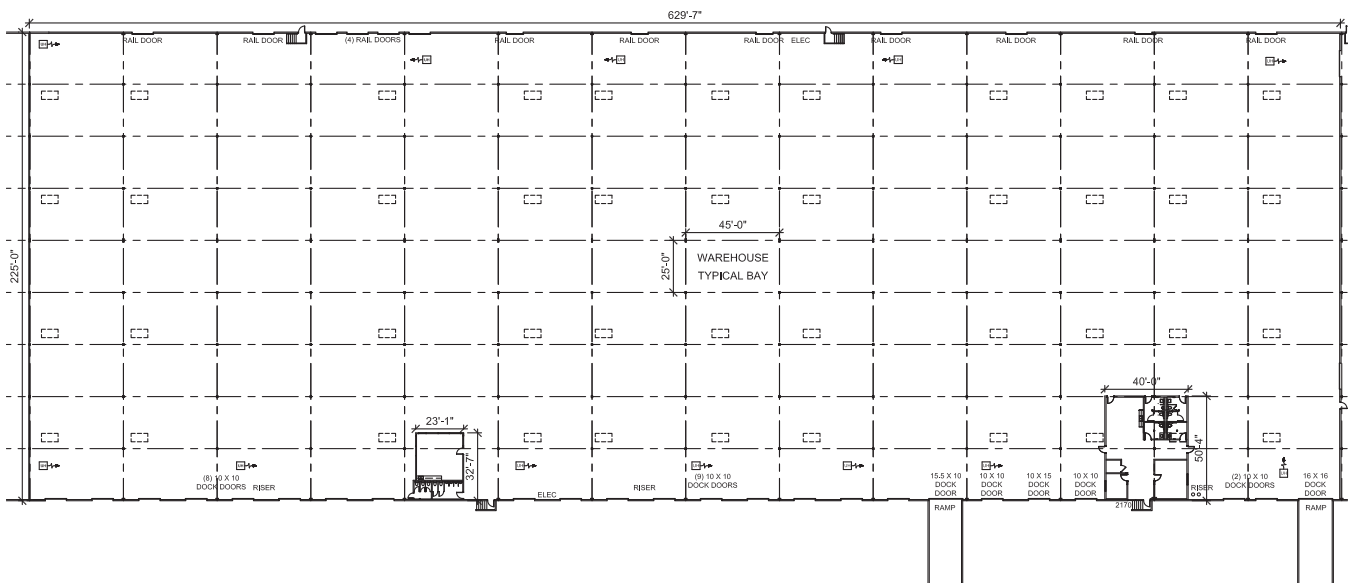
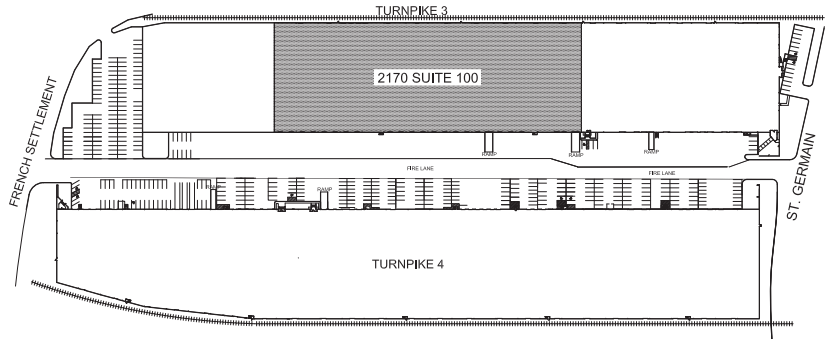

ROCKPOINT

John Gorman
972.280.8329

jgorman@holtlunsford.com

Luke Floyd
972.585.5109

lfloyd@holtlunsford.com

FOR
LEASE

Turnpike 3

2170 French Settlement Road | Dallas, Texas 75212

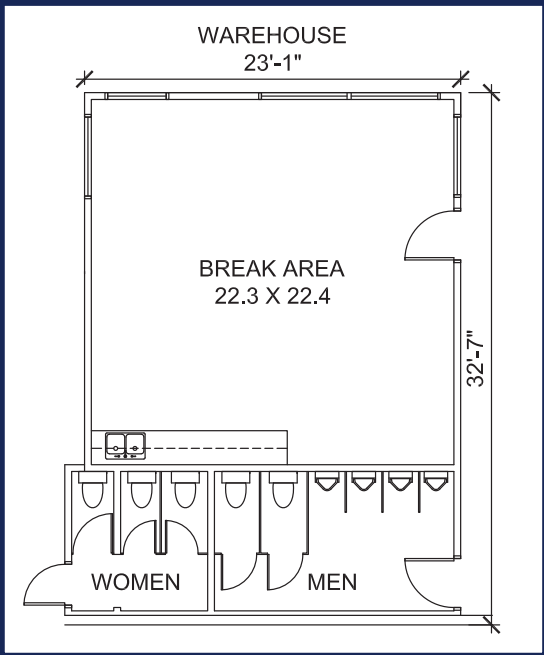

Break room | 763 SF

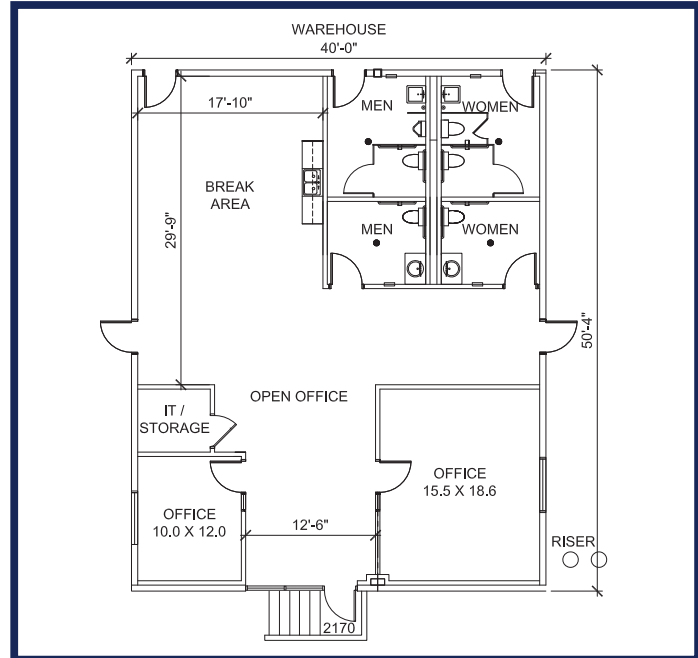

Main office | 2,012 SF



*Proposed Make Ready

 **HOLT LUNSFORD**
COMMERCIAL

ROCKPOINT

John Gorman
972.280.8329
jgorman@holtlunsford.com

Luke Floyd
972.585.5109
lfloyd@holtlunsford.com

This information is deemed reliable, however Holt Lunsford Commercial makes no guarantees, warranties or representation as to the completeness or accuracy thereof.

**FOR
LEASE**

Turnpike **3**

2170 French Settlement Road | Dallas, Texas 75212

PROPOSED OFFICE MAKE READY



 **HOLT LUNSFORD**
COMMERCIAL

ROCKPOINT

John Gorman
972.280.8329

jgorman@holtlunsford.com

Luke Floyd
972.585.5109

lfloyd@holtlunsford.com

This information is deemed reliable, however Holt Lunsford Commercial makes no guarantees, warranties or representation as to the completeness or accuracy thereof.

