

Industrial | For Sublease

CBRE

Warehouse Space

±39,500 SF Available

125 Industrial Park Road
Hingham, Massachusetts

Sublease Term Through May 2028



Industrial Space

125 Industrial Park Road | Hingham, Massachusetts

For Sublease

Building Specifications

- + **Total Building Size:** ±69,600 SF
- + **Available:** ±39,500 SF
- + **Sublease Term:** Through May 31, 2028
- + **Year Built:** 1981
- + **Clear Height:** 18'
- + **Loading Docks:** One (1) loading dock
- + **Fire Protection:** Wet
- + **Parking:** 32 spaces
- + **Column Spacing:** 32' x 32'
- + **Power:** 3,000 Amps, 120/208V and limited 480V
(To be confirmed to suite)
- + **Utilities:**
 - **Gas:** National Grid (Boston Gas)
 - **Electric:** National Grid (Mass Electric)

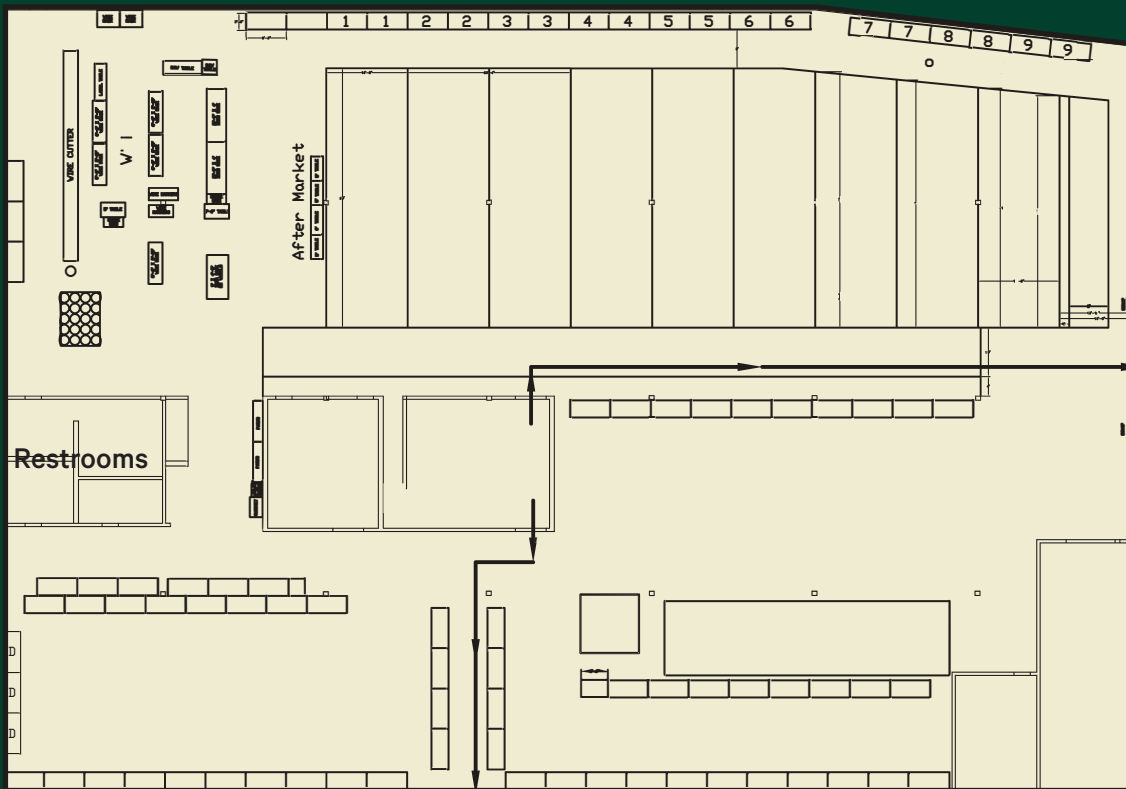

Fully Air-Conditioned



1.0 mile



15 Miles from Boston

Contact Us

Chris Mullen

Senior Vice President
+1 781 801 4432
chris.mullen2@cbre.com

Caroline Munn

Senior Associate
+1 516 851 6261
caroline.munn@cbre.com

↑
Loading Dock

© 2025 CBRE, Inc. All rights reserved. This information has been obtained from sources believed reliable but has not been verified for accuracy or completeness. CBRE, Inc. makes no guarantee, representation or warranty and accepts no responsibility or liability as to the accuracy, completeness, or reliability of the information contained herein. You should conduct a careful, independent investigation of the property and verify all information. Any reliance on this information is solely at your own risk. CBRE and the CBRE logo are service marks of CBRE, Inc. All other marks displayed on this document are the property of their respective owners, and the use of such marks does not imply any affiliation with or endorsement of CBRE. Photos herein are the property of their respective owners. Use of these images without the express written consent of the owner is prohibited.