



Belfort III

7900 & 7950 Belfort Parkway
Jacksonville, Florida 32256

Property Highlights

- 9' ceilings with 18' clear height in warehouse
- Fully air-conditioned office and warehouse space available
- 10'x10' truck doors at dock height

Property Overview

Belfort Park's location in the I-95/East Beltway corridor is the most desired location for a diverse array of businesses and easily accessed from residential areas to the east, south, and southwest areas of the greater Jacksonville area. In addition, St. Johns Town Center is located only less than four miles to the east of Belfort Park and is considered one of the premier shopping and dining developments in Florida.

Offering Summary

Lease Rate:	Negotiable
Available SF:	5,195 - 6,032 SF
Lot Size:	4.95 Acres
Year Built:	1989
Zoning:	IBP-2
Parking Ratio:	1.25/1,000 SF
NNN Expenses:	\$3.41/SF

For More Information



Christian Harden, SIOR

O: 904 404 4449
ch@naihallmark.com



Camden Padgett

O: 904 404 4460
cp@naihallmark.com

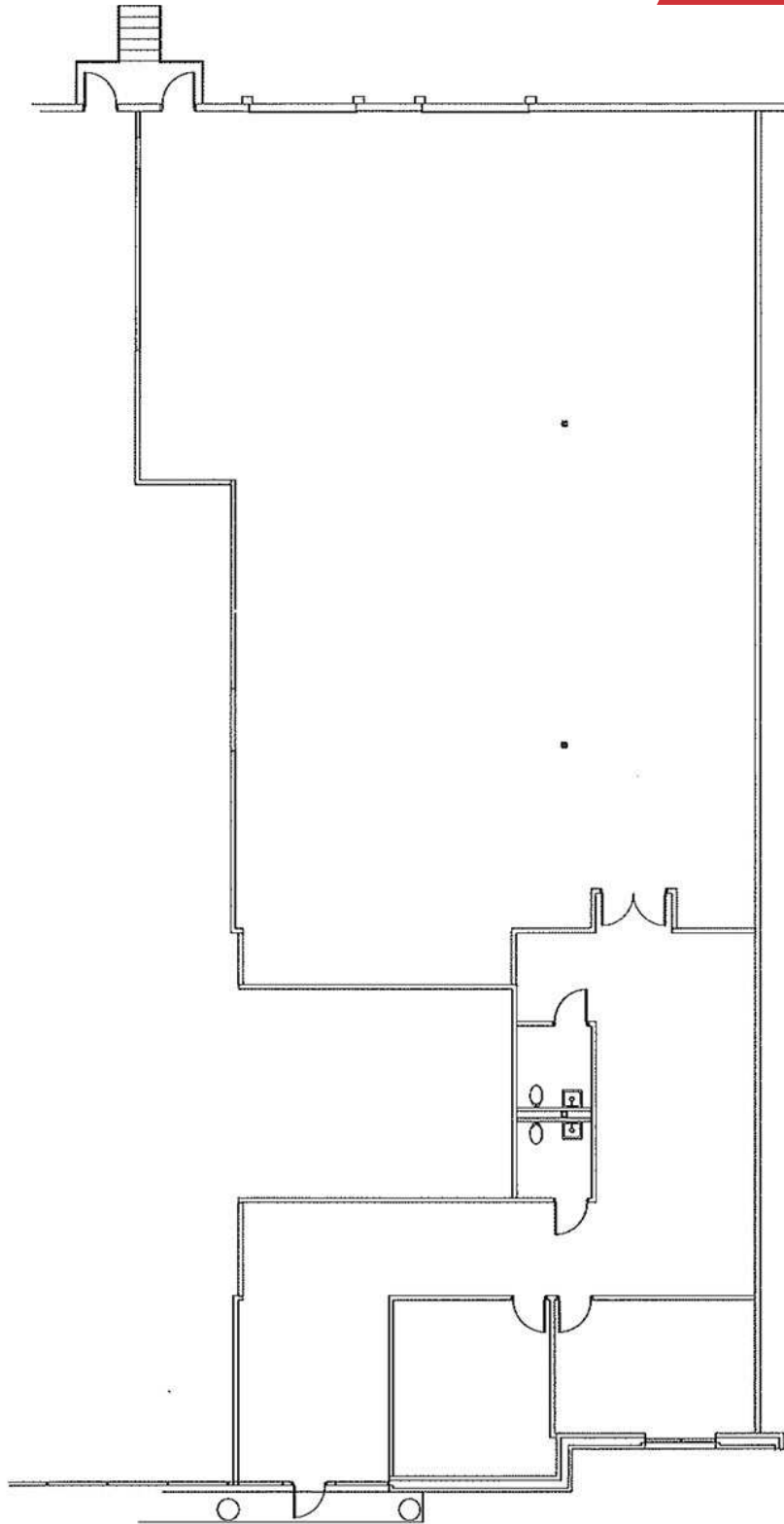

Suite 7900-200 - 6,032 SF - 2 dock high doors

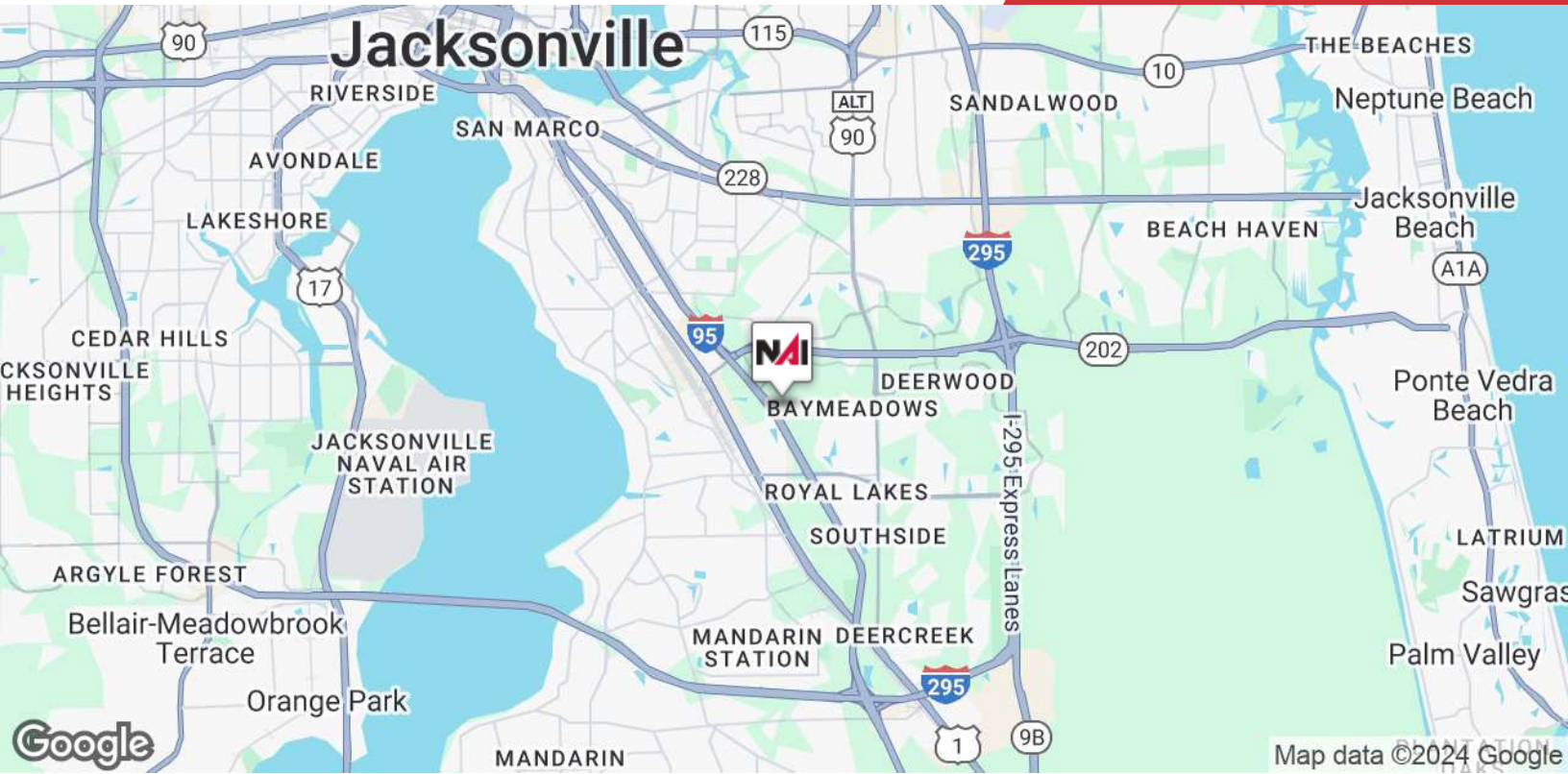

NO WARRANTY OR REPRESENTATION, EXPRESS OR IMPLIED, IS MADE AS TO THE ACCURACY OF THE INFORMATION CONTAINED HEREIN, AND THE SAME IS SUBMITTED SUBJECT TO ERRORS, OMISSIONS, CHANGE OF PRICE, RENTAL OR OTHER CONDITIONS, PRIOR SALE, LEASE OR FINANCING, OR WITHDRAWAL WITHOUT NOTICE, AND OF ANY SPECIAL LISTING CONDITIONS IMPOSED BY OUR PRINCIPALS NO WARRANTIES OR REPRESENTATIONS ARE MADE AS TO THE CONDITION OF THE PROPERTY OR ANY HAZARDS CONTAINED THEREIN ARE ANY TO BE IMPLIED.

200 Riverside Avenue, Suite 5
Jacksonville, FL 32202
904 363 9002 tel
naihallmark.com