

# 48 DOOR CROSS-DOCK ON 4.86± ACRES

FOR SALE OR LEASE AVAILABLE 9/1/25

606 Basin Road, New Castle, DE



## CALL FOR PRICING DETAILS

### PROPERTY DETAILS

#### 18,107±SF TERMINAL:

- 15,581± SF dock
- 48 loading positions
- Dock ramp
- 2,526± SF office

#### 4.86± ACRE SITE:

- Asphalt paved, fenced & lit yard
- Concrete dock aprons & dolly strips
- I-Industrial zoning



### LOCATION HIGHLIGHTS

Located in In New Castle DE on US 202, within 3-4 miles of the I-95, I-295, I-495 intersection. Across US 202 from the Wilmington DE Airport.

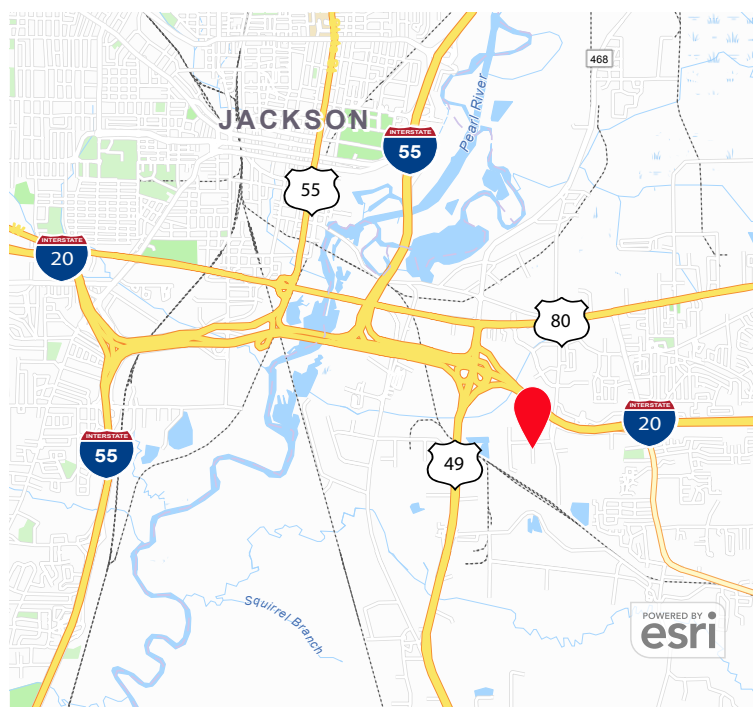

**Burr & Temkin**

Transportation Real Estate Specialists Since 1983



Eric McFarlin  
Principal  
336.817.2969  
[ericm@burrtemkin.com](mailto:ericm@burrtemkin.com)

Parker Dotson  
Broker  
336.682.2560  
[parker@burrtemkin.com](mailto:parker@burrtemkin.com)

Brian Brockman  
Supervising Broker  
License #: RB-0020899  
Bang Realty-Pennsylvania, Inc  
513.898.1551  
[bor@bangrealty.com](mailto:bor@bangrealty.com)

This statement is based upon information we believe to be correct and is obtained from sources we regard as reliable, but we assume no liability for errors or omissions therein.



# 48 DOOR CROSS-DOCK ON 4.86± ACRES

FOR SALE OR LEASE AVAILABLE 9/1/25

606 Basin Road, New Castle, DE

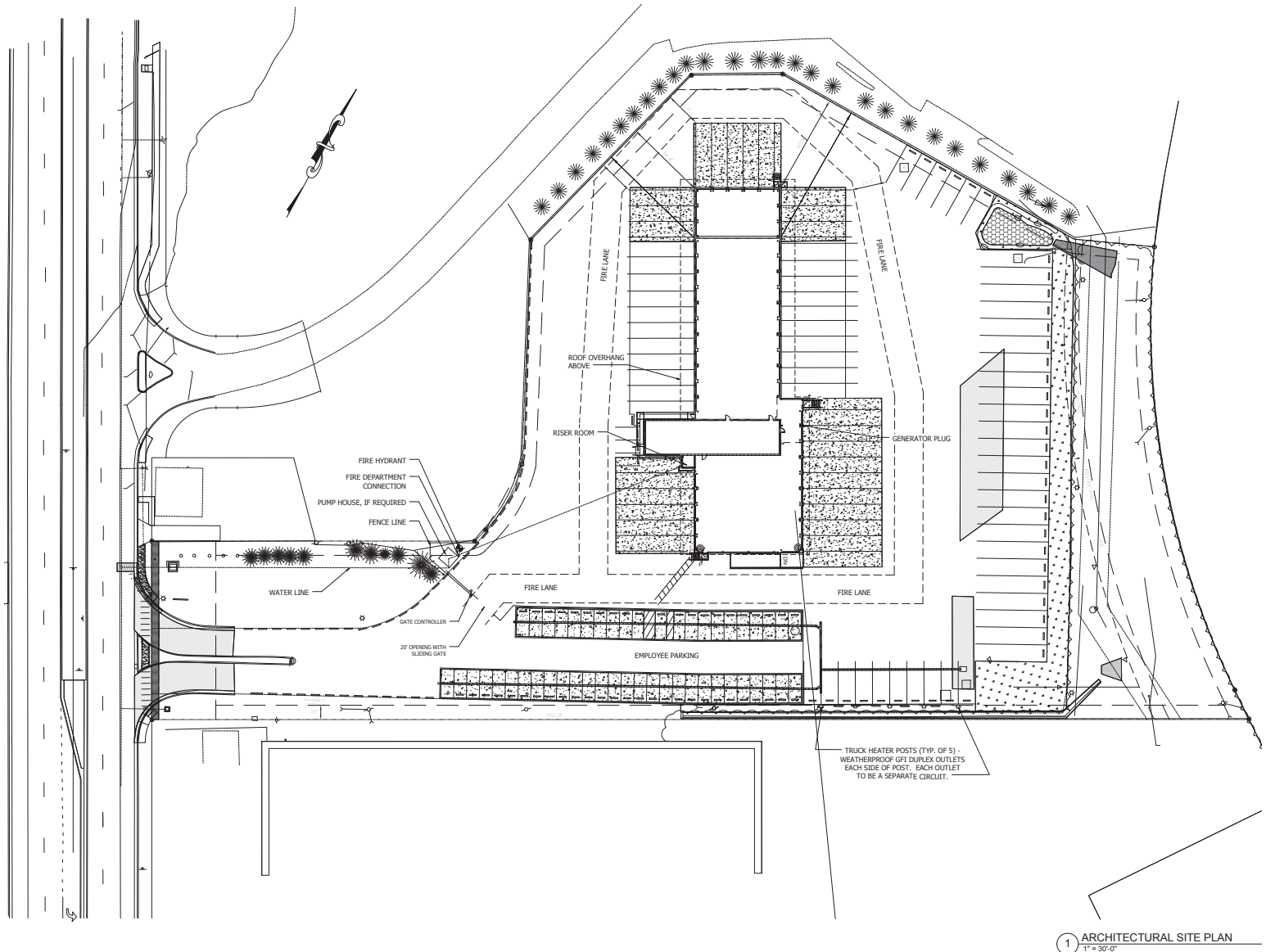

**Burr & Temkin**  
Transportation Real Estate Specialists Since 1983



Eric McFarlin  
Principal  
336.817.2969  
[ericm@burrtemkin.com](mailto:ericm@burrtemkin.com)

Parker Dotson  
Broker  
336.682.2560  
[parker@burrtemkin.com](mailto:parker@burrtemkin.com)

Brian Brockman  
Supervising Broker  
License #: RB-0020899  
Bang Realty-Pennsylvania, Inc  
513.898.1551  
[bor@bangrealty.com](mailto:bor@bangrealty.com)

This statement is based upon information we believe to be correct and is obtained from sources we regard as reliable, but we assume no liability for errors or omissions therein.

# Burr & Temkin

Transportation Real Estate Specialists Since 1983

935 E. Mountain Street  
Suite O  
Kernersville, NC 27284



Eric McFarlin  
Principal  
336.996.2550  
[ericm@burrtemkin.com](mailto:ericm@burrtemkin.com)



Parker Dotson  
Broker  
336.682.2560  
[parker@burrtemkin.com](mailto:parker@burrtemkin.com)



Brian Brockman  
Supervising Broker  
License #: RB-0020899  
Bang Realty-Pennsylvania, Inc  
513.898.1551  
[bor@bangrealty.com](mailto:bor@bangrealty.com)