

# Pinewood Country Club

1189 Ogden Parma Town Line Road  
Spencerport, NY (Town of Ogden) 14559



## AVAILABLE OPPORTUNITY

- » **FOR SALE: \$1,775,000**
- » Includes the property & existing business with all amenities
- » Completely renovated top to bottom, clubhouse, restaurant, kitchen & brand-new ice cream shop
- » Existing 57.60-acre country club/golf course, Pinewood Country Club
- » Includes 9-hole golf course, practice areas, clubhouse facilities, and all existing business operations

## PROPERTY HIGHLIGHTS

- » Excellent investment opportunity of well-established, fully operational country club and golf course
- » Turnkey amenities including full-service restaurant & bar, commercial kitchen, bluestone patio, outdoor dining with fireplace, gift shop, and a fully functioning ice cream shop
- » Multiple revenue streams: golf memberships, daily greens fees, food & beverage, events, tournaments, retail, and seasonal specialty sales
- » Surrounded by residential neighborhoods, providing built-in demand for golf, dining, and private events; serves a large customer base from Ogden, Parma, Spencerport, Greece, and Brockport, all within a short drive
- » Ample on-site parking for golfers, restaurant guests and event attendees



## FOR MORE INFORMATION, PLEASE CONTACT:



**JEFFREY DICESARE**  
Licensed Real Estate Salesperson  
585.503.4929(c)  
[Jeffrey@VentureBrokerageGroup.com](mailto:Jeffrey@VentureBrokerageGroup.com)



EXISTING COUNTRY CLUB & GOLF COURSE FOR SALE

# Pinewood Country Club

1189 Ogden Parma Town Line Road  
Spencerport, NY (Town of Ogden) 14559



## EXTERIOR PHOTOS

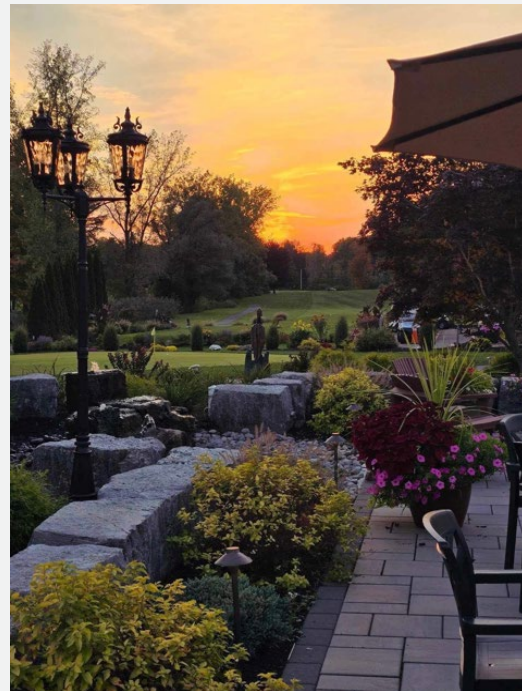

FOR MORE INFORMATION, PLEASE CONTACT:



**JEFFREY DICESARE**  
Licensed Real Estate Salesperson  
585.503.4929(c)  
[Jeffrey@VentureBrokerageGroup.com](mailto:Jeffrey@VentureBrokerageGroup.com)

© 2025 Venture Brokerage Group | 157 Rue de Ville | Rochester, NY 14618

[VENTUREBROKERAGEGROUP.COM](http://VENTUREBROKERAGEGROUP.COM)

This information supplied herein is from sources we deem reliable. It is provided without any representation, warranty or guarantee, expressed or implied as to its accuracy. You should conduct an independent investigation and verification of all matters deemed to be material, including, but not limited to, statements of income and expenses. Consult your attorney, accountant or other professional advisor.



EXISTING COUNTRY CLUB & GOLF COURSE FOR SALE

# Pinewood Country Club

1189 Ogden Parma Town Line Road  
Spencerport, NY (Town of Ogden) 14559



## INTERIOR PHOTOS



FOR MORE INFORMATION, PLEASE CONTACT:



**JEFFREY DICESARE**  
Licensed Real Estate Salesperson  
585.503.4929(c)  
[Jeffrey@VentureBrokerageGroup.com](mailto:Jeffrey@VentureBrokerageGroup.com)

© 2025 Venture Brokerage Group | 157 Rue de Ville | Rochester, NY 14618

[VENTUREBROKERAGEGROUP.COM](http://VENTUREBROKERAGEGROUP.COM)

This information supplied herein is from sources we deem reliable. It is provided without any representation, warranty or guarantee, expressed or implied as to its accuracy. You should conduct an independent investigation and verification of all matters deemed to be material, including, but not limited to, statements of income and expenses. Consult your attorney, accountant or other professional advisor.



EXISTING COUNTRY CLUB & GOLF COURSE FOR SALE

# Pinewood Country Club

1189 Ogden Parma Town Line Road  
Spencerport, NY (Town of Ogden) 14559



## MARKET AERIAL

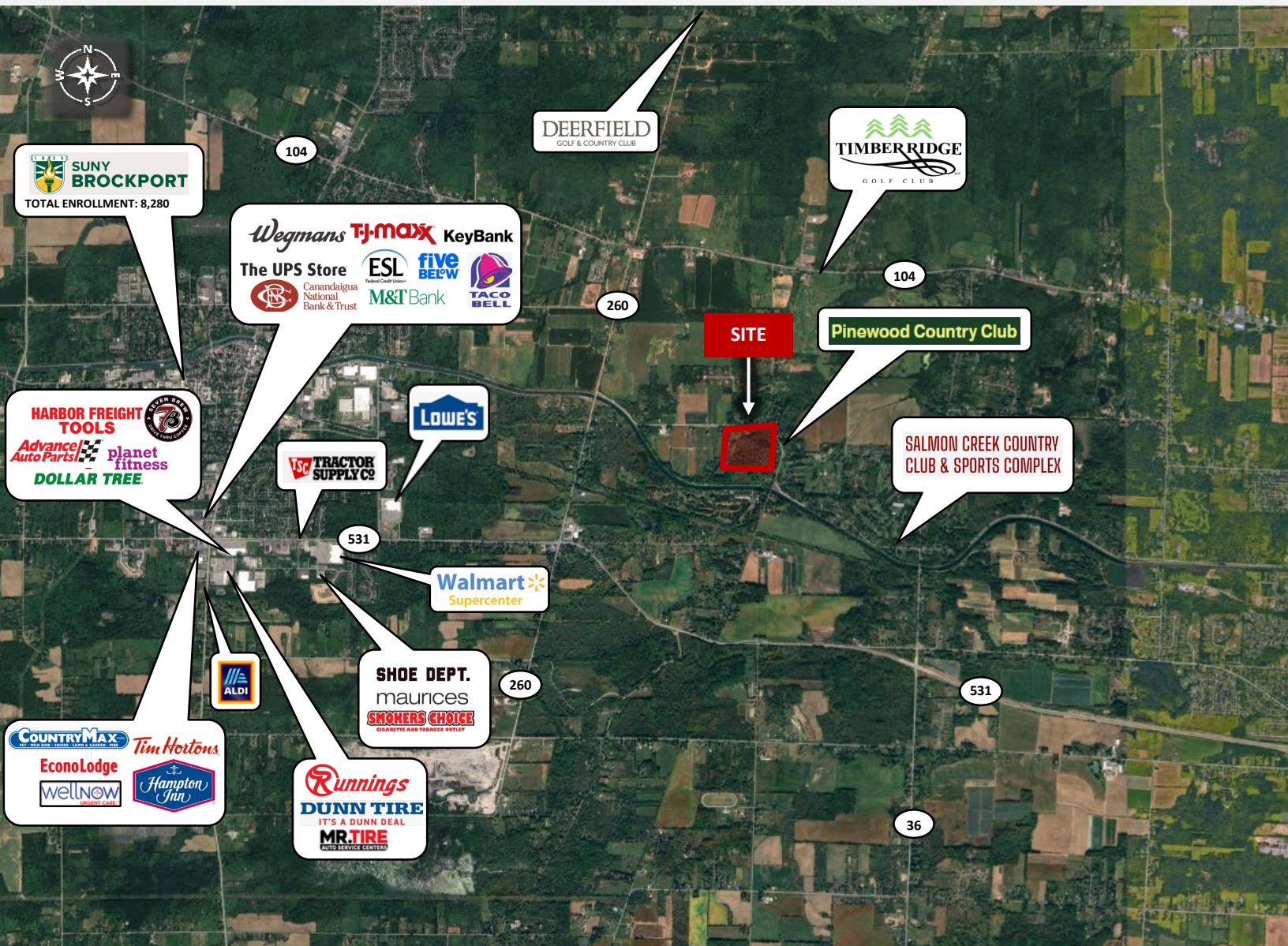

FOR MORE INFORMATION, PLEASE CONTACT:



**JEFFREY DICESARE**  
Licensed Real Estate Salesperson  
585.503.4929(c)  
[Jeffrey@VentureBrokerageGroup.com](mailto:Jeffrey@VentureBrokerageGroup.com)

# Pinewood Country Club

1189 Ogden Parma Town Line Road  
Spencerport, NY (Town of Ogden) 14559

## DEMOGRAPHICS

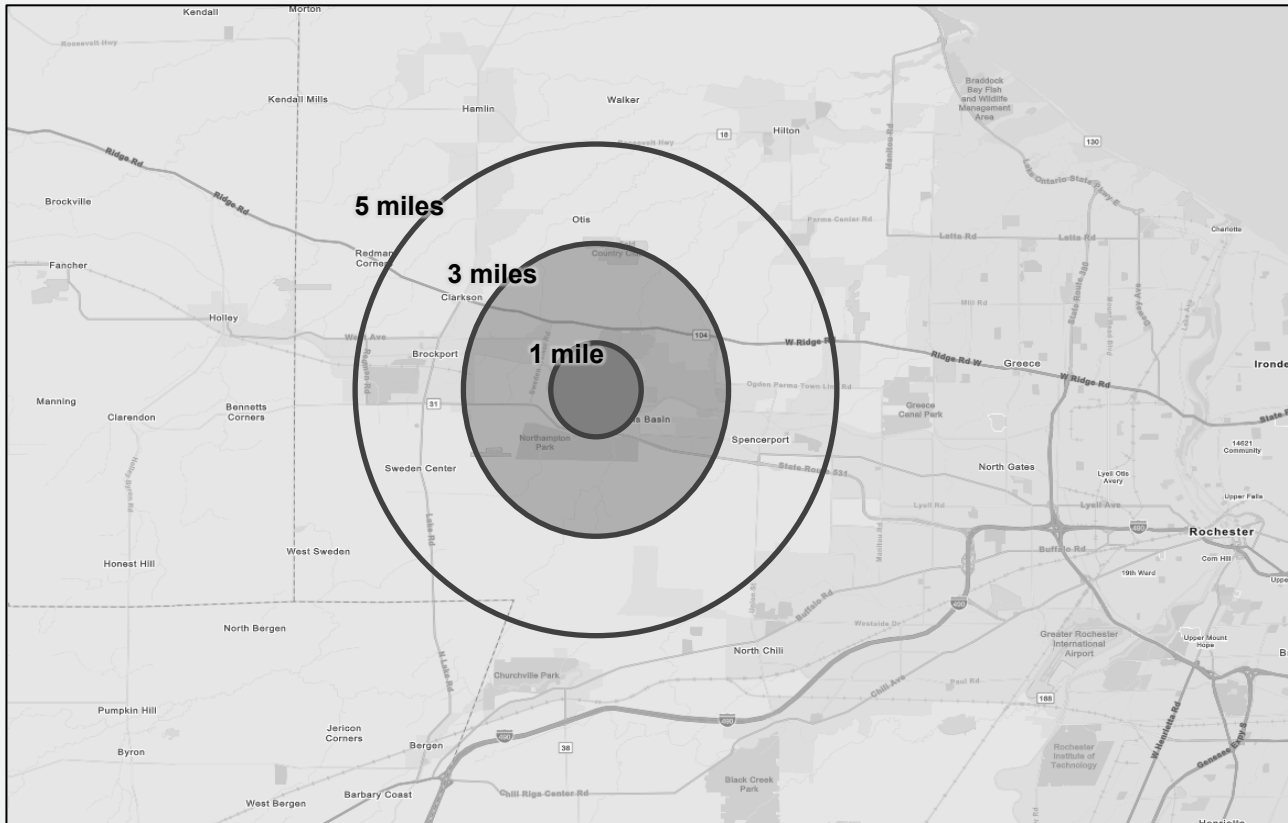

DEMOGRAPHIC SNAPSHOT	1 MILE	3 MILES	5 MILES
Total Population	699	6,298	32,504
Daytime Population	477	4,275	31,442
Households	283	2,509	13,147
Average Household Income	\$155,917	\$128,995	\$103,591



**164**  
Businesses



**1,226**  
Employees



**\$278,706**  
Median Home Value



**44.9**  
Median Age

### FOR MORE INFORMATION, PLEASE CONTACT:



**JEFFREY DICESARE**  
Licensed Real Estate Salesperson  
585.503.4929(c)  
[Jeffrey@VentureBrokerageGroup.com](mailto:Jeffrey@VentureBrokerageGroup.com)