

1480 64TH STREET

EMERYVILLE, CA

TOP-TIER TROPHY LAB SPACE
FOR SUBLEASE

THIRD FLOOR | ±17,000 RSF (DIVISIBLE) AVAILABLE NOW

FLEXIBLE SUBLEASE TERM | SHARED RECEPTION & KITCHEN AREA | PRIVATE LABS & OFFICE AREA | 50/50 LAB-TO-OFFICE RATIO

NEWMARK

**ARI
ROKEACH**

510.725.9163
ari.rokeach@nrmk.com
CA RE Lic #01986061

**RANDY
SCOTT**

650.465.4222
randy.scott@nrmk.com
CA RE Lic #00852506



MAIN LAB

- ▶ 80 modular lab benches
- ▶ Emergency power and data routed to each bench
- ▶ Vacuum, CDA and DI water plumbed to each row of benches
- ▶ Snorkels throughout lab space to provide exhaust
- ▶ 4' chemical fume hood
- ▶ Large open space to allow for equipment or additional benches



FIVE SMALLER SUITES OFF OF MAIN LAB

- ▶ 3 tissue culture suites with CO2, vacuum and emergency power
- ▶ 2 flex suites including a microscopy dark room
- ▶ Large PPE corridor/ante room, w/ smaller suite for CAA/hazardous waste storage



OFFICE SPACE

- ▶ Two 12-person conference rooms, one 6-person conference room, one small phone room
- ▶ 46 cubicles
- ▶ Seven offices / huddle rooms



SHARED SPACE

- ▶ Reception
- ▶ Fully stocked kitchen w/ projector & screen for all-hands meetings
- ▶ Reception
- ▶ Freight elevator
- ▶ Campus amenities include onsite fitness center and parking garage

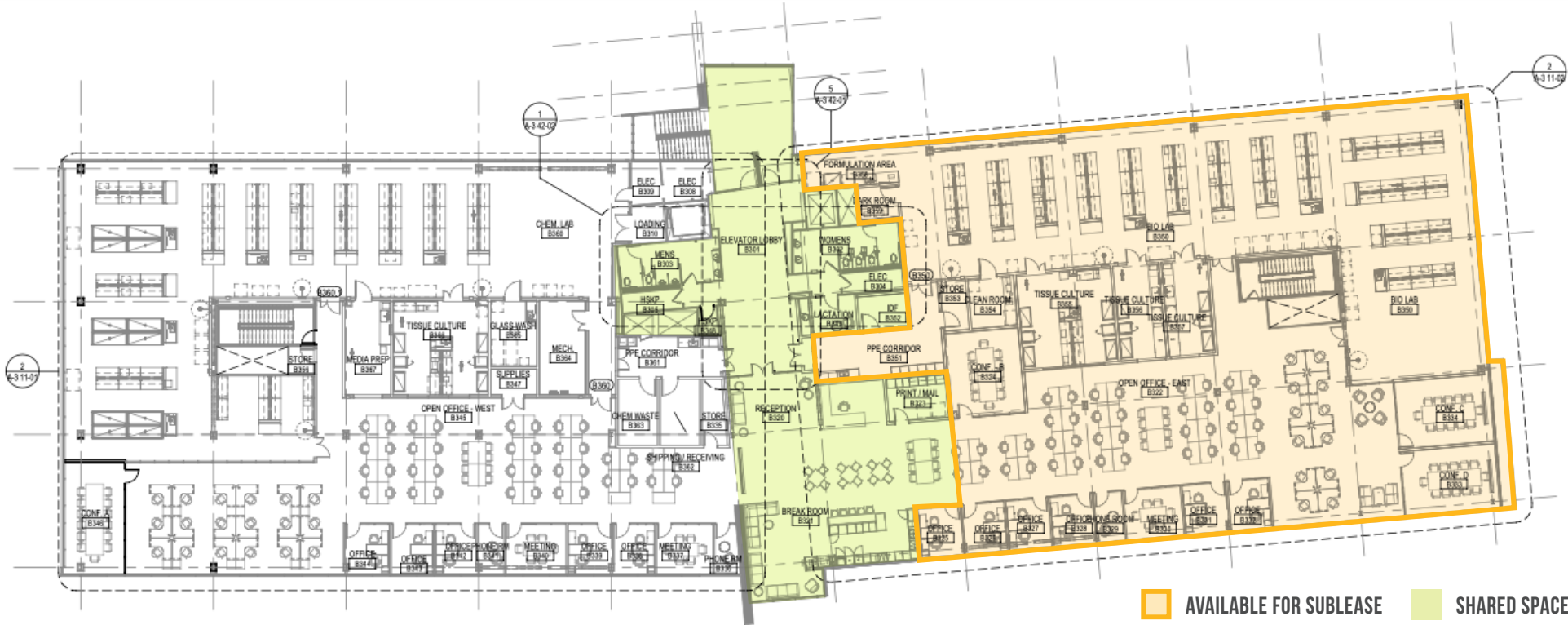

1480 64TH STREET

EMERYVILLE, CA

ARI ROKEACH

510.725.9163
ari.rokeach@nmrk.com
CA RE Lic #01986061

RANDY SCOTT

650.465.4222
randy.scott@nmrk.com
CA RE Lic #00852506

1111 BROADWAY, SUITE 100, OAKLAND, CA 94607

The distributor of this communication is performing acts for which a real estate license is required. The information contained herein has been obtained from sources deemed reliable but has not been verified and no guarantee, warranty or representation, either express or implied, is made with respect to such information. Terms of sale or lease and availability are subject to change or withdrawal without notice. **MP23-466 • 01/24**

NEWMARK