

**FOR
SALE**

**APPROX. 2,987/RSF.
RARE OPPORTUNITY.
RETAIL CONDO FOR SALE.**



**11
FIFTH
AVE**

PITTSBURGH, PA 15222

Commonwealth COMMERCIAL REAL ESTATE

■ 68,000
Employees
Within
Walking
Distance



**11
FIFTH
AVE**

- Prime Store Front Retail
- Former Fast/Casual Pizza Shop
- Restrooms Within the Space
- 2 Floors with Extra Seating



PROPERTY HIGHLIGHTS

11
FIFTH
AVE

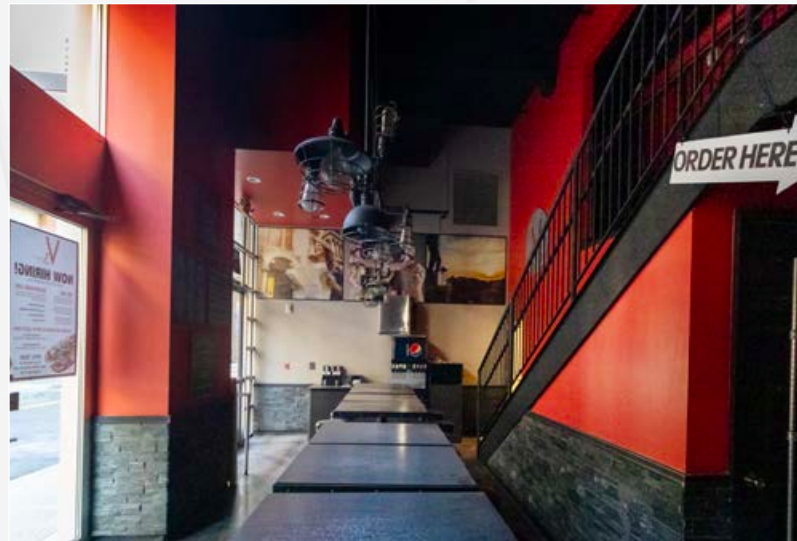

- High Daily Foot Traffic
- Various Equipment Included
- Built-in Infrastructure, w/ Hood Ventilation

PROPERTY HIGHLIGHTS

11
FIFTH
AVE

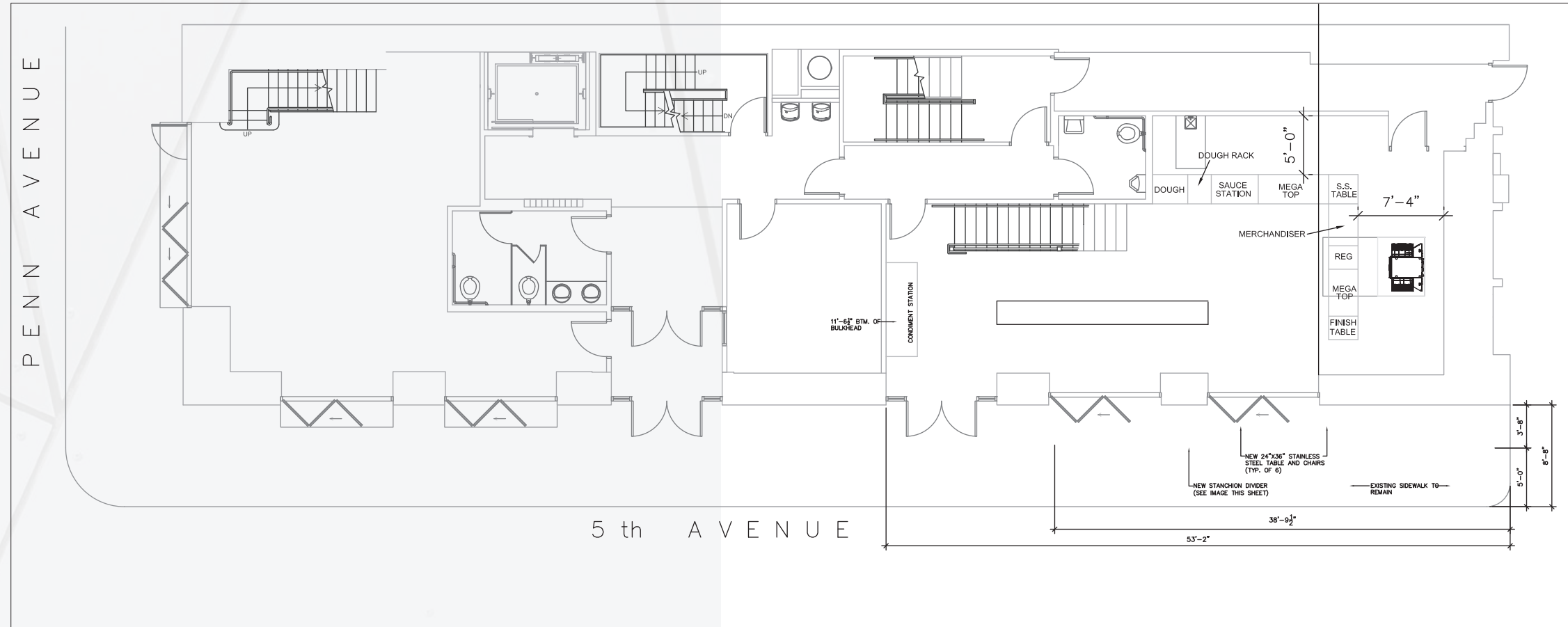

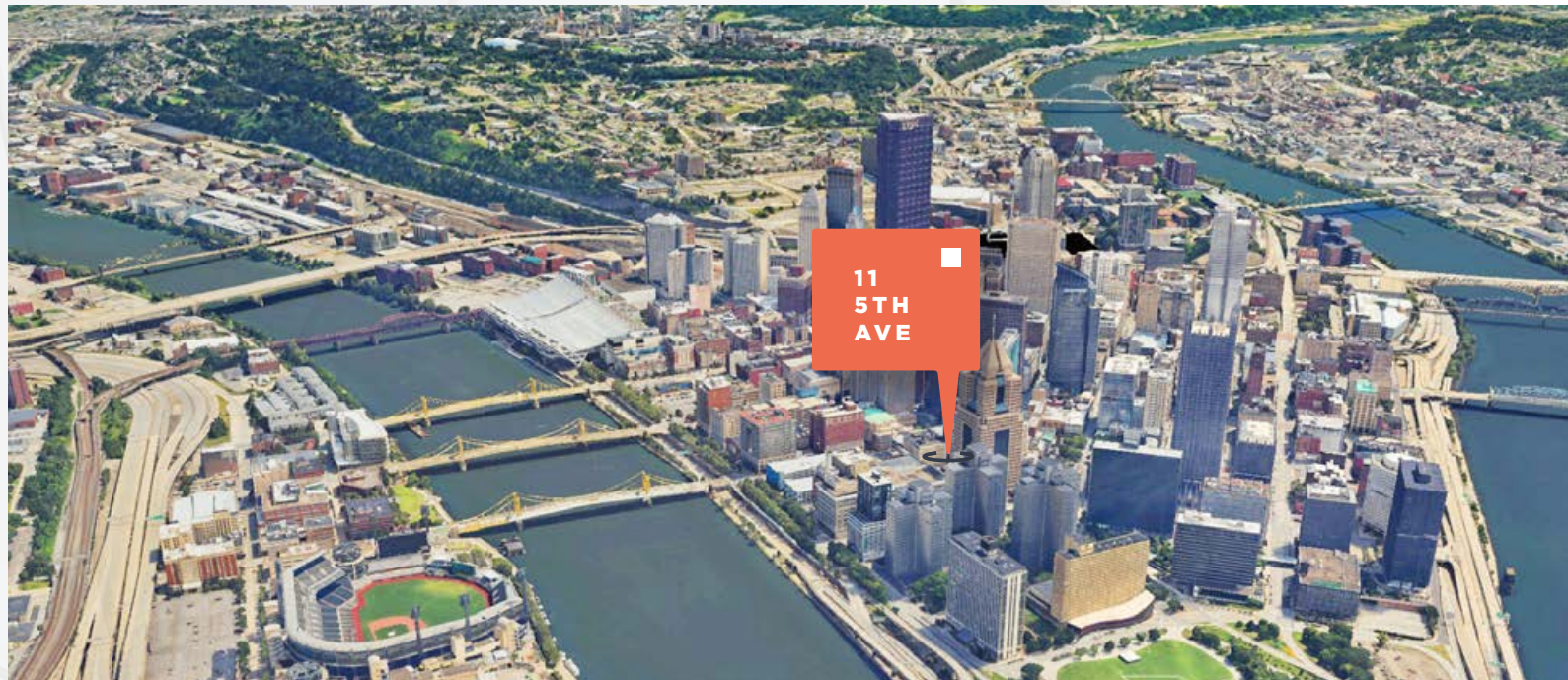

Downtown Pittsburgh, PA

Pittsburgh's excellent transportation infrastructure, including the Pittsburgh Light Rail Transit, provides easy access to the downtown area and surrounding neighborhoods. Additionally, the city's rich cultural scene, featuring world-class museums, theaters, and sporting events, attracts visitors and residents alike, contribute to a rejuvenated retail market.

With ongoing development projects and a focus on creating a vibrant urban experience, downtown Pittsburgh's restaurant scene is poised for continued growth and success.

THANK YOU!

NO WARRANTY OR REPRESENTATION, EXPRESS OR IMPLIED, IS MADE AS TO THE ACCURACY OF THE INFORMATION CONTAINED HEREIN, AND THE SAME IS SUBMITTED SUBJECT TO ERRORS, OMISSIONS, CHANGE OF PRICE, RENTAL OR OTHER CONDITIONS, PRIOR SALE, LEASE OR FINANCING, OR WITHDRAWAL WITHOUT NOTICE, AND OF ANY SPECIAL LISTING CONDITIONS IMPOSED BY OUR PRINCIPALS NO WARRANTIES OR REPRESENTATIONS ARE MADE AS TO THE CONDITION OF THE PROPERTY OR ANY HAZARDS CONTAINED THEREIN ARE ANY TO BE IMPLIED.

Commonwealth COMMERCIAL REAL ESTATE

Team Contacts



Nicole DeLuca

Managing Partner

NDeluca@CommonwealthCRE.com

o 412.937.1925 x280

c 412.287.9571



JR Yocco

Director of Brokerage & Development

JRYocco@CommonwealthCRE.com

o 412.937.1925 x280

c 412.559.1224

400 Lydia St. Suite 102 / Carnegie PA 15106

CommonwealthCRE.com | [in](#) | [@](#)