

Sketch

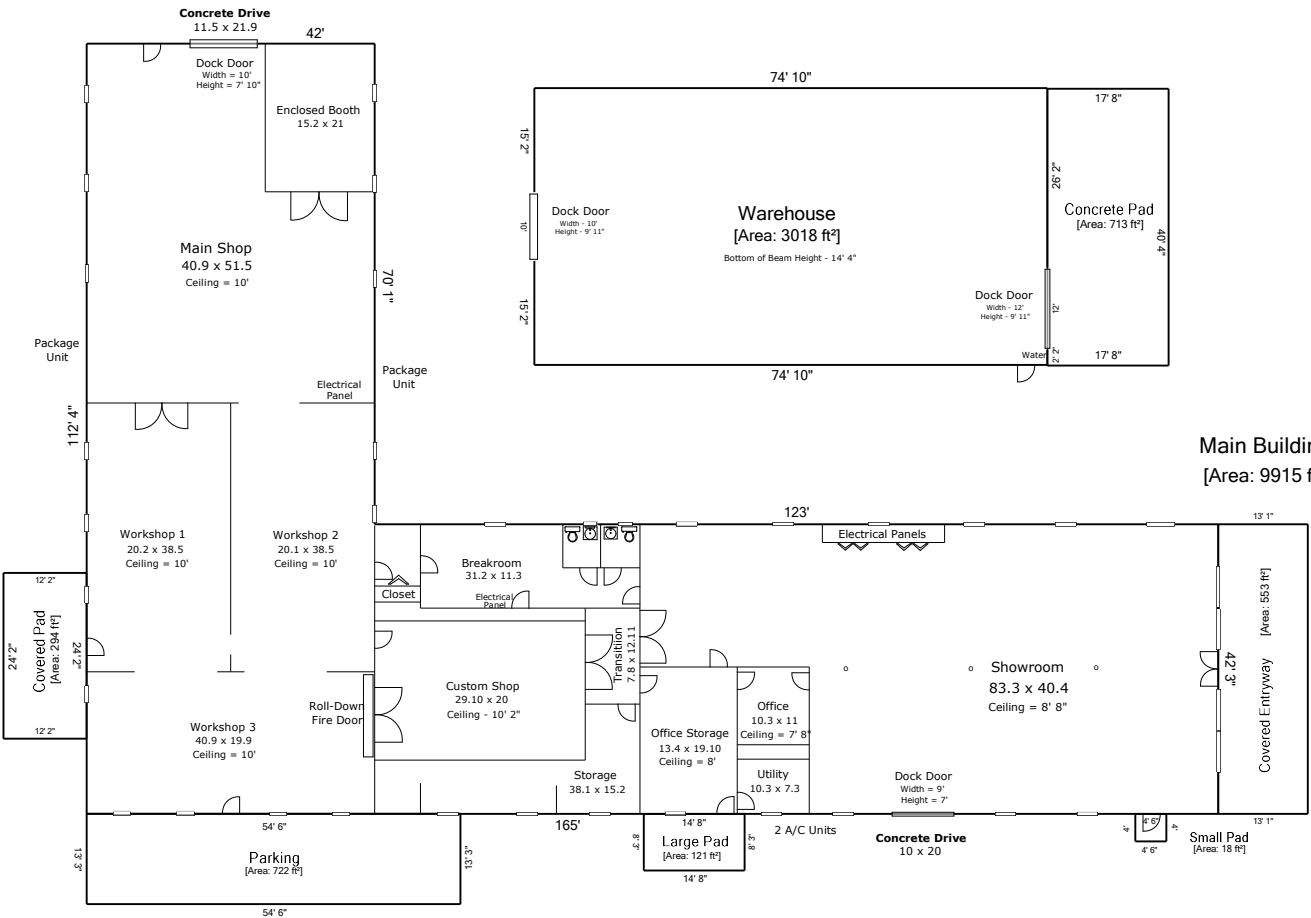

Living Area		Nonliving Area	
Main Building	9914.76 ft²	Parking	722.13 ft²
		Large Pad	121.00 ft²
		Small Pad	18 ft²
		Covered Entryway	552.77 ft²
		Concrete Pad	712.57 ft²
		Covered Pad	294.04 ft²
		Warehouse	3018.33 ft²
Total Living Area (rounded):	9915 ft²	Total Non-Living Area (rounded):	5439 ft²

Griffin Realty Services, LLC - All measurements are rounded to the nearest inch and intended for Marketing Purposes Only. Minor variations in calculated square footage of less than three percent may occur, due to tape reading, rounding, or conversion from inches to decimals.

Measurements for Boulevard, Marshville NC