

- NOTES:
1. CONTRACTOR SHALL RETAIN AND PROTECT ALL EXISTING UTILITIES, AND STORM DRAINAGE STRUCTURES UNLESS OTHERWISE NOTED.
 2. DIMENSIONS ARE TO FACE OF CURB, FACE OF RETAINING WALL, EDGE OF PAVEMENT, OUTSIDE EDGE OF BUILDING, OR PROPERTY LINE UNLESS OTHERWISE NOTED.
 3. PRIOR TO ANY SITE WORK CONSTRUCTION, VERIFY THE BUILDING DIMENSIONS WITH THE ARCHITECTURAL DRAWINGS.
 4. PRIOR TO SITE PAVING, COORDINATE THE PLACEMENT OF CONCRETE ELECTRICAL PADS, HVAC PADS, DUCTS, IRRIGATION CHASES, AND AREA LIGHTING WITH ARCHITECTURAL DRAWINGS & THE OWNER.
 5. ALL DISTURBED AREAS NOT RECEIVING STRUCTURAL IMPROVEMENTS OR LANDSCAPING SHALL BE ESTABLISHED WITH PERMANENT VEGETATION BY TOPSOILING AND EITHER SODDING OR SEEDING & MULCHING.
 6. ON SITE PAVEMENT MARKINGS SHALL BE CLASS 1, TYPE "A" (REFLECTIVE PAINT) IN ACCORDANCE WITH ALABAMA DEPARTMENT OF TRANSPORTATION SPECIFICATIONS.

LEGEND

- FH EXISTING FIRE HYDRANT
- PP POWER POLE/UTILITY POLE
- LP LIGHT POLE
- UP UTILITY POLE
- WV WATER VALVE
- WM WATER METER
- GM GAS METER
- GV GAS VALVE
- SM SANITARY MANHOLE
- SC SANITARY CLEANOUT
- DM DRAINAGE MANHOLE
- TB TELEPHONE BOX
- SI SIGN
- ECM EXISTING CONCRETE MONUMENT
- EIP EXISTING IRON PIN
- MB MAILBOX
- GW GUY WIRE
- CR CABLE RISER
- EM ELECTRIC METER
- SCM SET CONCRETE MONUMENT
- SIP SET IRON PIN
- GM EXISTING GAS MAIN
- UT UNDERGROUND TELEPHONE
- UC UNDERGROUND CABLE
- O/C OVERHEAD CABLE
- OE OVERHEAD ELECTRIC
- OEC OVERHEAD ELECTRIC AND CABLE LINE
- SS EXIST. SANITARY SEWER LINE
- FM EXIST. SANITARY SEWER FORCE MAIN
- W EXIST. WATER MAIN
- SL EXIST. STORM DRAIN LINE
- TL EXISTING TREE LINE
- X EXISTING FENCE (WIRE)
- WO EXISTING FENCE (WOODEN)
- CL EXISTING FENCE (CHAIN LINK)
- 325 EXISTING CONTOUR
- PRO C PROPOSED CONTOUR
- PRO W PROPOSED WATER LINE
- FH PROPOSED FIRE HYDRANT ASSEMBLY
- PRO SS PROPOSED SANITARY SEWER LINE
- ML MINIMUM BUILDING LINE
- UE UNDERGROUND ELECTRIC
- PL PROPERTY LINE
- EL EXISTING EASEMENT LINE
- ML MATCHLINE
- PC PROPOSED CONCRETE
- PCS PROPOSED CONCRETE SIDEWALK
- PA PROPOSED ASPHALT PAVEMENT

PROJECT No.
0090-19

DATE: JULY, 2020

SCALE: 1"=60'

DRAWN BY:
T. SCARBOROUGH

APPROVED BY:
L. BROWN

REVISIONS:

CONSTRUCTION PLANS FOR
HARPER'S STATION
CITY OF DOTHAN
HOUSTON COUNTY, ALABAMA
OVERALL LAYOUT PLAN

NORTHSTAR
ENGINEERING SERVICES

(P)334.673.9895 (F)334.673.1846
2431 Hartford Hwy Dothan, AL. 36905
web: www.northstarengineering.com

AL CERT. OF AUTH.
CA-1898E, CA-0621LS

FL CERT. OF AUTH.
26312-E, 7858-S

GA CERT. OF AUTH.
003129, LSF001156

MS CERT. OF AUTH.
E-00001825

FOR REVIEW ONLY

SHEET **5**
OF **30**

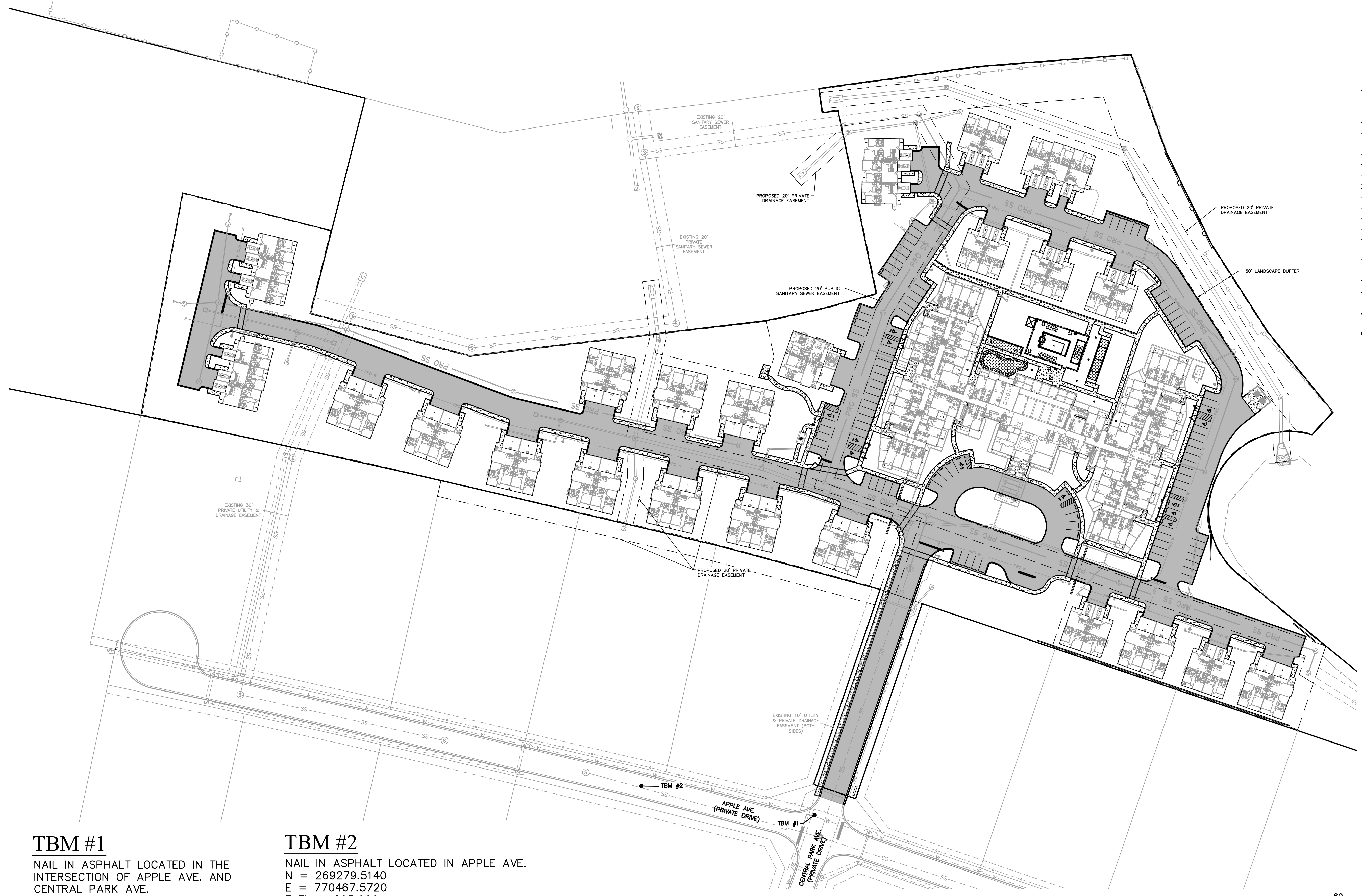

TBM #1
NAIL IN ASPHALT LOCATED IN THE INTERSECTION OF APPLE AVE. AND CENTRAL PARK AVE.
N = 269243.4430
E = 770681.8740
ELEV = 297.902

TBM #2
NAIL IN ASPHALT LOCATED IN APPLE AVE.
N = 269279.5140
E = 770467.5720
ELEV = 295.969

