

# FOR SALE

## 2 INDUSTRIAL LOTS

San Jacinto, California

**CANNABIS  
ZONE**

**Utilities at Property -  
Curb & Gutter on 2  
Streets (Buyer to  
Verify All)**



### Excellent Industrial Site Location

- **Cannabis Zone approved**
- **Excellent owner/user opportunity**
- Esplanade Avenue and Commerce Lane intersection
- Located in busy commercial corridor
- APN: 439-070-056; 067 (formerly -055) Lots total ±.96 Acres
- Street, curb, and utilities to be verified by Buyer
- Zoning: IL-Industrial Light (City of San Jacinto)
- Neighbors include: Edelbrock Foundry Corp., Skyline Corp. Hemet Valley Pipe & Supply

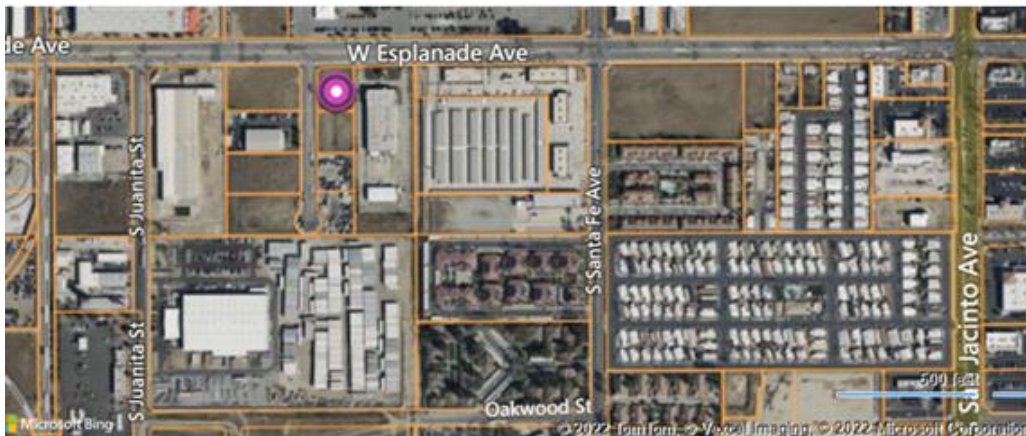

**ASKING PRICE: Both Lots: \$627,264**

FOR ADDITIONAL INFORMATION CONTACT

Guy W. Excell or Howard B. Rosenthal

(951) 658-2559

DRE License No. 01138381

1600 East Florida Avenue, Suite 110

Hemet, California 92544

(951) 658-2559 ▪ Fax: (951) 658-7690

email: [hrg@rosenthalexcell.com](mailto:hrg@rosenthalexcell.com)



**Rosenthal & Excell**  
Commercial Real Estate Services