

SUBLEASE

# 1920-J STARITA ROAD CHARLOTTE, NC 28206

FOUNDRY  
COMMERCIAL

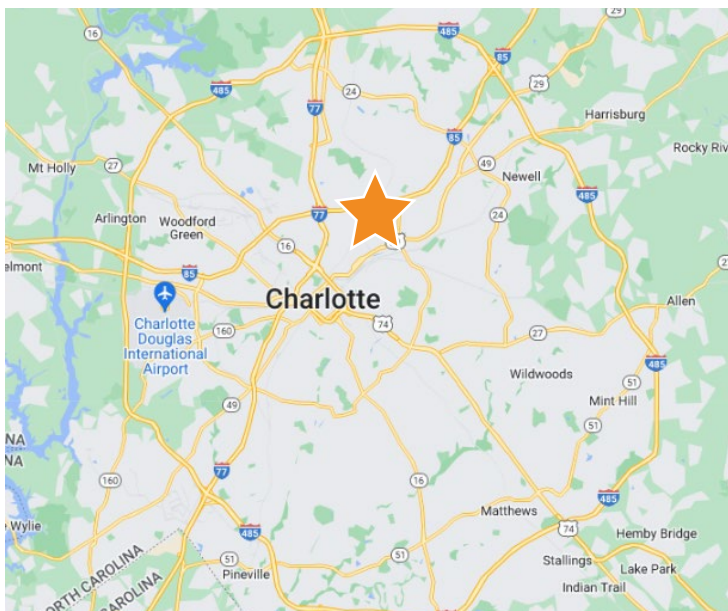

## SUBLEASE BUILDING FEATURES

TOTAL SQUARE FEET **±4,860 SF**

OFFICE **±1,350 SF**

CLEAR HEIGHT **16'**

DOCK HIGHS **1**

COLUMN SPACING **36' x 33'**

ZONING **I-2**

SPRINKLER **Wet**

SUBLEASE EXPIRATION **4/30/26**

FOR MORE INFORMATION, PLEASE CONTACT:

WARREN SNOWDON | 704.965.1178

Managing Director | Principal

Warren.Snowdon@foundrycommercial.com

Licensed Real Estate Broker

DAVID HANNA | 704.607.9675

Partner

David.Hanna@foundrycommercial.com

Licensed Real Estate Broker

FOUNDRY  
COMMERCIAL

2151 Hawkins Street, Suite 1000  
Charlotte, NC 28203

[foundrycommercial.com](http://foundrycommercial.com)

Although the information contained herein was provided by sources believed to be reliable, Foundry Commercial makes no representation, expressed or implied, as to its accuracy and said information is subject to errors, omissions or changes.

SUBLEASE

# 1920-J STARITA ROAD CHARLOTTE, NC 28206

## PROPERTY DETAILS

- ± 48,600 SF Total Building
  - » ± 4,860 SF Warehouse Available For Sublease
  - » ± 1,350 SF Office
- Loading:
  - » One (8' x 10') Dock High Door
- Clear Height: 16'
- Gas Heat in Warehouse
- Located in Woodland Business Park with easy access to I-85, I-77, and Uptown Charlotte

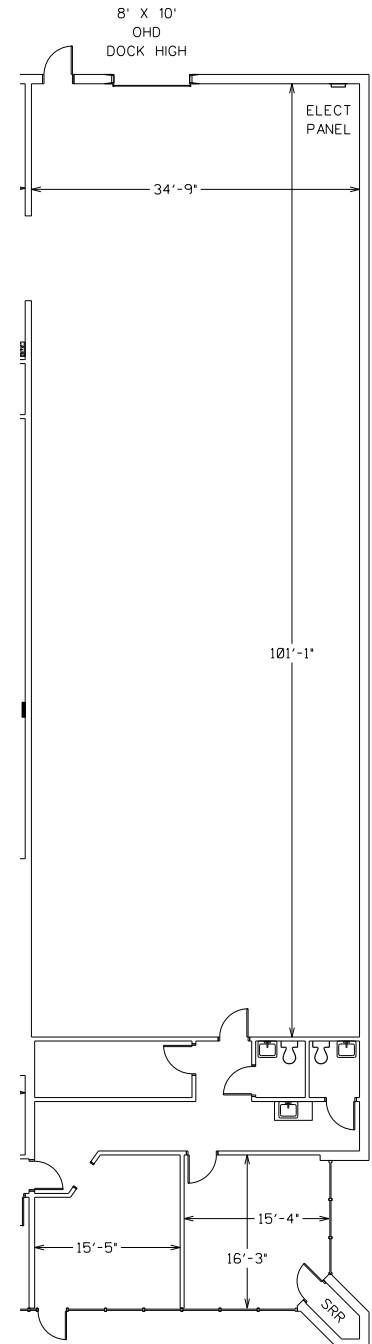

FOR MORE INFORMATION, PLEASE CONTACT:

**WARREN SNOWDON | 704.965.1178**  
Managing Director | Principal  
Warren.Snowdon@foundrycommercial.com  
Licensed Real Estate Broker

**DAVID HANNA | 704.607.9675**  
Partner  
David.Hanna@foundrycommercial.com  
Licensed Real Estate Broker

**FOUNDRY**  
COMMERCIAL

2151 Hawkins Street, Suite 1000  
Charlotte, NC 28203

[foundrycommercial.com](http://foundrycommercial.com)

Although the information contained herein was provided by sources believed to be reliable, Foundry Commercial makes no representation, expressed or implied, as to its accuracy and said information is subject to errors, omissions or changes.