

# SKETCH ADDENDUM

Intended User			
Property Address 8641 N Lombard St			
City Portland	County Multnomah	State OR	Zip Code
Client			

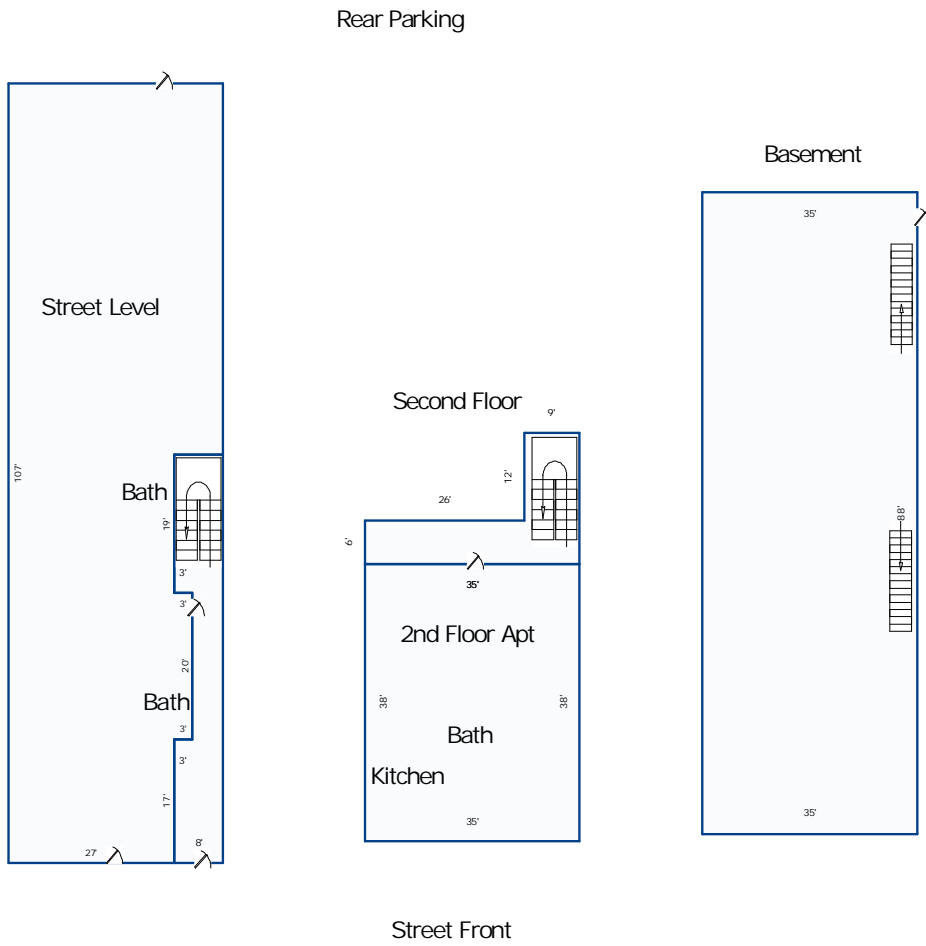

Sketch by Apex Medina™

Comments:

AREA CALCULATIONS SUMMARY			
Code	Description	Net Size	Net Totals
GLA1	First Floor	3357.0	
	First Floor	388.0	
	Second Floor	1330.0	
	Second Floor	318.0	5393.0
BSMT	Basement	3080.0	3080.0
Net LIVABLE Area		(rounded)	5393

LIVING AREA BREAKDOWN			
Breakdown			Subtotals
<b>First Floor</b>			
27.0	x	17.0	459.0
30.0	x	20.0	600.0
19.0	x	27.0	513.0
35.0	x	51.0	1785.0
8.0	x	17.0	136.0
19.0	x	8.0	152.0
20.0	x	5.0	100.0
<b>Second Floor</b>			
35.0	x	38.0	1330.0
6.0	x	35.0	210.0
12.0	x	9.0	108.0
10 Items	(rounded)		5393

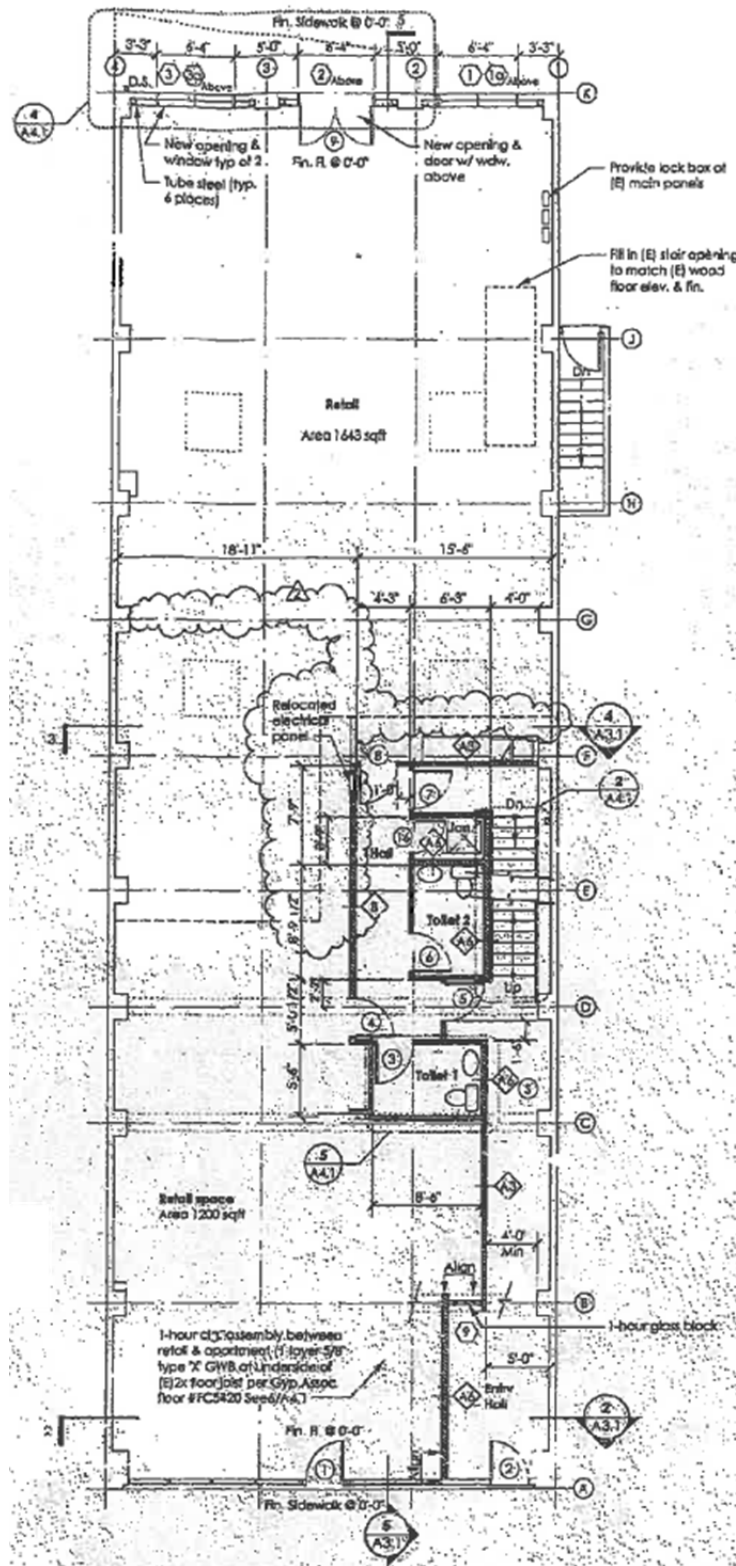

Ground Floor Plan

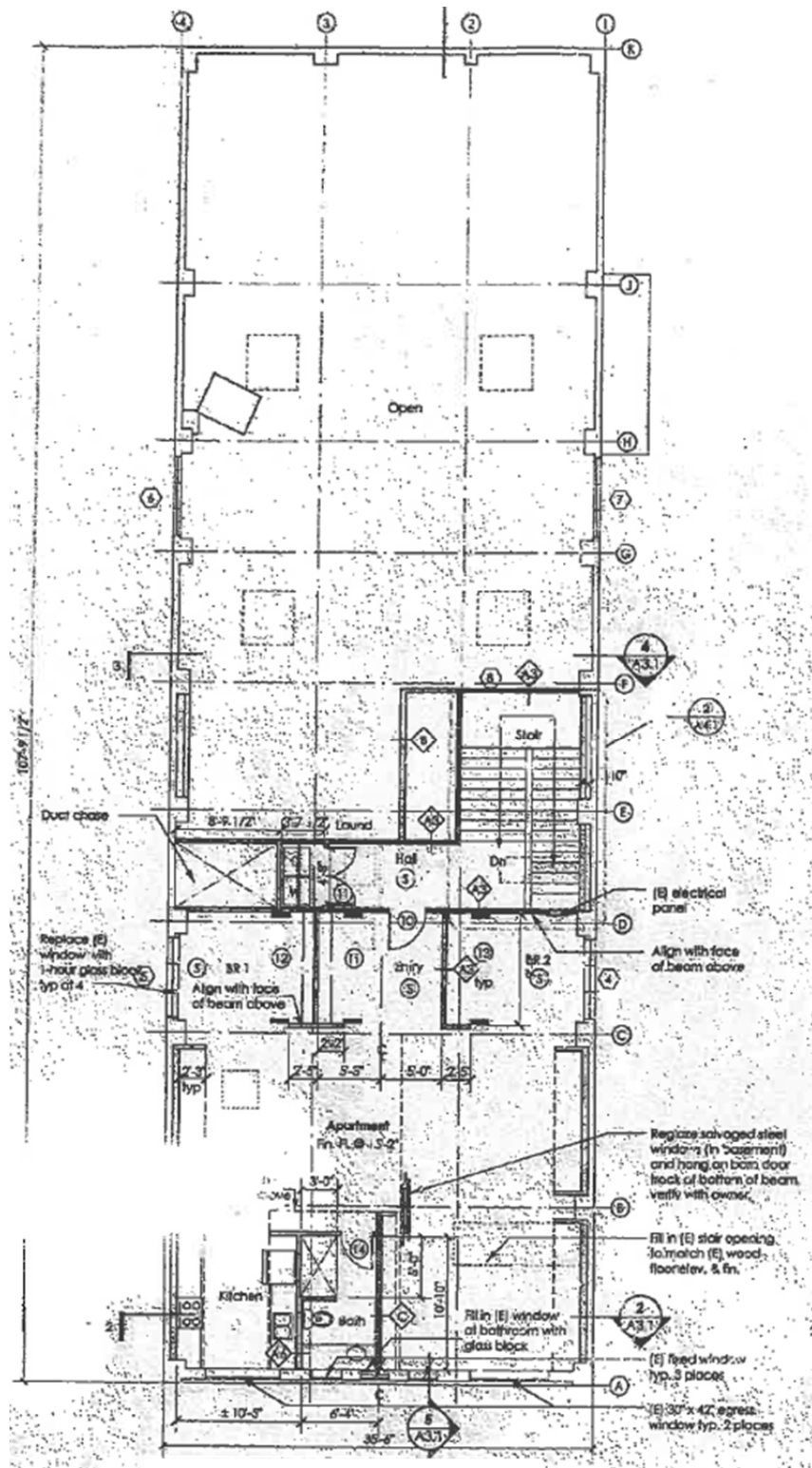

Second Floor Plan

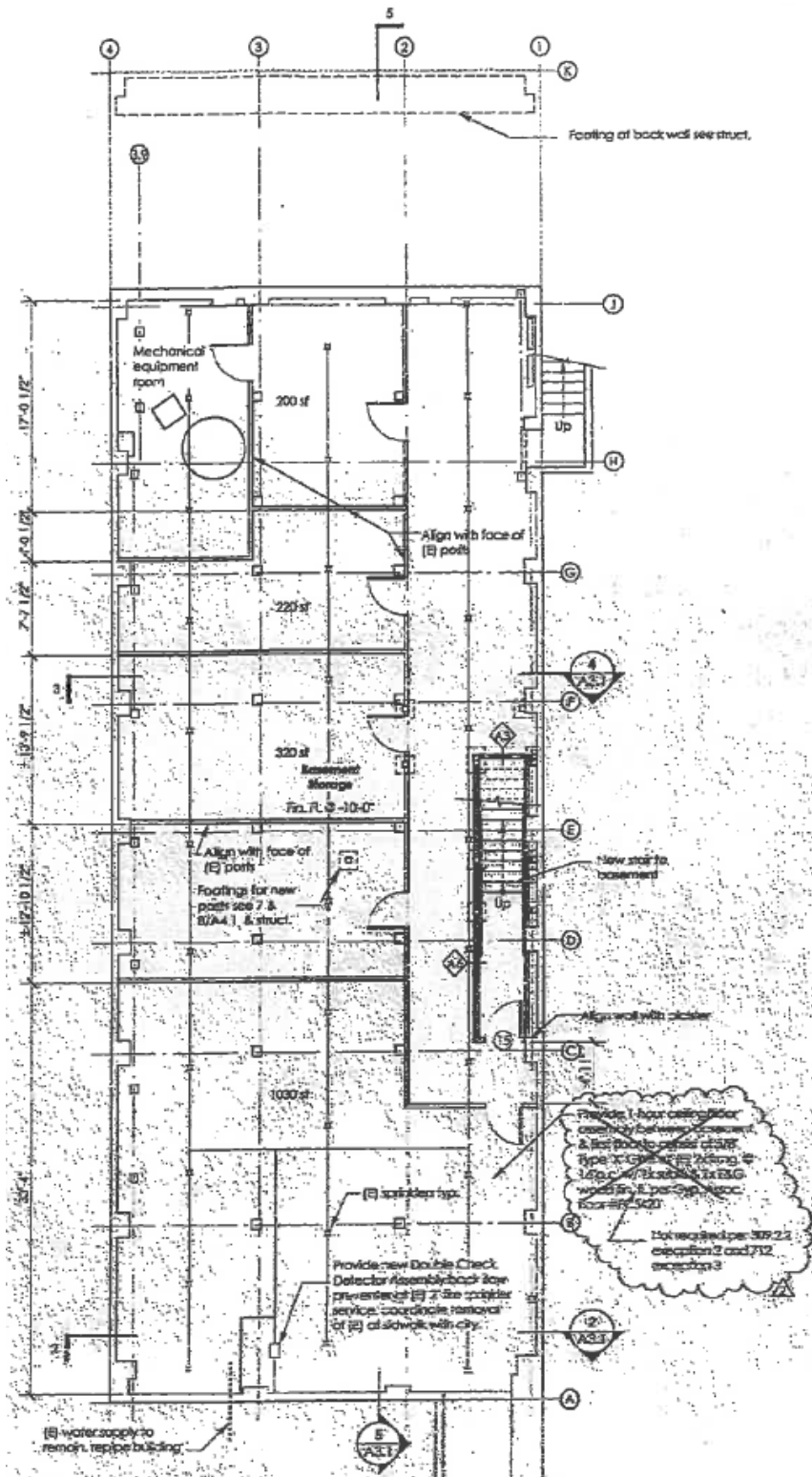

Basement Floor Plan