

**SALE/
LEASE**

Office Condo

5388 Discovery Park Boulevard | Williamsburg, VA 23188



**COMMONWEALTH
COMMERCIAL**
Comprehensive Property Solutions

Sale Price: \$300,000



PROPERTY HIGHLIGHTS

- › 1,640± SF Former Dentist Office (Ample In Floor Power, Oxygen and Nitrous Bays)
- › Excellent Layout For a Variety of Commercial or Medical Uses
- › Available For Sale or Lease
- › Lease Rate Negotiable
- › Seller Financing Available
- › Ample Parking Available
- › Located in New Town Williamsburg, a Mixed-Use Development West of Downtown Williamsburg

DEMOGRAPHICS	1 MILE	3 MILE	5 MILE
TOTAL POPULATION	6,686	46,084	82,159
AVERAGE HH INCOME	\$155,385	\$163,289	\$168,745
DAYTIME EMPLOYEES	5,482	21,080	31,501

FOR MORE INFORMATION:

NOAH REYES

Senior Associate

757-377-8580

nreyes@commonwealthcommercial.com

STANTON MCDUFFIE

Sales & Leasing Associate

757-672-1303

smcduffie@commonwealthcommercial.com

Commonwealth Commercial Partners, LLC represents the Landlord of this property. Information contained herein is deemed reliable but is not guaranteed.

FLOOR PLAN

1,640± SF

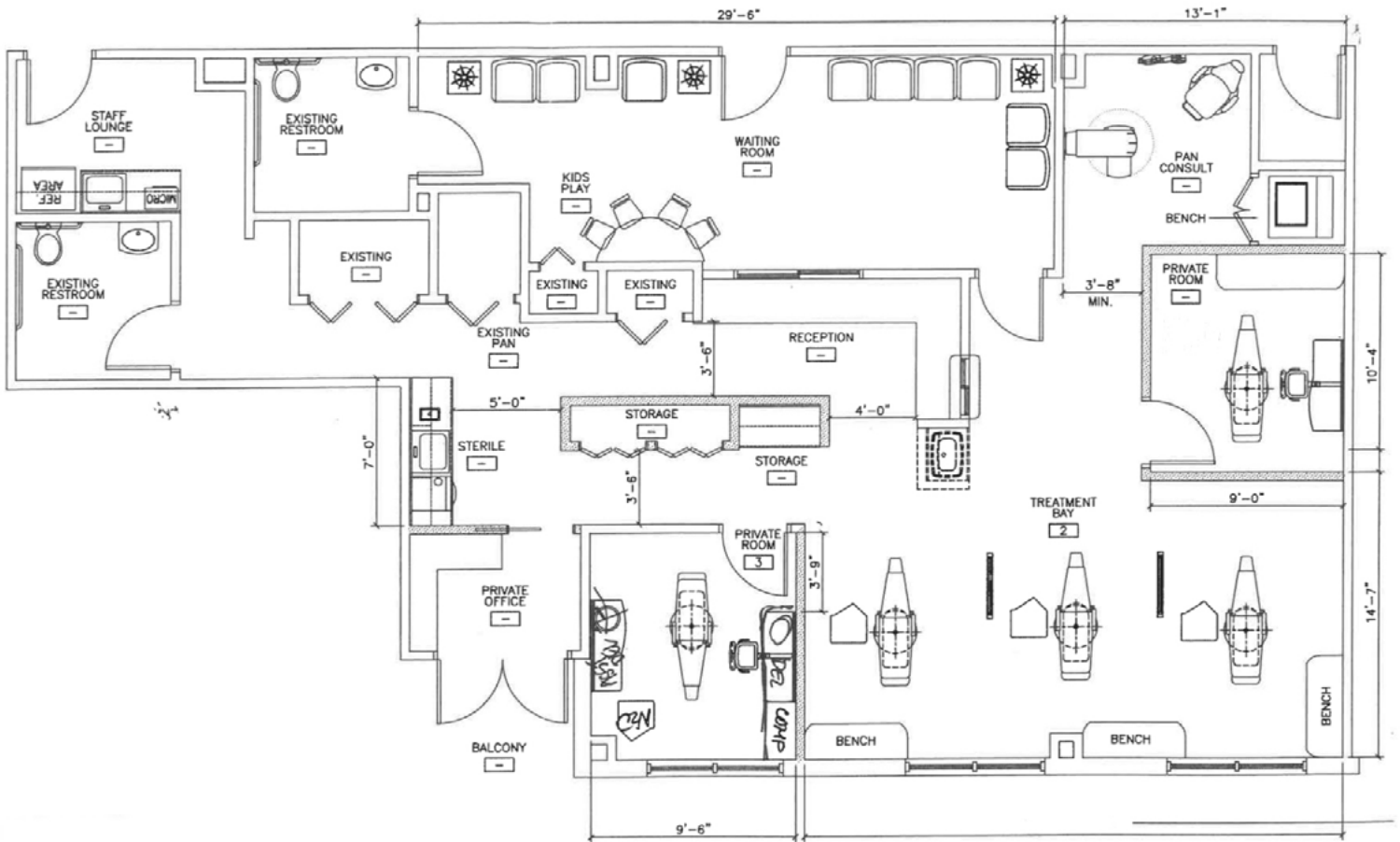



FOR SALE/LEASE | 5388 DISCOVERY PARK BOULEVARD
WILLIAMSBURG, VA 23188



FOR SALE/LEASE | 5388 DISCOVERY PARK BOULEVARD
WILLIAMSBURG, VA 23188



LOCATION IS EVERYTHING

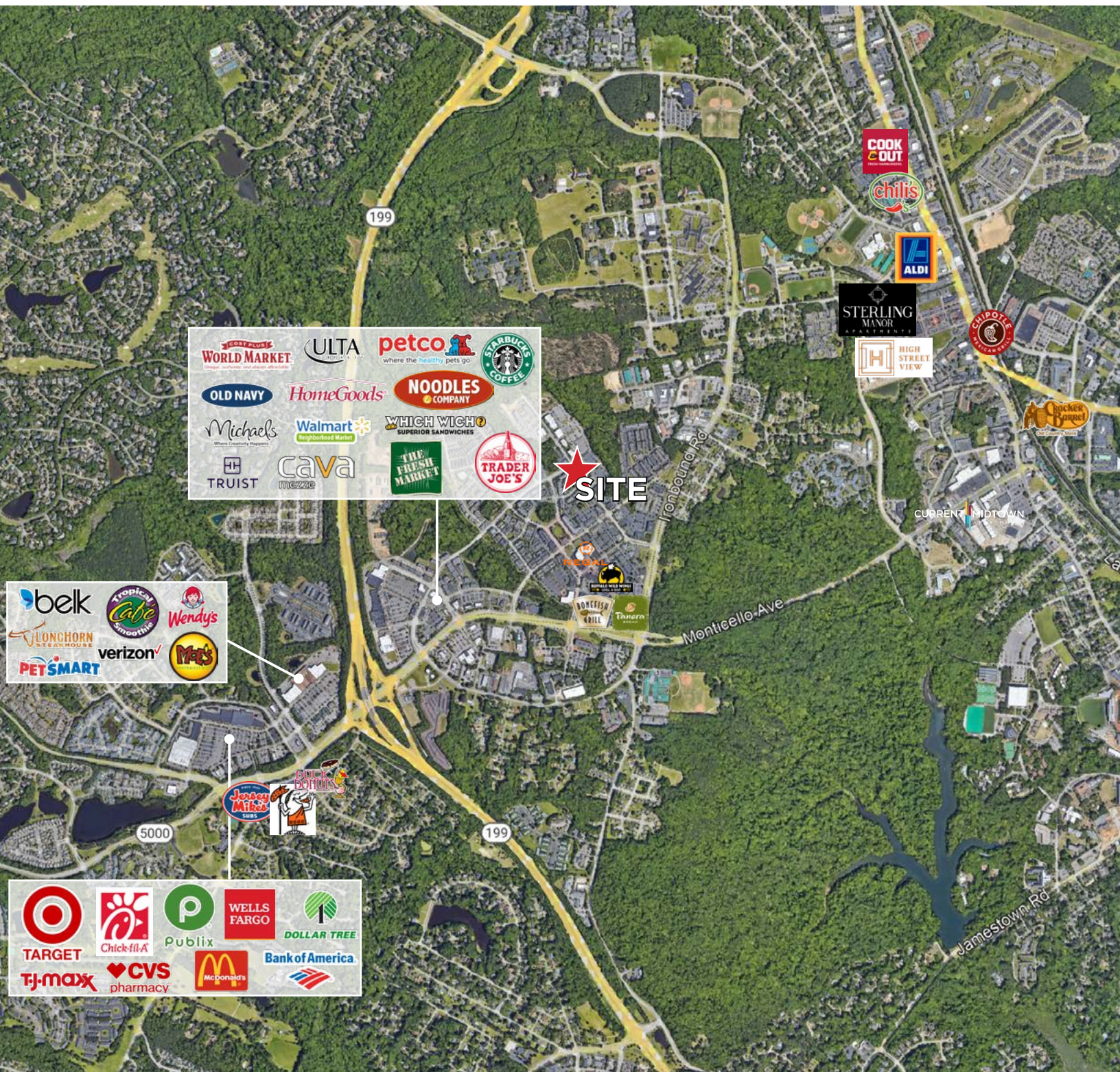

FOR SALE/LEASE | 5388 DISCOVERY PARK BOULEVARD
WILLIAMSBURG, VA 23188