

WESTCOT BUILDING

14175 Icot Boulevard
Clearwater, FL 33760

FOR LEASE

OFFICE / FLEX



4,575 – 42,797 SF Available for Lease

Centrally located in Pinellas County. Adjacent to US Hwy 19 and Ulmerton Road with excellent access to I-275, Roosevelt Blvd., Gandy Blvd. and St. Pete International Airport (PIE)

Property Highlights

| | |
|--|--|
| Address | 14175 Icot Blvd., Clearwater, FL 33760 |
| Type: | Class B+ office space/light flex |
| Year Built | 1999 / 2005 |
| Total Bldg. SF | 42,797 |
| Available SF | 4,575 – 42,797 SF |
| Parking Ratio | 4.6/1,000 SF |
| Asking Rate | \$14.50/SF Modified Gross |
| In park amenities | Retail, restaurants & hotel |
| <i>This Building is also available for Sale at \$4,200,000</i> | |



MELANIE JACKSON, SIOR, CCIM

Director

+1 727 776 2780

melanie.jackson@cushwake.com



**CUSHMAN &
WAKEFIELD**

cushmanwakefield.com

WESTCOT BUILDING

14175 Icot Boulevard
Clearwater, FL 33760

FOR LEASE

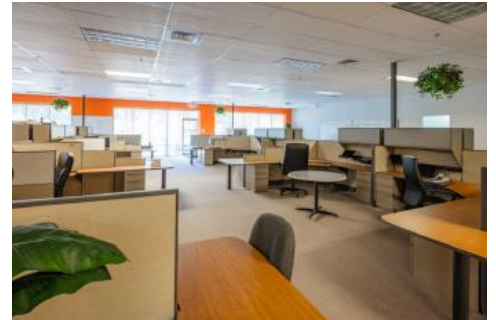
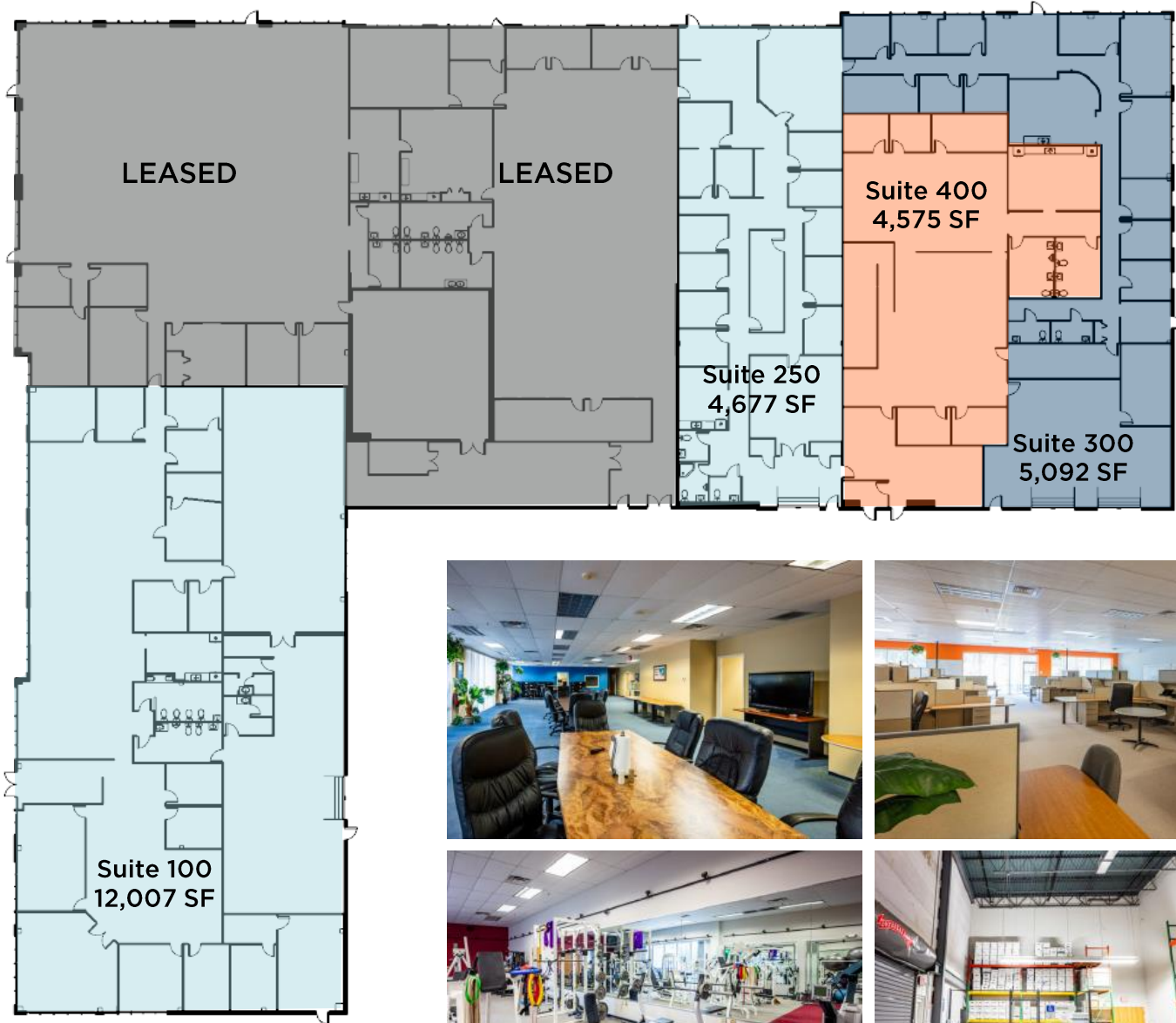

Each suite equipped with:

- Kitchen
- Offices
- Open area
- Drive-in loading door
- Building suite entry signage



**CUSHMAN &
WAKEFIELD**

cushmanwakefield.com

©2019 Cushman & Wakefield. All rights reserved. The information contained in this communication is strictly confidential. This information has been obtained from sources believed to be reliable but has not been verified. No warranty or representation, express or implied, is made as to the condition of the property (or properties) referenced herein or as to the accuracy or completeness of the information contained herein, and same is submitted subject to errors, omissions, change of price, rental or other conditions, withdrawal without notice, and to any special listing conditions imposed by the property owner(s). Any projections, opinions or estimates are subject to uncertainty and do not signify current or future property performance.