



7.29 ACRE

*K - 6 School Campus
for Sale or Lease*

5818 NORTHWEST LOOP 410
SAN ANTONIO, TX

FOR SALE OR
LEASE

Education
Advisory Group

CBRE

the offering

CBRE Education Advisory Group, as the exclusive advisor, is pleased to present the prime opportunity to acquire 5818 Northwest Loop 410, San Antonio TX 78238 (the "Property" or the "Project"). This remarkable campus encompasses approximately 61,862 sqft on 7.29 acres and offers a unique blend of facilities designed to foster project-based learning and collaboration.

The central core of the campus features flexible classrooms, outdoor collaboration areas, and indoor common spaces, all meticulously crafted to support dynamic educational experiences. The addition of two buildings totaling 28,106 sqft includes classrooms equipped with sectional doors that seamlessly integrate indoor and outdoor environments, enhancing the learning experience.

Core common areas are bathed in natural light through skylights and light wells, creating an inviting and conducive atmosphere for students. The thoughtful design exposes building systems such as ductwork, structure, IT, and electrical systems, providing educational insights and promoting hands-on learning.

Every aspect of the campus, from its walls to its exterior areas, were designed to offer unparalleled opportunities for learning and growth. This property is an exceptional investment for those seeking a versatile and inspiring educational environment.

San Antonio, TX, is the perfect blend of modern living and rich history. Nestled in the heart of Texas, this vibrant city offers an unparalleled quality of life. With its affordable housing, excellent schools, and thriving job market, San Antonio is an ideal place to live and work. The city boasts a diverse economy, anchored by healthcare, military, and technology sectors. Beyond work, residents enjoy a lively cultural scene, world-class dining, and endless recreational opportunities. From the iconic River Walk to the historic Alamo, every corner of San Antonio is brimming with charm. Join us in San Antonio, where the spirit of Texas comes alive, and every day is an adventure waiting to be discovered.

The offering is being made on an "as-is, where is" basis. Existing furniture fixtures and equipment can be made available.





investment summary



Asking Price
\$11M



Property Address
5818 Northwest Loop 410
San Antonio,
TX 78238



County
Bexar



Property Size
61,862 sqft on
7.29 Acres



Building Count
13 Single-story Modulares: 28,202 sqft
2 Steel Frame Buildings: 28,106 sqft
1 Gymnasium: 4,000 sqft +
1,736 sqft Storage



Occupancy
936 Students



Parking
105 Parking Spaces
Single Stall



School District
Northside Independent
School District (NISD)



Current Use
K-6



Zoning
C-2NA (Commercial
Nonalcoholic Sales)
I-2 (Heavy Industrial)



Seller
Bond Trustee/Lender

site plan

- 1 OFFICE (BUILDING A)
- 2 CLASSROOM COMPLEX (BUILDING B)
- 3 CLASSROOM COMPLEX (BUILDING C)
- 4 KINDERGARTEN (BUILDING N)
- 5 KINDERGARTEN (BUILDING M)
- 6 KINDERGARTEN (BUILDING L)
- 7 KINDER ARTS (BUILDING K)
- 8 VISUAL ARTS (BUILDING J)
- 9 THEATER (BUILDING H)
- 10 NUTRITION (BUILDING I)
- 11 MAINTENANCE (BUILDING O)

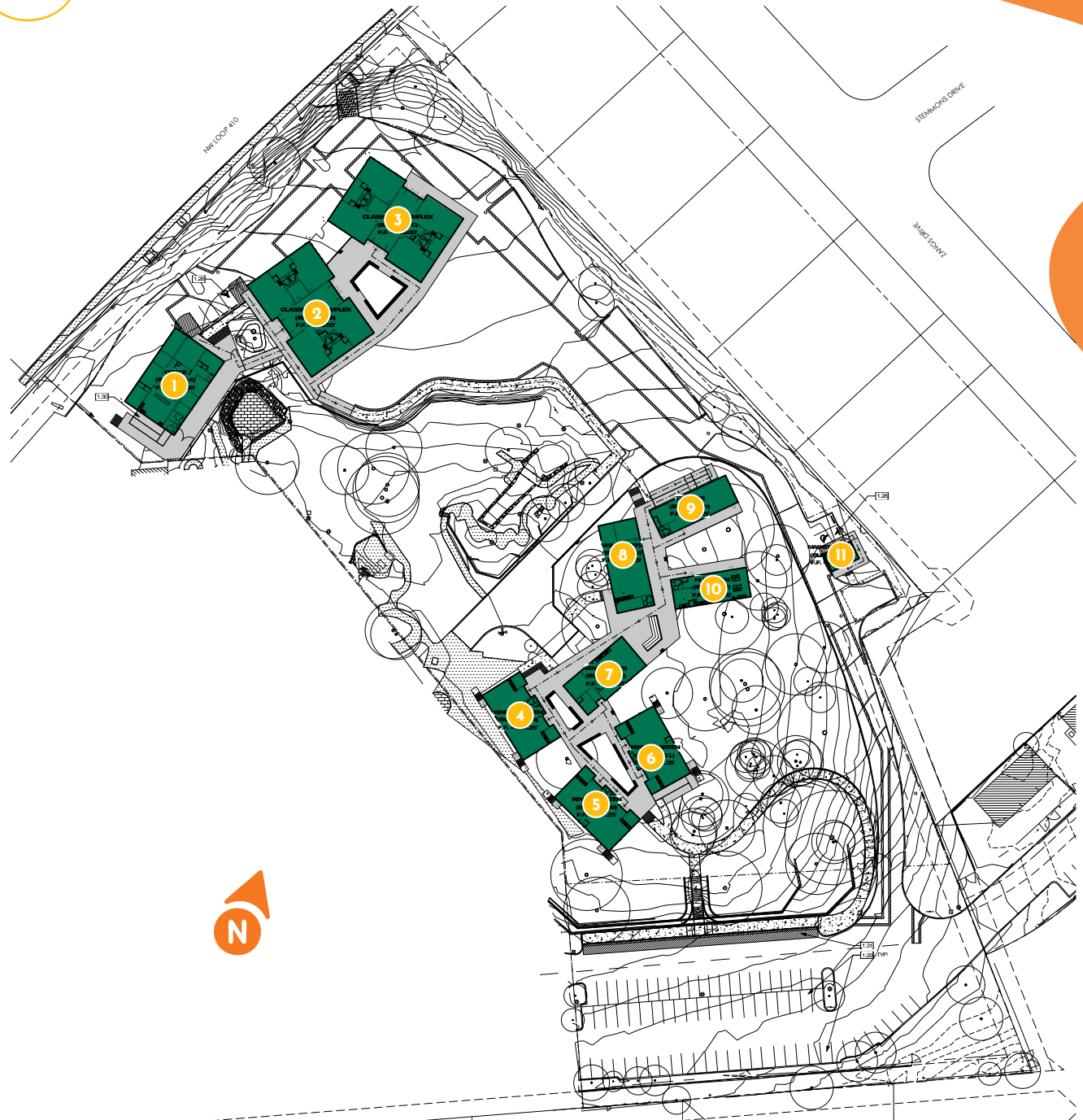

the location



SAN ANTONIO, TEXAS

Located in Northwest San Antonio at the convergence of I-410 & TX-16, this subject property resides within the Northside Independent School District, South Texas' largest school system and a "Destination District" for families seeking high-quality education. Residents and visitors enjoy diverse shopping, dining, and recreational opportunities, from exploring local parks to indulging in varied culinary experiences, with convenient access to major thoroughfares.

demographics

	1 MILE	3 MILES	5 MILES
POPULATION			
2024 Population - Current Year Estimate	13,281	122,067	358,673
HOUSEHOLDS			
2024 Households - Current Year Estimate	5,663	50,243	140,985
HOUSEHOLD INCOME			
2024 Average Household Income	\$63,540	\$70,990	\$76,410
2029 Average Household Income	\$72,414	\$80,450	\$87,006
EDUCATION			
Bachelor's Degree or Higher	1,806 20.0%	21,875 26.2%	69,976 28.6%
PLACE OF WORK			
2024 Businesses	870	4,576	12,109
2024 Employees	9,484	74,580	169,771

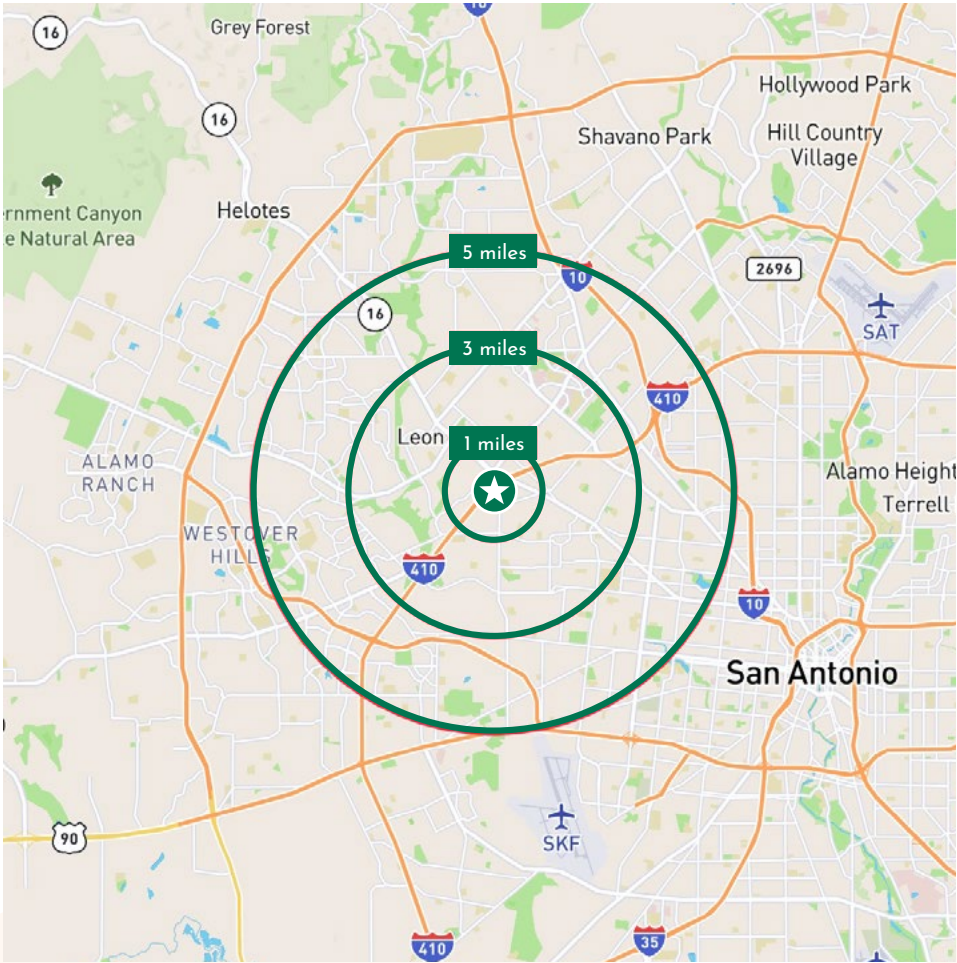

gallery



gallery



Affiliated Business Disclosure

CBRE, Inc. ("CBRE") operates within a global family of companies with many subsidiaries and related entities (each an "Affiliate") engaging in a broad range of commercial real estate businesses including, but not limited to, brokerage services, property and facilities management, valuation, investment fund management and development. At times different Affiliates, including CBRE Global Investors, Inc. or Trammell Crow Company, may have or represent clients who have competing interests in the same transaction. For example, Affiliates or their clients may have or express an interest in the property described in this Memorandum (the "Property") and may be the successful bidder for the Property. Your receipt of this Memorandum constitutes your acknowledgment of that possibility and your agreement that neither CBRE nor any Affiliate has an obligation to disclose to you such Affiliates' interest or involvement in the sale or purchase of the Property. In all instances, however, CBRE and its Affiliates will act in the best interest of their respective client(s), at arms' length, not in concert, or in a manner detrimental to any third party. CBRE and its Affiliates will conduct their respective businesses in a manner consistent with the law and all fiduciary duties owed to their respective client(s).

Confidentiality Agreement

Your receipt of this Memorandum constitutes your acknowledgment that (i) it is a confidential Memorandum solely for your limited use and benefit in determining whether you desire to express further interest in the acquisition of the Property, (ii) you will hold it in the strictest confidence, (iii) you will not disclose it or its contents to any third party without the prior written authorization of the owner of the Property ("Owner") or CBRE, Inc. ("CBRE"), and (iv) you will not use any part of this Memorandum in any manner detrimental to the Owner or CBRE. If after reviewing this Memorandum, you have no further interest in purchasing the Property, kindly return it to CBRE.

Disclaimer

This Memorandum contains select information pertaining to the Property and the Owner and does not purport to be all-inclusive or contain all or part of the information which prospective investors may require to evaluate a purchase of the Property. The information contained in this Memorandum has been obtained from sources believed to be reliable, but has not been verified for accuracy, completeness, or fitness for any particular purpose. All information is presented "as is" without representation or warranty of any kind. Such information includes estimates based on forward-looking assumptions relating to the general economy, market conditions, competition and other factors which are subject to uncertainty and may not represent the current or future performance of the Property. All references to acreages, square footages, and other measurements are approximations. This Memorandum describes certain documents, including leases and other materials, in summary form. These summaries may not be complete nor accurate descriptions of the full agreements referenced. Additional information and an opportunity to inspect the Property may be made available to qualified prospective purchasers. You are advised to independently verify the accuracy and completeness of all summaries and information contained herein, to consult with independent legal and financial advisors, and carefully investigate the economics of this transaction and Property's suitability for your needs. **ANY RELIANCE ON THE CONTENT OF THIS MEMORANDUM IS SOLELY AT YOUR OWN RISK.**

The Owner expressly reserves the right, at its sole discretion, to reject any or all expressions of interest or offers to purchase the Property, and/or to terminate discussions at any time with or without notice to you. All offers, counteroffers, and negotiations shall be non-binding and neither CBRE, Inc. nor the Owner shall have any legal commitment or obligation except as set forth in a fully executed, definitive purchase and sale agreement delivered by the Owner.

7.29 ACRE

K - 6 School Campus for Sale or Lease

5818 NORTHWEST LOOP 410
SAN ANTONIO, TX



exclusive advisors

WILL HAYNES II, SIOR

Executive Vice President

+1 214 979 6557

will.haynes2@cbre.com

MATTHEW MALLERS

First Vice President

+1 807 657 6587

matthew.mallers@cbre.com

JEROME FRIED

First Vice President

+1 310 463 7443

jerome.fried@cbre.com

© 2026 CBRE, Inc. All rights reserved. This information has been obtained from sources believed reliable but has not been verified for accuracy or completeness. You should conduct a careful, independent investigation of the property and verify all information. Any reliance on this information is solely at your own risk. CBRE and the CBRE logo are service marks of CBRE, Inc. All other marks displayed on this document are the property of their respective owners, and the use of such logos does not imply any affiliation with or endorsement of CBRE. Photos herein are the property of their respective owners. Use of these images without the express written consent of the owner is prohibited.

Education
Advisory Group

CBRE