

AVAILABLE FOR LEASE
515 ANDERSON DRIVE
 ROMEOVILLE, IL 60446

COMMON DOCK RAMP



BUILDING SPECIFICATIONS:

BUILDING SIZE:	38,325 SF
CLEAR HEIGHT:	19'
LOADING:	› 2 common loading docks › 9 drive-in doors (12'x14') - 1 per unit
SPRINKLER:	Wet
PARKING:	2.7 per 1000 SF
CAM:	\$2.09 PSF (est. 2024)
RE TAXES:	\$2.19 PSF (est. 2024)

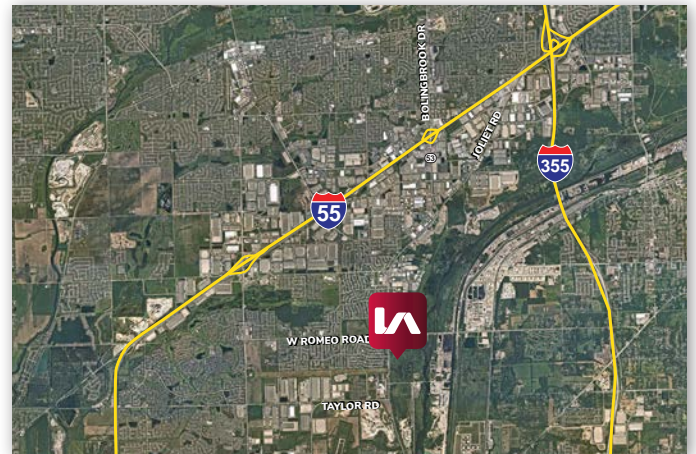

AVAILABLE:

UNIT NUMBER	UNIT SF	OFFICE SF	LOADING	POWER	NET RENT	COMMENTS
1000/1200	9,651	±2,800	3 Drive-in Doors 1 Shared Dock Ramp	125 amp, 480 volt 3-phase 4-wire	\$11.50 Net	Kitchenette
900	6,435	none	2 Drive-in Doors 1 Shared Dock Ramp	200 amp, 480 volt 3-phase 4-wire	\$11.50 Net	4 restrooms
300/400	6,293	none	2 Drive-in Doors 1 Shared Dock Ramp	200 amp, 480 volt 3-phase 4-wire	\$11.50 Net	1 restroom

Caroline A. Dell
 Vice President
 cdell@lee-associates.com
 D 773.355.3035

Owned by



All information furnished regarding property for sale, rental or financing is from sources deemed reliable, but no warranty or representation is made to the accuracy thereof and same is submitted to errors, omissions, change of price, rental or other conditions prior to sale, lease or financing or withdrawal without notice. No liability of any kind is to be imposed on the broker herein.

AVAILABLE FOR LEASE

515 ANDERSON DRIVE

ROMEORVILLE, IL 60446

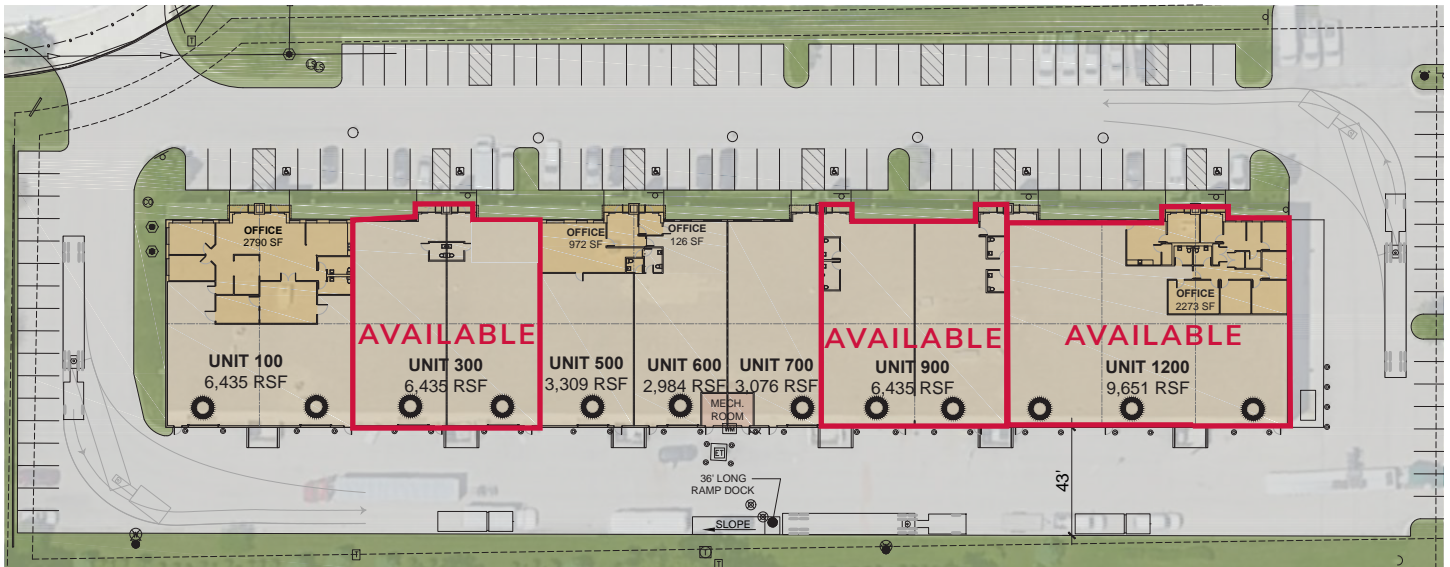

HIGHLIGHTS & FEATURES

- ▶ Great access to I-55 via Route 53
- ▶ Newer building with high image construction
- ▶ Will County Taxes
- ▶ Institutionally owned & professionally managed



Caroline A. Dell
Vice President
cdell@lee-associates.com
D 773.355.3035

Owned by



All information furnished regarding property for sale, rental or financing is from sources deemed reliable, but no warranty or representation is made to the accuracy thereof and same is submitted to errors, omissions, change of price, rental or other conditions prior to sale, lease or financing or withdrawal without notice. No liability of any kind is to be imposed on the broker herein.