

LEGEND- EXISTING

EXISTING PROPERTY, BY SURVEY

- PROPERTY LINE BOUNDARY
- PROPERTY EASEMENT
- MAJOR CONTOUR
- MINOR CONTOUR

EXISTING UTILITIES, BY SURVEY

- ELECTRIC LINE
- ⊗ ELECTRIC TRANSFORMER
- ⊙ ELECTRIC METER
- ⊕ OVERHEAD POWER POLE
- ⊓ TELEPHONE PEDESTAL
- ☀ STREET LIGHT
- SEWER LINE
- ⊕ SEWER MANHOLE
- WATER LINE
- ⊕ FIRE HYDRANT
- ⊕ WATER SERVICE CURB STOP
- ⊕ WATER VALVE

LEGEND- PROPOSED

- EXISTING TREES TO REMAIN**
- ⊕ LARCH TREE
- ⊕ LODGE POLE PINE TREE
- ⊕ DOUGLAS FIR TREE
- EXISTING TREES TO BE REMOVED**
- ⊗ LARCH TREE
- PROPOSED LANDSCAPING**
- BUFFER LANDSCAPING
- PERIMETER LANDSCAPING
- ⊕ SITE OBSCURING FENCING

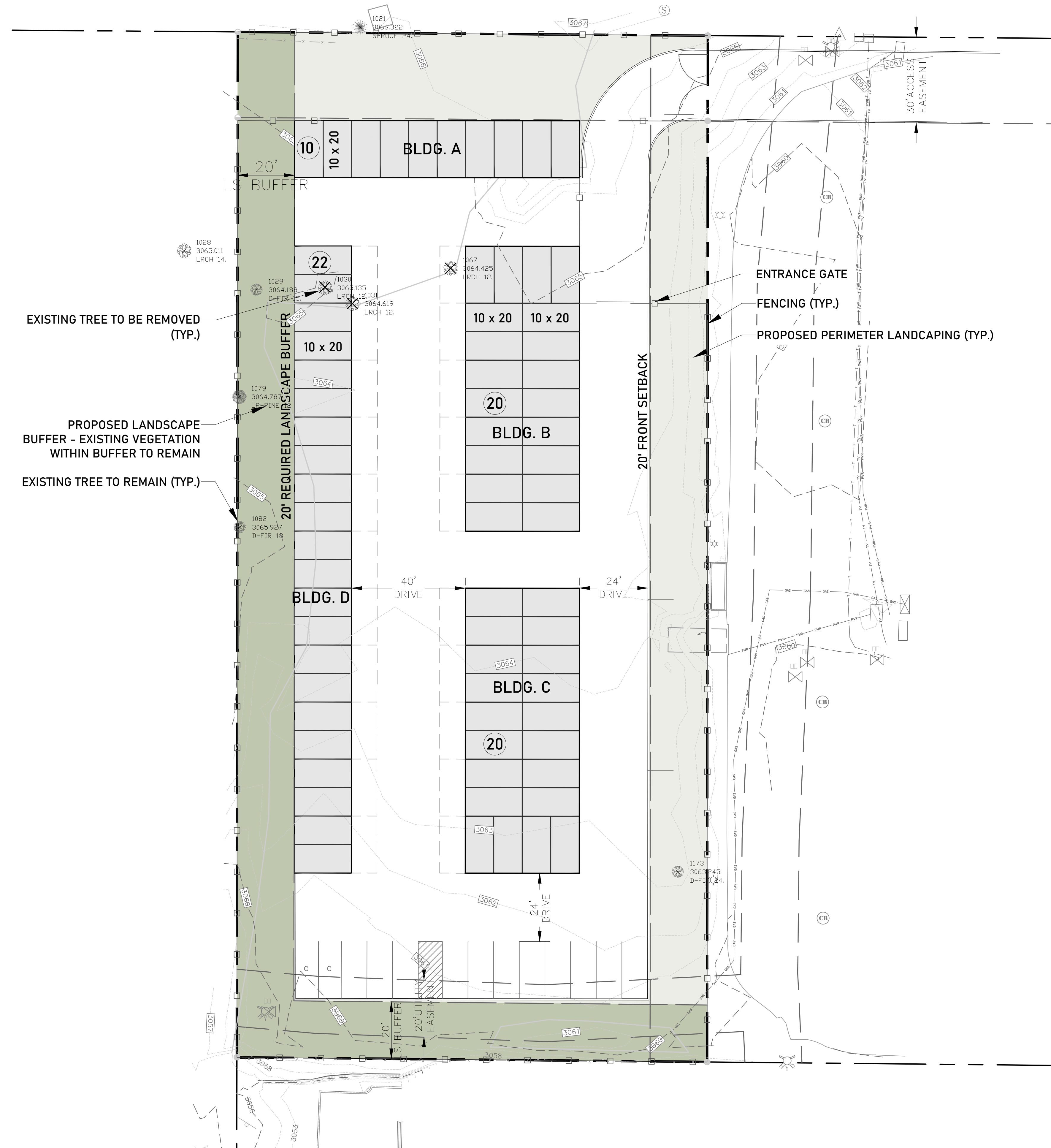

ZONING

WB-2

MINI STORAGE UNITS

PROPOSED UNIT TYPES:
 10X20 = 72 GROUND LEVEL
 UPPER UNIT POTENTIAL= Buildings B, C,
 & D
 TOTAL STORAGE UNITS = ?

PARKING

PROVIDED PARKING: 34 SPACES
 ALLOWABLE STORAGE SQ FT: 27,200

GROUND-LEVEL SQ. FT STORAGE: 14,400

SIGNIFICANT TREES

LIST OF ON-SITE TREES:

- 1029 DOUG FIR - 15"
- 1030 LARCH - 12"
- 1031 LARCH 12"
- 1079 LODGEPOLE PINE - 12"
- 1082 DOUG FIR - 18"
- 1173 DOUG FIR - 24"

PROPOSED TREE REMOVAL:

- TOTAL TREES = 7
- TREES TO REMAIN = 3
- TREES TO BE REMOVED = 4



**NW
 DESIGN
 STUDIO**

301 SECOND STREET E,
 SUITE 1B
 WHITEFISH, MT 59937
 PHONE 406-862-4755

SURVEY:
 SANDS SURVEYING
 2 VILLAGE LOOP
 KALISPELL, MT 59901
 406 | 755-6481

AKERS LANE MINI STORAGE

6394 HIGHWAY 93 S
 WHITEFISH, MT 59937
 LOT 1 OF AKERS SUBDIVISION
 SECT. T30N, R22W

Revisions:

NOT FOR CONSTRUCTION

Drawn By: C.W.
 Date: 3-16-2022
 Project Number: 20-56

**CONCEPT
 PLAN**

L1-01