

### 6 HAMPTON RD

**Location** 6 HAMPTON RD

**Mblu** 69 / 5 / 1

**Acct#** S8681R

**Owner** EXETER HEALTH RESOURCES  
INC

**Assessment** \$740,300

**Appraisal** \$740,300

**PID** 1949

**Building Count** 1

#### Current Value

Appraisal			
Valuation Year	Improvements	Land	Total
2024	\$435,000	\$305,300	\$740,300

Assessment			
Valuation Year	Improvements	Land	Total
2024	\$435,000	\$305,300	\$740,300

#### Parcel Addresses

Additional Addresses
No Additional Addresses available for this parcel

#### Owner of Record

**Owner** EXETER HEALTH RESOURCES INC

**Sale Price** \$0

**Co-Owner**

**Certificate**

**Address** 5 ALUMNI DR SUITE 205

**Book & Page** 2822/1851

EXETER, NH 03833

**Sale Date** 01/04/1990

#### Ownership History

Ownership History				
Owner	Sale Price	Certificate	Book & Page	Sale Date
EXETER HEALTH RESOURCES INC	\$0		2822/1851	01/04/1990

#### Building Information

##### Building 1 : Section 1

**Year Built:** 1970  
**Living Area:** 4,170  
**Replacement Cost:** \$708,987

**Building Percent Good:** 60  
**Replacement Cost**  
**Less Depreciation:** \$425,400

**Building Attributes**

Field	Description
Style:	Profess. Bldg
Model	Commercial
Grade	Average
Stories:	1
Occupancy	1.00
Exterior Wall 1	Vinyl Siding
Exterior Wall 2	
Roof Structure	Gable/Hip
Roof Cover	Asph/F Gls/Cmp
Interior Wall 1	Drywall/Sheet
Interior Wall 2	
Interior Floor 1	Carpet
Interior Floor 2	
Heating Fuel	Oil
Heating Type	Forced Air-Duc
AC Type	Central
Struct Class	
Bldg Use	HOSP PVT MDL-94
Total Rooms	
Total Bedrms	00
Total Baths	0
%Taxable	1
1st Floor Use:	3050
Heat/AC	HEAT/AC SPLIT
Frame Type	WOOD FRAME
Baths/Plumbing	AVERAGE
Ceiling/Wall	CEIL & WALLS
Rooms/Prtns	AVERAGE
Wall Height	8.00
% Comn Wall	0.00

**Building Photo**



(https://images.vgsi.com/photos/ExeterNHPhotos//0022/DSC00978\_22153.JPG)

**Building Layout**

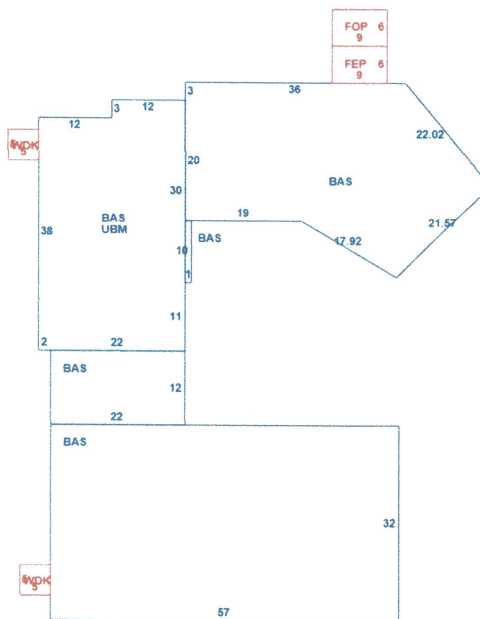

(ParcelSketch.ashx?pid=1949&bid=1949)

Building Sub-Areas (sq ft)			Legend	
Code	Description	Gross Area	Living Area	
BAS	First Floor	4,170	4,170	
FEP	Porch, Enclosed, Finished	54	0	
FOP	Porch, Open, Finished	54	0	
UBM	Basement, Unfinished	948	0	
WDK	Deck, Wood	50	0	
		5,276	4,170	

**Extra Features**

Extra Features		Legend
No Data for Extra Features		

**Land**

**Land Use**

**Use Code** 3420  
**Description** PROF BLDG MDL-94  
**Zone** NP  
**Neighborhood** C17  
**Alt Land Appr Category** No

**Land Line Valuation**

**Size (Acres)** 0.67  
**Frontage** 0  
**Depth** 0  
**Assessed Value** \$305,300  
**Appraised Value** \$305,300

**Outbuildings**

Outbuildings						Legend
Code	Description	Sub Code	Sub Description	Size	Assessed Value	Bldg #
PAV1	PAVING-ASPHALT			4800.00 S.F.	\$7,200	1
LT9	HGH PRE-SOD PL			2.00 UNITS	\$2,400	1

**Valuation History**

Appraisal			
Valuation Year	Improvements	Land	Total
2023	\$294,000	\$206,100	\$500,100
2022	\$300,600	\$206,100	\$506,700
2021	\$300,600	\$206,100	\$506,700

Assessment			
Valuation Year	Improvements	Land	Total
2023	\$294,000	\$206,100	\$500,100
2022	\$300,600	\$206,100	\$506,700
2021	\$300,600	\$206,100	\$506,700

(c) 2024 Vision Government Solutions, Inc. All rights reserved.