

FOR SALE

420 John Fitch Blvd, South Windsor



DEMOGRAPHICS

POPULATION

1 mile: 2,422
3 miles: 37,584
5 miles: 148,649

HOUSEHOLDS

1 mile: \$122,835
3 miles: \$84,928
5 miles: \$82,071

AVE. HOUSEHOLD INCOME

1 mile: 970
3 miles: 14,327
5 miles: 58,389

FOR SALE: \$1,400,000 (4) BUILDINGS - 19,432 SF TOTAL ON 4.82 ACRES

- (3) Flex/Shop Industrial Buildings on 4.82 acres
- Building 1: 10,260 SF, 14' clear w/ (3) 14' over head doors w/ ability to add more
- Building 2: 3,360 SF, 14' clear w/ (1) 14' overhead door, (1) 12' overhead door
- Building 3: 4,300 SF, 13' 6" clear, 21' to eave w/ (1) 10x10 dock door w/ ability to add more
- (1) 1,512 SF Office Building
- Well, septic, propane and electric
- City water, sewer, and gas on road
- Zone: I
- Traffic Count: 24,800

Contact for Details:

SAM LYMAN

Phone
(860) 876-0359

Email
SL@retradeCRE.com

retrade

 (860) 600-4400 | (617) 600-4400  retradeCRE.com

FOR SALE: 420 JOHN FITCH BLVD, SOUTH WINDSOR

SURVEY

(4) BUILDINGS - 19,432 SF TOTAL ON 4.82 ACRES

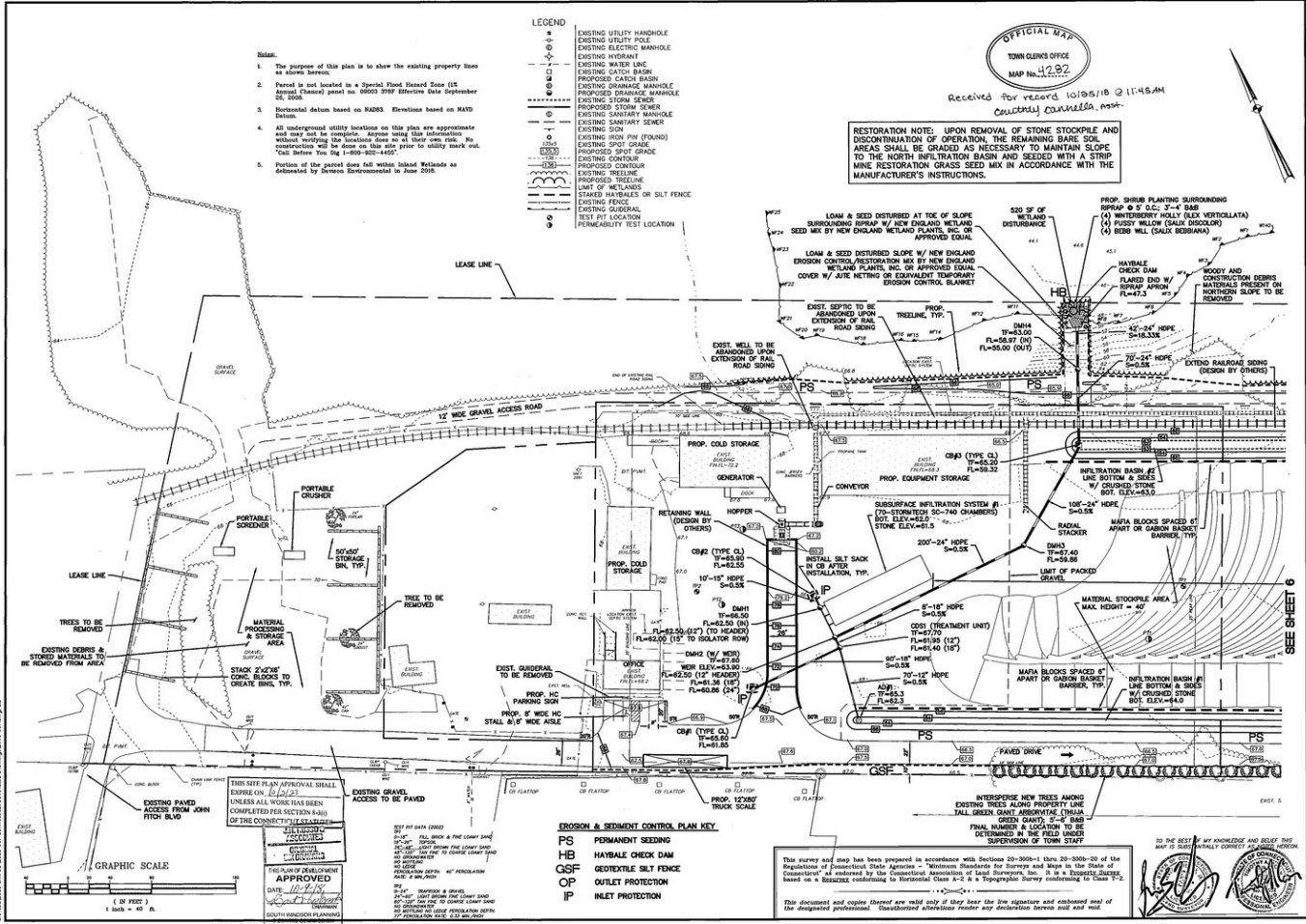

RUSSO
SURVEYING & ENGINEERING, INC.
1000 ROUTE 100
MANTONVILLE, CT 06455
Tel: 860-442-1111
Fax: 860-442-1112
www.russo-surveying.com

Dennis Botticello Trust
c/o Lillian Botticello & Hubert Botticello
1000 Main Street
Manchester, CT 06042

Connecticut Soil Realty LLC
420 John Fitch Boulevard
1462 Boston Post Road
Westbrook, Connecticut 06498

Site Plan
DATE: 10-15-18
SCALE: 1"=400'
JOB NUMBER: 2018-0008
SHEET: 5 OF 10

All information stated is from sources deemed reliable and is submitted subject to errors, commissions, changes of other terms and conditions, prior sales, financing or withdrawal without notice. Buyer/Tenant agents will be eligible for a portion of commission only if they have an existing signed representation.



(860) 600-4400 | (617) 600-4400 www.retradeCRE.com

FOR SALE: 420 JOHN FITCH BLVD, SOUTH WINDSOR

OTHER PHOTOGRAPHS

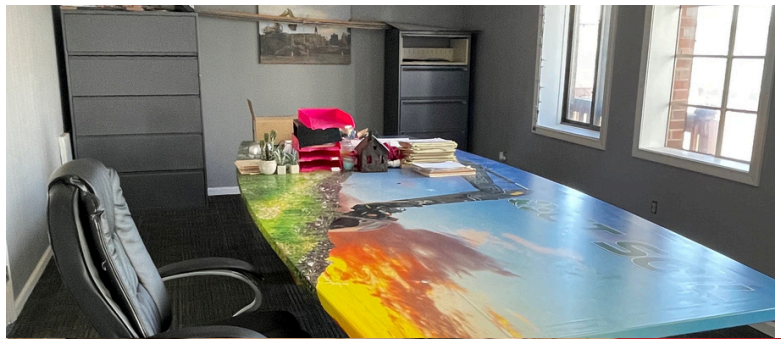

 (860) 600-4400 | (617) 600-4400  retradeCRE.com

FOR SALE: 420 JOHN FITCH BLVD, SOUTH WINDSOR