

# FOR LEASE | RETAIL SPACE

127 Marginal Way | Portland, ME

**PRICE REDUCED!**



## 3,040± SF RETAIL SPACE

- Join West Marine, Walgreens & SalonCentric
- Highly visible location with traffic counts of 12,540± cars/day AADT
- Directly opposite Trader Joe's entrance
- Great signage opportunities directly on Marginal Way pylon and building signage

**LEASE RATE: \$27.00/SF NNN**

**Based on 3,040± SF ground floor only**



**JOE MALONE, CCIM**  
207.773.2554 D  
207.233.8000 C  
joe@malonecb.com



**JENNIFER SMALL, CCIM**  
207.772.6871 D  
207.233.6872 C  
jennifer@malonecb.com

**MALONE COMMERCIAL BROKERS**  
5 Moulton Street • Suite 3  
Portland, ME 04101  
207.772.2422 • malonecb.com



# PROPERTY SUMMARY

127 Marginal Way | Portland, ME



**OWNER:** Back Cove Company

**DEED:** Book 7300, Page 235

**ASSESSOR:** Map 25, Block A, Lot 14

**LOT SIZE:** 1.62± AC

**BUILDING SIZE:** 27,554± SF

**SPACE SIZE:** 3,040± SF plus 1,000± SF mezzanine

**YEAR BUILT:** 1970

**CONSTRUCTION:** Brick & concrete block

**FLOORING:** Concrete

**HVAC:** One 4 ton single phase rooftop unit  
One 5 ton single phase rooftop unit  
Wired to tenant electric meters and  
tenant natural gas meter

**UTILITIES:** Municipal water & sewer

**SPRINKLER:** Yes

**SIGNAGE:** Marginal Way pylon signage and  
signage panels over entry

**PARKING:** 11± spaces allotted for tenant

**ZONING:** B3

**NNN EXPENSES:** \$8.43/SF

**LEASE RATE:** \$27.00/SF NNN based on 3,040± SF  
ground floor only



# FLOOR PLAN

127 Marginal Way | Portland, ME

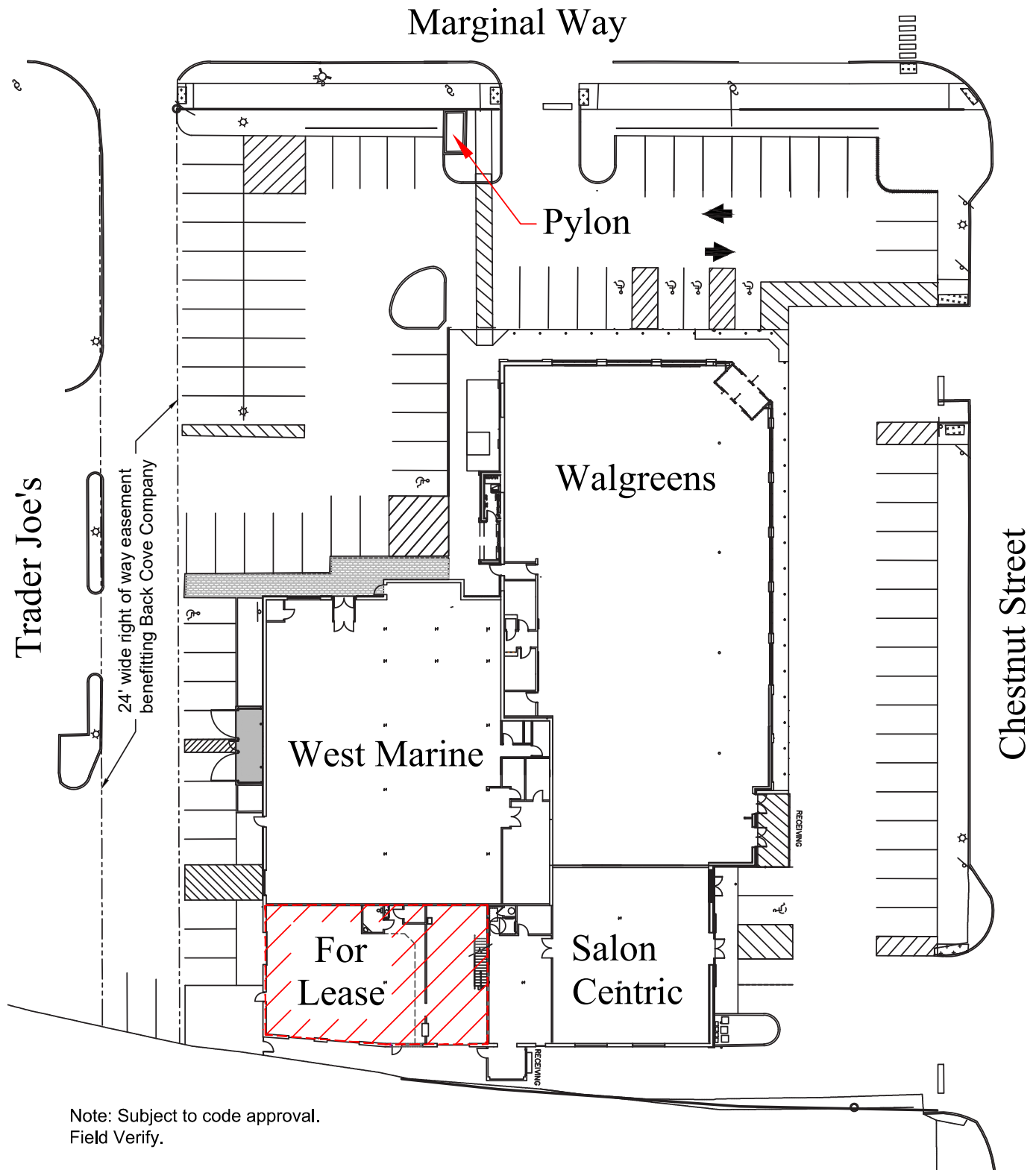



# FOR LEASE | RETAIL SPACE

## 127 Marginal Way | Portland, ME



Data SIO, NOAA, U.S. Navy, NGA, GEBCO

This document has been prepared by Malone Commercial Brokers for advertising and general information only. Malone Commercial Brokers makes no guarantees, representations or warranties of any kind, expressed or implied, regarding, but not limited to, warranties of content, accuracy, and reliability. Any interested party should undertake their own inquiries as to the accuracy of the information. Malone Commercial Brokers excludes unequivocally all informed or implied terms, conditions and warranties arising out of this document and excludes all liability for loss and damages therefrom. All data is subject to change of price, error, omissions, other conditions or withdrawal without notice. Malone Commercial Brokers is acting as the Seller's/Lessor's agent in the marketing of this property.



**JOE MALONE, CCIM**  
207.773.2554 D  
207.233.8000 C  
joe@malonecb.com



**JENNIFER SMALL, CCIM**  
207.772.6871 D  
207.233.6872 C  
jennifer@malonecb.com

**MALONE COMMERCIAL BROKERS**  
5 Moulton Street • Suite 3  
Portland, ME 04101  
207.772.2422 • malonecb.com