

AVAILABLE IMMEDIATELY

# RIVERSIDE BUSINESS CENTER | SUITE 200

1139 LEHIGH AVENUE, WHITEHALL, PA



**LEE & ASSOCIATES**  
COMMERCIAL REAL ESTATE SERVICES



## SUITE 200 FEATURES:

- 41,000 SF +/- of Industrial Space
- 18'+/- clear height
- 5 dock doors, 1 drive-in
- Ample truck parking
- LED lighting
- Heavy power - 4000 amp service
- Proximity to Routes 22, I-78 & PA Turnpike
- Lehigh Valley International Airport (ABE) less than 3 miles away

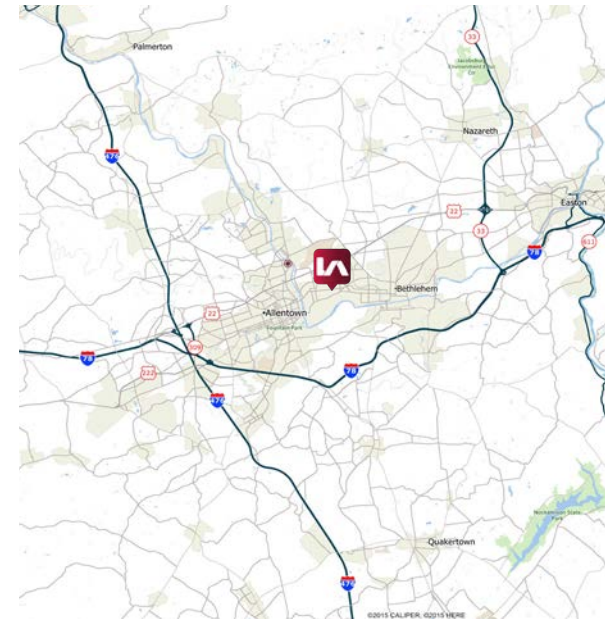

**BRIAN KNOWLES, SIOR, CCIM**  
bknowles@lee-associates.com  
610.400.0484

**MATT D'ALESIO**  
mdalesio@lee-associates.com  
610.947.1951

**LEE & ASSOCIATES OF EASTERN PENNSYLVANIA LLC**  
220 W. Germantown Pike, Suite 200, Plymouth Meeting, PA 19462 USA  
610.400.0499 | lee-associates.com/easternpa

All information furnished regarding property for sale, rental or financing is from sources deemed reliable, but no warranty or representation is made as to the accuracy thereof and same is submitted subject to errors, omissions, change of price, rental or other conditions prior to sale, lease or financing or withdrawal without notice. No liability of any kind is to be imposed on the broker herein.

AVAILABLE IMMEDIATELY

# RIVERSIDE BUSINESS CENTER | SUITE 200

1139 LEHIGH AVENUE, WHITEHALL, PA



**LEE & ASSOCIATES**  
COMMERCIAL REAL ESTATE SERVICES

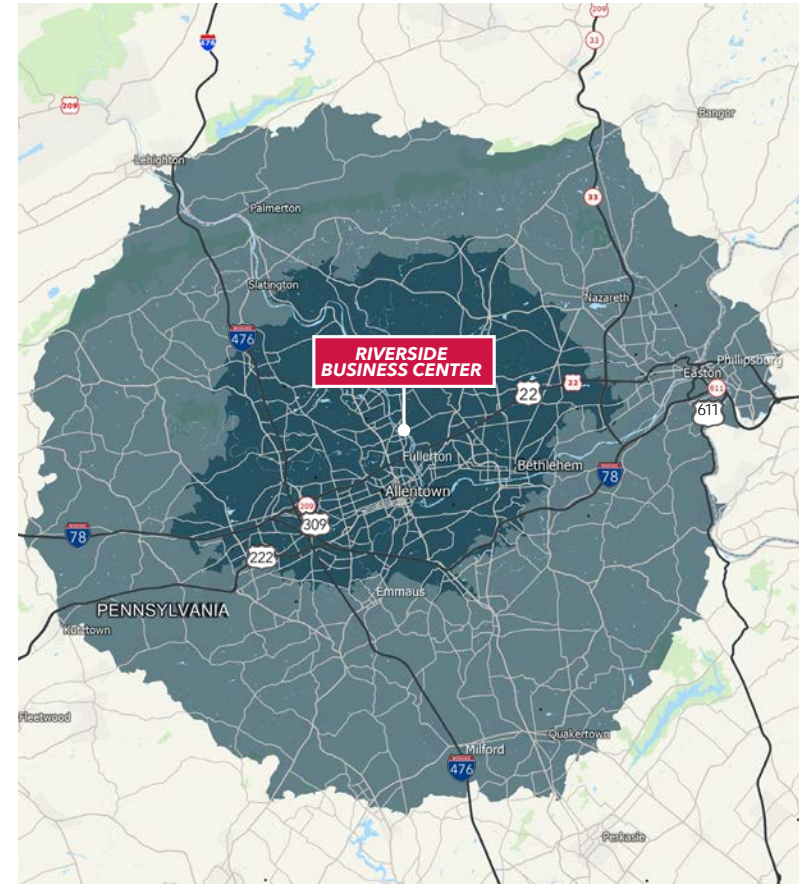
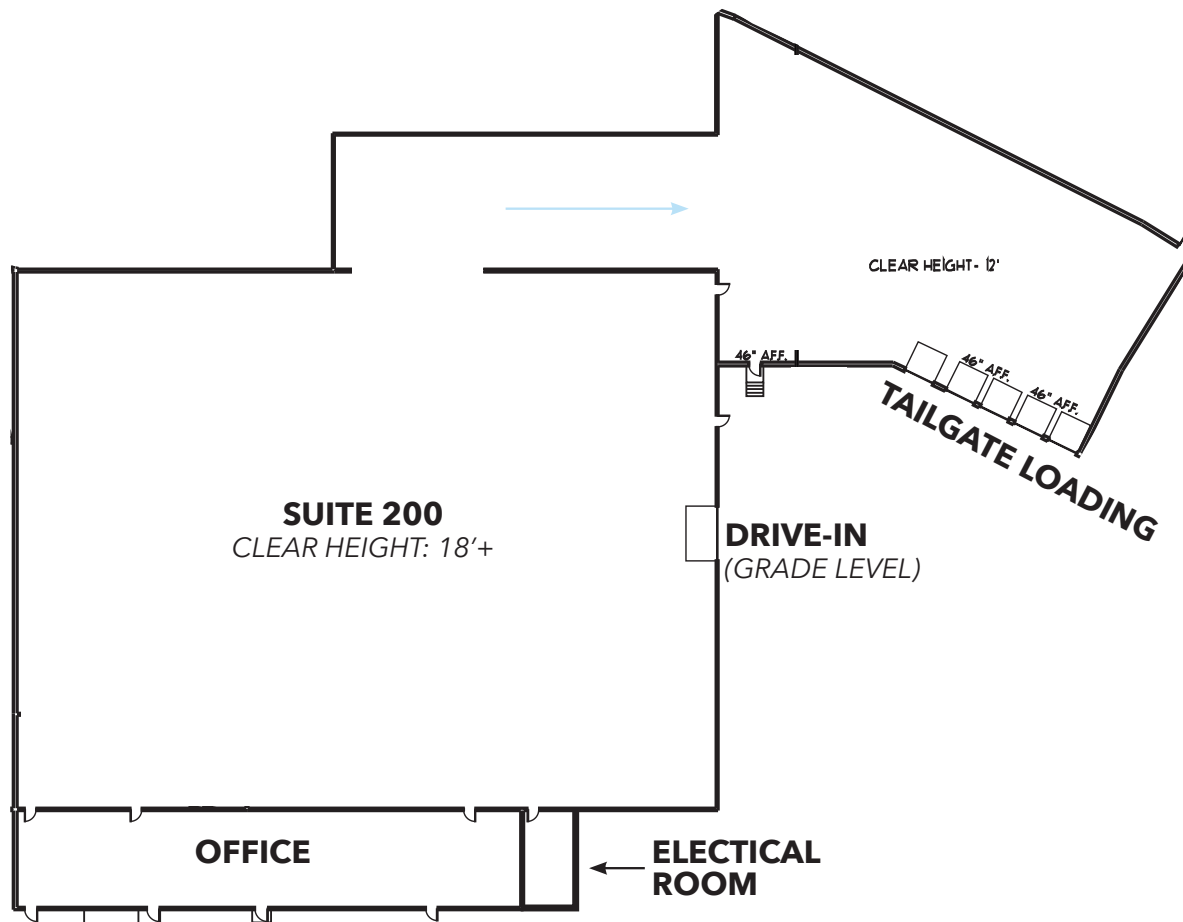

## POPULATION & LABOR

### 20 Mile Drive-Time

Population: 761,346

Workforce: 759,155

### 20 Minute Drive-Time

Population: 422,961

Workforce: 454,709



**BRIAN KNOWLES, SIOR, CCIM**  
bknowles@lee-associates.com  
610.400.0484

**MATT D'ALELIO**  
mdalesio@lee-associates.com  
610.947.1951

**LEE & ASSOCIATES OF EASTERN PENNSYLVANIA LLC**  
220 W. Germantown Pike, Suite 200, Plymouth Meeting, PA 19462 USA  
610.400.0499 | lee-associates.com/easternpa

All information furnished regarding property for sale, rental or financing is from sources deemed reliable, but no warranty or representation is made as to the accuracy thereof and same is submitted subject to errors, omissions, change of price, rental or other conditions prior to sale, lease or financing or withdrawal without notice. No liability of any kind is to be imposed on the broker herein.

AVAILABLE IMMEDIATELY

# RIVERSIDE BUSINESS CENTER | SUITE 200

1139 LEHIGH AVENUE, WHITEHALL, PA



**LEE & ASSOCIATES**  
COMMERCIAL REAL ESTATE SERVICES

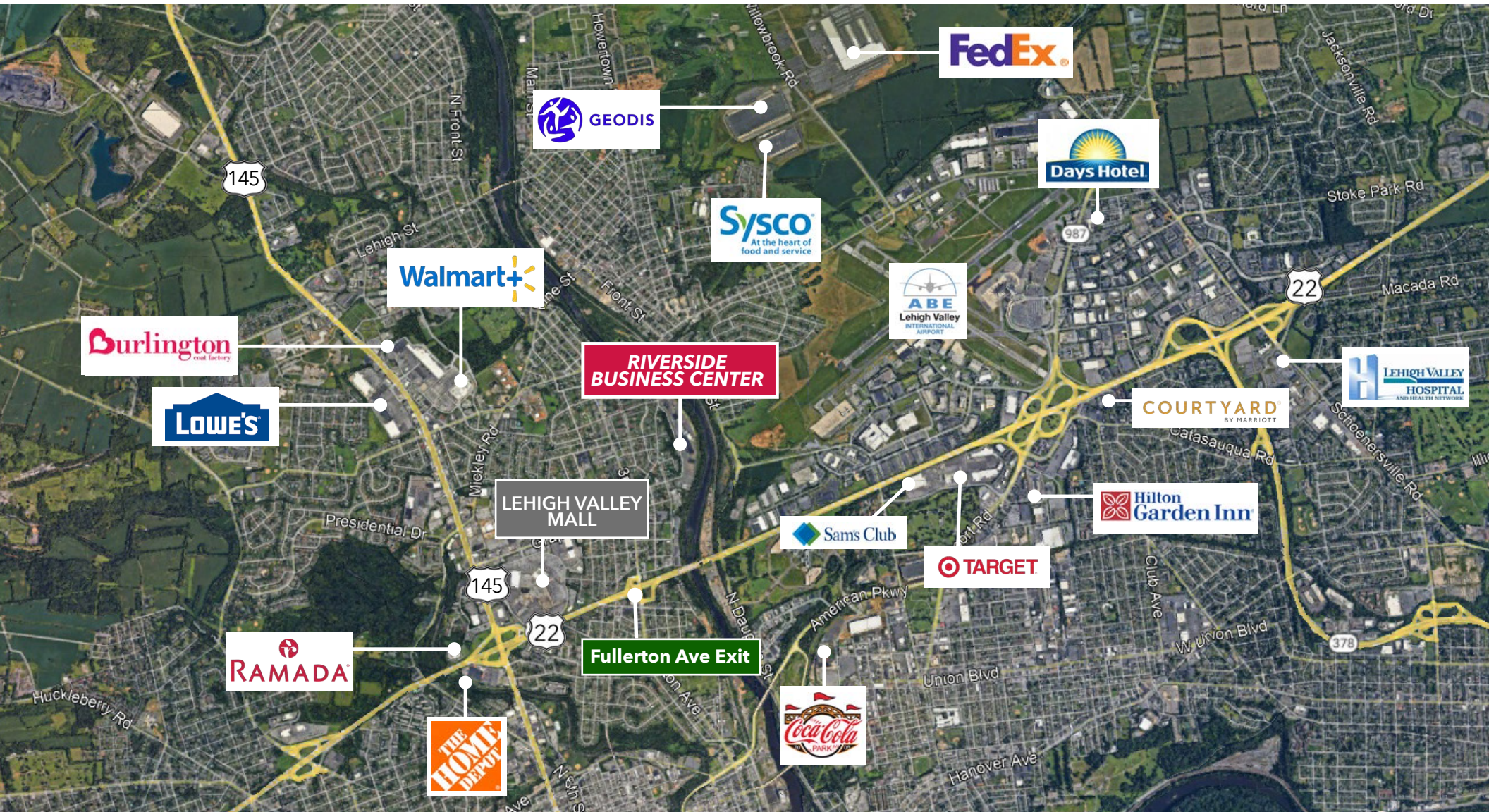

**LEE & ASSOCIATES**  
COMMERCIAL REAL ESTATE SERVICES

**BRIAN KNOWLES, SIOR, CCIM**  
bknowles@lee-associates.com  
610.400.0484

**MATT D'ALESIO**  
mdalesio@lee-associates.com  
610.947.1951

**LEE & ASSOCIATES OF EASTERN PENNSYLVANIA LLC**  
220 W. Germantown Pike, Suite 200, Plymouth Meeting, PA 19462 USA  
610.400.0499 | lee-associates.com/easternpa

All information furnished regarding property for sale, rental or financing is from sources deemed reliable, but no warranty or representation is made as to the accuracy thereof and same is submitted subject to errors, omissions, change of price, rental or other conditions prior to sale, lease or financing or withdrawal without notice. No liability of any kind is to be imposed on the broker herein.

AVAILABLE IMMEDIATELY

# RIVERSIDE BUSINESS CENTER | SUITE 200

1139 LEHIGH AVENUE, WHITEHALL, PA



**LEE & ASSOCIATES**  
COMMERCIAL REAL ESTATE SERVICES



**RIVERSIDE  
BUSINESS CENTER**

**LEE & ASSOCIATES**  
COMMERCIAL REAL ESTATE SERVICES

**BRIAN KNOWLES, SIOR, CCIM**  
bknowles@lee-associates.com  
610.400.0484

**MATT D'ALELIO**  
mdalesio@lee-associates.com  
610.947.1951

**LEE & ASSOCIATES OF EASTERN PENNSYLVANIA LLC**  
220 W. Germantown Pike, Suite 200, Plymouth Meeting, PA 19462 USA  
610.400.0499 | lee-associates.com/easternpa

All information furnished regarding property for sale, rental or financing is from sources deemed reliable, but no warranty or representation is made as to the accuracy thereof and same is submitted subject to errors, omissions, change of price, rental or other conditions prior to sale, lease or financing or withdrawal without notice. No liability of any kind is to be imposed on the broker herein.