

**FOR LEASE – Showroom/Warehouse**  
**3656 Eisenhower Parkway**  
**Macon, GA 31206**



Summary

Area Info

Photos

Aerial

Site Map



**LEASE PRICE: Suite 1 (Showroom/Warehouse) - \$8.00/SF GROSS**

**CONTACT**

**Patty Burns, CCIM, ALC**  
478-746-9421 Office  
478-951-5100 Cell  
patty@fickling.com

**Trip Wilhoit, CCIM, ALC**  
478-746-9421 Office  
478-960-4080 Cell  
trip@fickling.com



577 Mulberry St, Suite 1100  
Macon, GA 31201  
478.746.9421 Office  
<https://commercial.fickling.com>

**PROPERTY INFORMATION**

**BUILDING**

**Property Address:** 3656 Eisenhower Parkway  
 Macon, GA 31206

**County:** Bibb

**Total Size:** 89,500± SF

**Available:** **Suite 1 - 21,615 SF**

**Utilities:** All Available

**Parking:** Ample & Shared

**Traffic Count:** Eisenhower Parkway – 23,516

**SITE**

**Site Size:** 4.79 AC

**Parcel ID:** N083-0128

**Zoning:** C-2 (Commercial)

**LEASE PRICE:**

**Suite 1 (Showroom/Warehouse) - \$8.00/SF GROSS**

Demographics 2023	3 Miles	5 Miles	10 Miles
Population	52,207	88,018	168,425
Avg HH Income	\$44,613	\$68,432	\$83,094
Median Age	35.2	35.5	37.0

**CONTACT**

**Patty Burns, CCIM, ALC**  
 478-746-9421 Office  
 478-951-5100 Cell  
 patty@fickling.com

**Trip Wilhoit, CCIM, ALC**  
 478-746-9421 Office  
 478-960-4080 Cell  
 trip@fickling.com



577 Mulberry St, Suite 1100  
 Macon, GA 31201  
 478.746.9421 Office  
<https://commercial.fickling.com>

# FOR LEASE – Showroom/Warehouse

3656 Eisenhower Parkway  
Macon, GA 31206



Summary

Area Info

Photos

Aerial

Site Map

## PROPERTY INFORMATION

### NOTES

21,615 SF Showroom/Warehouse available for lease. Suite is located in a multi-tenant building. Other tenants include Haverty's Furniture, Haverty's Outlet, and Grid Chiropractic.



### LOCATION

Located in a high traffic location on Eisenhower Parkway. Property is very conveniently located minutes away from Interstate 75 and Interstate 475. Surrounding neighbors include The Macon Mall, Central Georgia Technical College, Lowe's Atrium Health Amphitheater, Sam's Club, Kroger, Best Buy, Walmart, Aldi, Home Depot, Farmer's Home Furniture, Zaxby's, Chick-fil-A, Cookout, and many more retailers and restaurants.

### CONTACT

**Patty Burns, CCIM, ALC**  
478-746-9421 Office  
478-951-5100 Cell  
patty@fickling.com

**Trip Wilhoit, CCIM, ALC**  
478-746-9421 Office  
478-960-4080 Cell  
trip@fickling.com



577 Mulberry St, Suite 1100  
Macon, GA 31201  
478.746.9421 Office  
<https://commercial.fickling.com>

# FOR LEASE – Showroom/Warehouse

3656 Eisenhower Parkway  
Macon, GA 31206



Summary

Area Info

Photos

Aerial

Site Map



## CONTACT

**Patty Burns, CCIM, ALC**  
478-746-9421 Office  
478-951-5100 Cell  
[patty@fickling.com](mailto:patty@fickling.com)

**Trip Wilhoit, CCIM, ALC**  
478-746-9421 Office  
478-960-4080 Cell  
[trip@fickling.com](mailto:trip@fickling.com)



577 Mulberry St, Suite 1100  
Macon, GA 31201  
478.746.9421 Office  
<https://commercial.fickling.com>

# FOR LEASE – Showroom/Warehouse

## 3656 Eisenhower Parkway

### Macon, GA 31206



Summary

Area Info

Photos

Aerial

Site Map



#### CONTACT

**Patty Burns, CCIM, ALC**  
 478-746-9421 Office  
 478-951-5100 Cell  
[patty@fickling.com](mailto:patty@fickling.com)

**Trip Wilhoit, CCIM, ALC**  
 478-746-9421 Office  
 478-960-4080 Cell  
[trip@fickling.com](mailto:trip@fickling.com)



577 Mulberry St, Suite 1100  
 Macon, GA 31201  
 478.746.9421 Office  
<https://commercial.fickling.com>

**FOR LEASE – Showroom/Warehouse**  
**3656 Eisenhower Parkway**  
**Macon, GA 31206**



Summary

Area Info

Photos

Aerial

Site Map

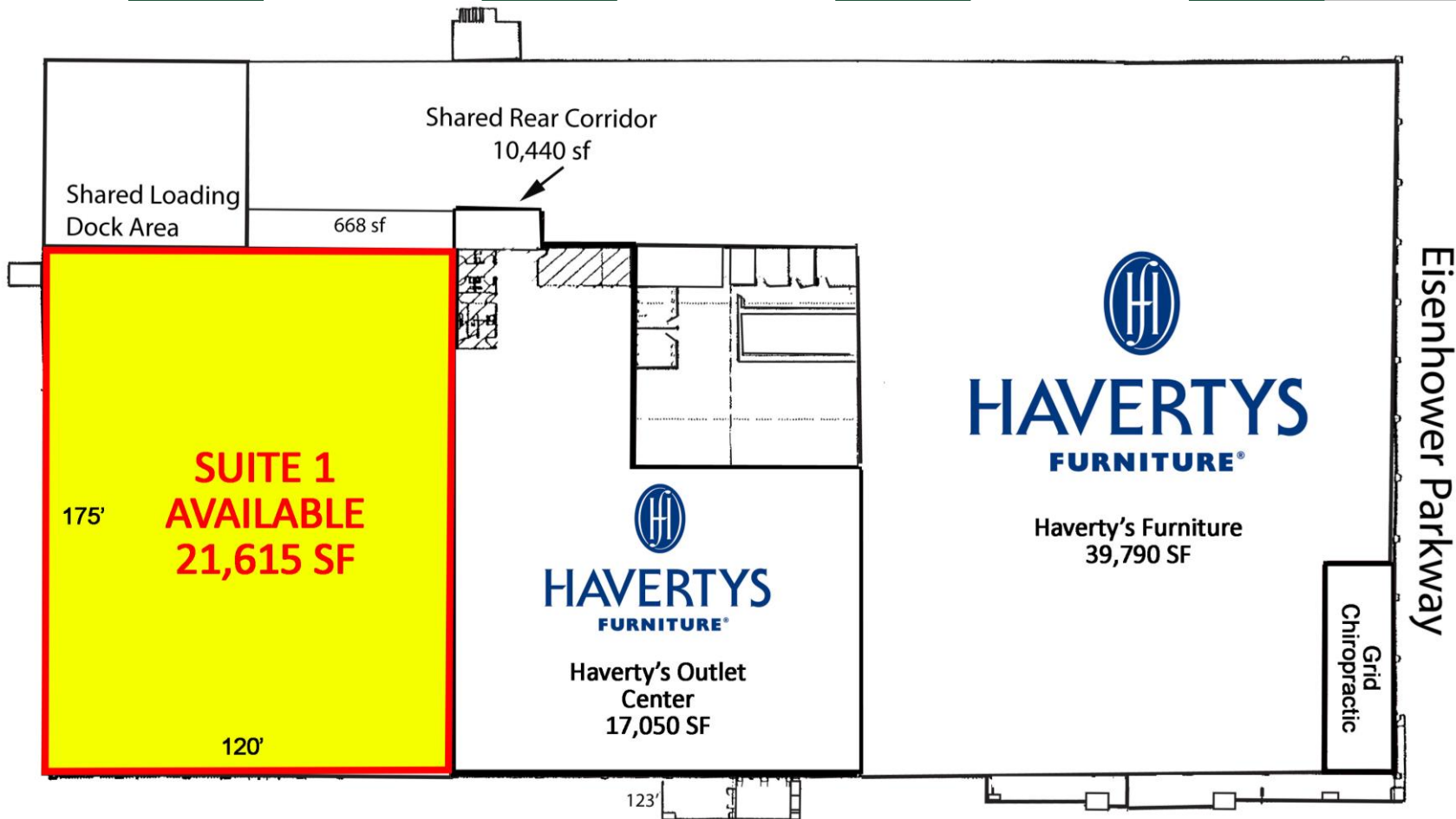

**CONTACT**

**Patty Burns, CCIM, ALC**  
478-746-9421 Office  
478-951-5100 Cell  
patty@fickling.com

**Trip Wilhoit, CCIM, ALC**  
478-746-9421 Office  
478-960-4080 Cell  
trip@fickling.com



577 Mulberry St, Suite 1100  
Macon, GA 31201  
478.746.9421 Office  
<https://commercial.fickling.com>