

COMMERCE PARK

OFFICE & RETAIL SPACE AVAILABLE

13137 UNIVERSITY AVENUE

CLIVE, IA 50325

FOR LEASE



WEST ELEVATION

PROPERTY FEATURES

- ◆ 1,736 SF of Office/Retail Available For Lease
- ◆ New Construction April 2023 - Located Within Commerce Park on University Avenue in Clive
- ◆ Building and Monument Signage Available
- ◆ Ample Parking
- ◆ Strong Tenant Mix in Commerce Park Includes: Raymond James, Iowa Lottery, Hove Family Dental, West End Chiropractic, WB Realty Co, Agave Grill Mexican Restaurant, Golftec and More
- ◆ Daily Traffic Counts (2018)
 - 21,600 VPD - University Avenue

AVAILABLE SUITES

SUITE	SF	RATE (NNN)	COMMENTS
Lower Level Ste #1	LEASED	LEASED	LEASED
Lower Level Ste #2	LEASED	LEASED	Sinclair Brothers
Lower Level Ste #3	LEASED	LEASED	Sinclair Brothers
Lower Level Ste #4	1,736 SF	\$13.00 PSF	Office/Retail Space Now Available
Lower Level Ste #5	LEASED	LEASED	LEASED
1st Level Ste #6 - #10	LEASED	LEASED	Raymond James
2nd Level Ste #8	LEASED	LEASED	Raymond James

CONTACT US

REID TAMISIEA

Agent

📞 515.721.9115 (c)

✉ reid@cdmres.com



CDM[®]
REAL ESTATE
SERVICES

BUY ♦ SELL ♦ LEASE ♦ DEVELOP ♦ MANAGE ♦ CONSULT

3035 99th Street, Urbandale, Iowa 50322 | www.cdmres.com

COMMERCE PARK

OFFICE & RETAIL SPACE AVAILABLE

13137 UNIVERSITY AVENUE

CLIVE, IA 50325

FOR LEASE



Demographics Est. (2023)	1 mile	3 miles	5 miles
Population	3,761	42,800	102,212
Households	4,394	28,464	53,666
Avg. HH Income	\$102,247	\$105,916	\$95,786
Median HH Income	\$96,890	\$101,348	\$89,396



CDM[®]
REAL ESTATE
SERVICES

3035 99th Street
Urbandale, Iowa 50322
515.901.3403

PAGE 2

www.cdmres.com

Updated 05/28/2024

2024 Platinum Real Estate, LLC d|b|a CDM Real Estate Services. We obtained the information herein from the Property Owner or other sources we believe to be reliable, however it is not verified or warranted to its accuracy and may change or be updated without notice. Property Owner | Seller | Landlord makes no representation as to the environmental condition of the property and recommends purchaser's or tenant's independent investigation. Images herein are property of the Property Owner or Listing Agent. Use of these images are restricted without the proper approval from the Property Owner and/or Listing Agent.

COMMERCE PARK

OFFICE & RETAIL SPACE AVAILABLE

13137 UNIVERSITY AVENUE

CLIVE, IA 50325

FOR LEASE

EAST ELEVATION - Upper Level

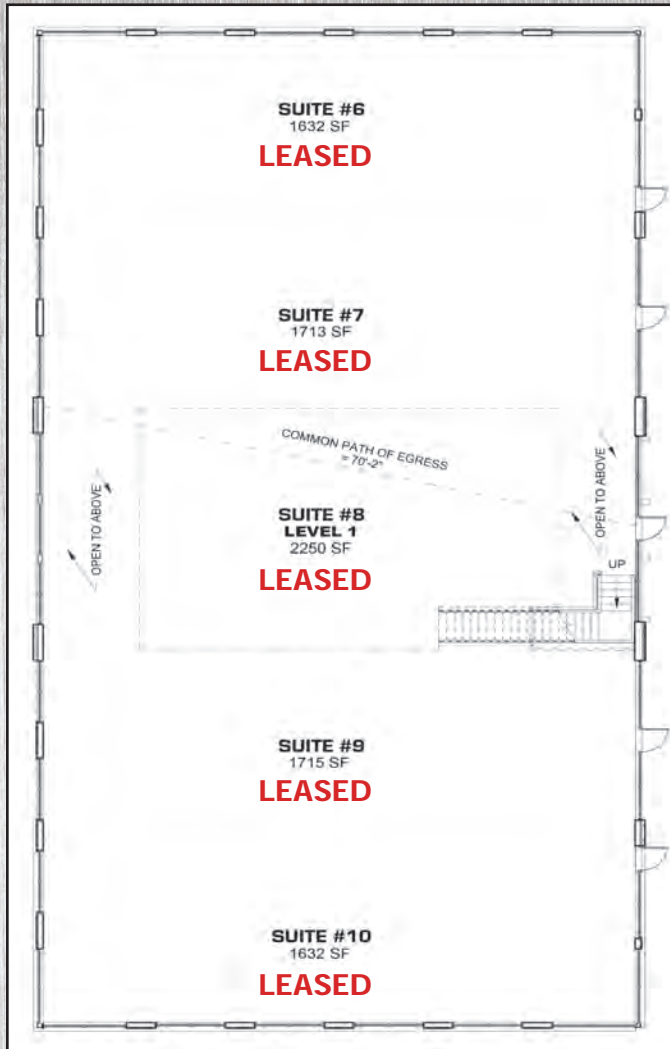

WEST ELEVATION - Lower Level

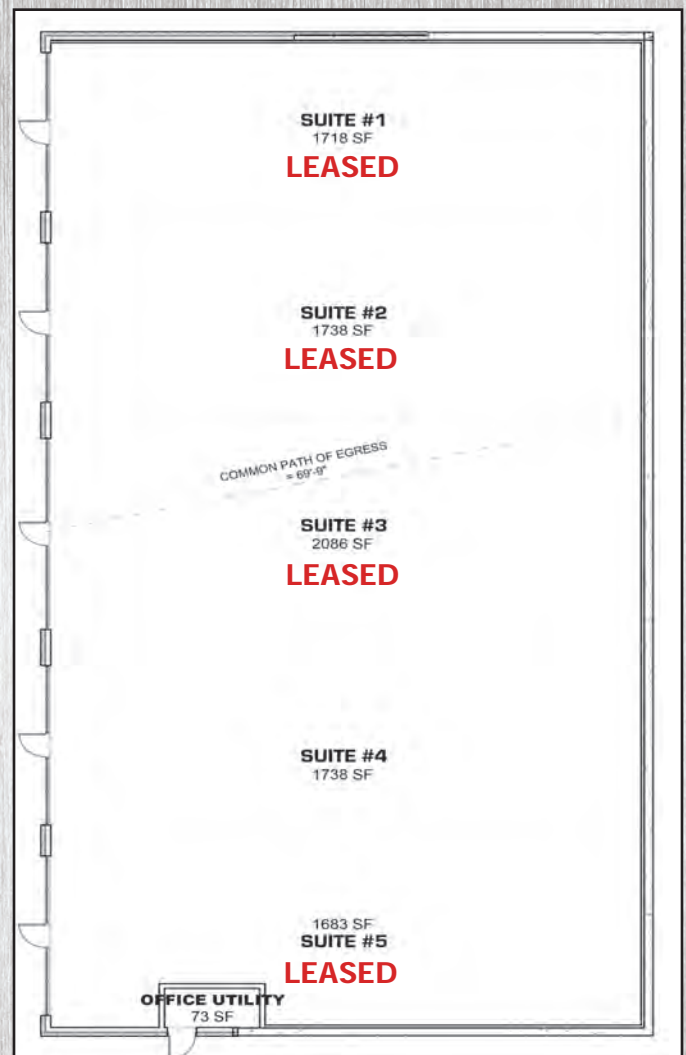

CDM[®]
REAL ESTATE
SERVICES



3035 99th Street
Urbandale, Iowa 50322



515.901.3403

PAGE 3

Updated 05/28/2024

www.cdmres.com

2024 Platinum Real Estate, LLC d|b|a CDM Real Estate Services. We obtained the information herein from the Property Owner or other sources we believe to be reliable, however it is not verified or warranted to its accuracy and may change or be updated without notice. Property Owner | Seller | Landlord makes no representation as to the environmental condition of the property and recommends purchaser's or tenant's independent investigation. Images herein are property of the Property Owner or Listing Agent. Use of these images are restricted without the proper approval from the Property Owner and/or Listing Agent.