

THE RINGSIDE SEATS **OF** **RETAIL SPACE**



**1,796 SF Ground Floor and 1,200 SF Mezzanine
Available for Lease**

370 7TH AVENUE | 7 PENN PLAZA

- 1,796 SF ground floor and 1,200 SF mezzanine (Former Starbucks space)
- Across the street from Madison Square Garden and Penn Station train station which serves 600,000 riders per day
- Area developments include Moynihan Station, Hudson Yards, MTA's East Side Access project (LIRR extension)
- Join building tenants Sweetgreen, Oakberry, Naya Express, Smashburger, and PopUp Bagels

370 7TH AVENUE | 7 PENN PLAZA

1,796 SF Ground Floor and 1,200 SF Mezzanine Available for Lease

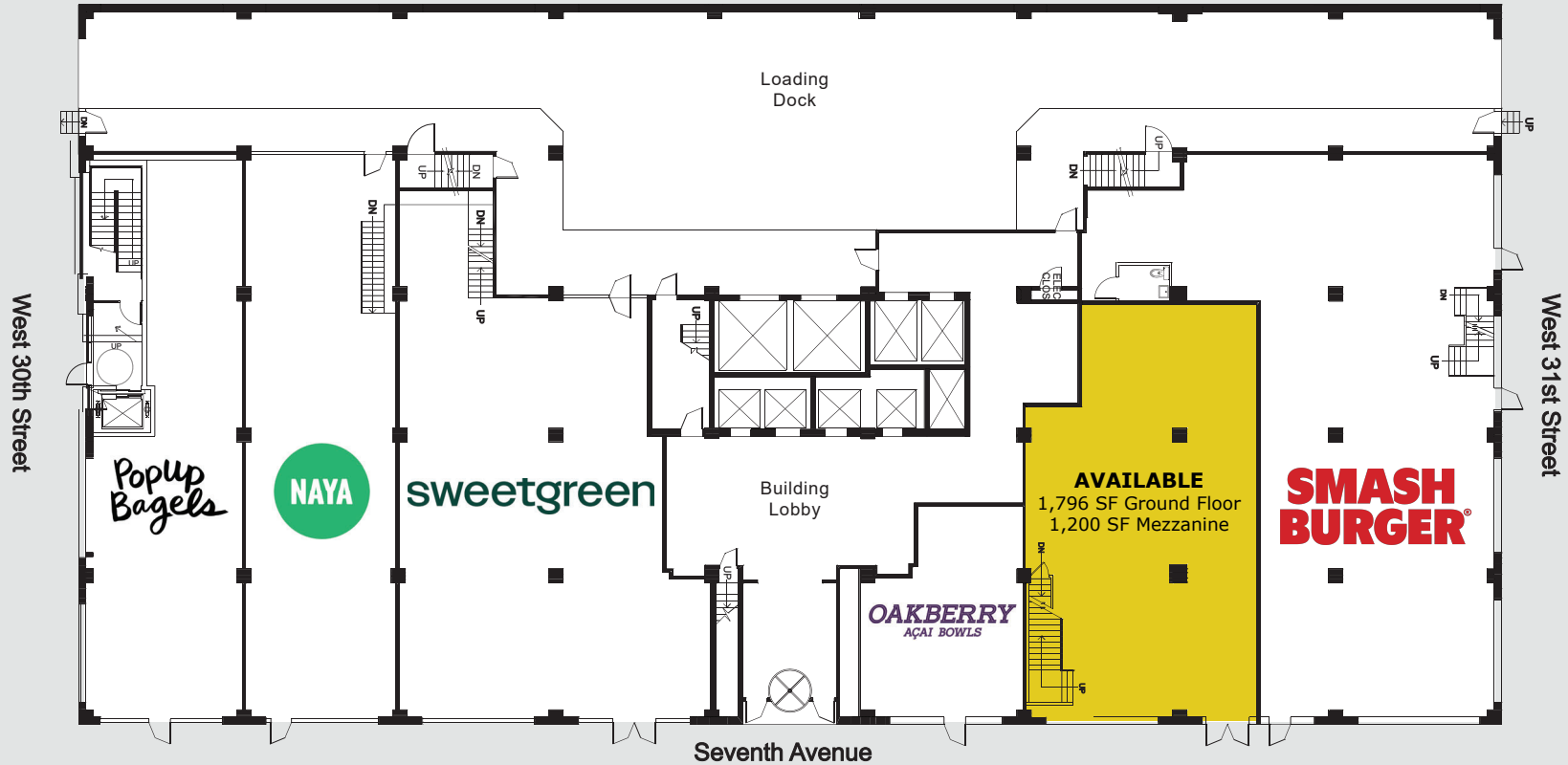

MADISON SQUARE
GARDEN

**PENN
STATION**

FEIL.COM

Feil

Contact: Randall Briskin | rbriskin@feil.com | (212) 563-6557 or
Jordan Goldblum | jgoldblum@feil.com | (212) 279-7600 ext. 287

370 7TH AVENUE | 7 PENN PLAZA



FEIL.COM

Feil

Contact: Randall Briskin | rbriskin@feil.com | (212) 563-6557 or
Jordan Goldblum | jgoldblum@feil.com | (212) 279-7600 ext. 287