



FOR LEASE | Retail
 10901 NE 23rd St.
 Oklahoma City, OK 73141



FOR LEASE | Retail

Located off NE 23rd & N Westminster Rd., this 3,825 SF divisible space has great road frontage and has an open floorplan for any retail or restaurant business. With an additional space added onto the back which could easily be turned into a kitchen, this space offers great flexibility. A fenced off yard is also located on the right side of the suite for additional outdoor seating if desired.

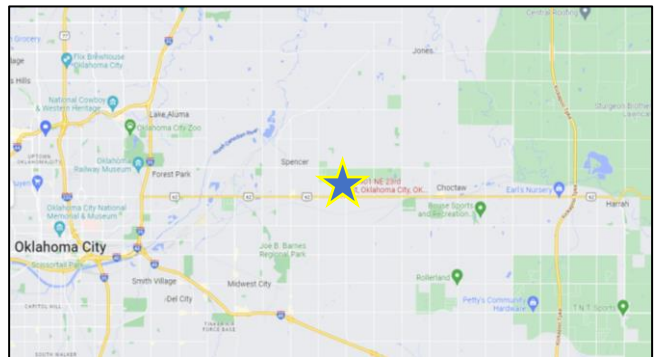

Lease Price	\$12.55 / SF
Availability	2,000 - 3,825 SF
Use	Retail
Market	E OKC / Nicoma Park

Alex Waugh
 405.714.7658
 alex@elevationcre.com

www.elevationcre.com
 @ElevationCRE
 @ElevationCRE
 @ElevationCRE
[LinkedIn.com/company/ElevationCRE](https://www.linkedin.com/company/ElevationCRE)