



### 72 Glenmaura National Boulevard Moosic, Pennsylvania

- 2,235± RSF
- Gross Lease Offered
- 3 offices, 1 conference room, reception, break room/kitchen, large area for cubicles.
- Corporate Office Sublet with Reasonable Rates
- Class A Finishes
- Located Near Montage Mountain Resort
- Easy Access To I-81 At Davis St Exit
- Amenities Nearby Include The Shoppes At Montage, Yankees AAA /Railriders Stadium, Gas/Cstore, etc.



769 Keystone Industrial Park Road

Throop, PA 18512

info@hinerfeldcommercial.com

**IREM**  
INSTITUTE OF REAL ESTATE MANAGEMENT

**BOMA**  
International



**SIOR**

**CCIM**

**ICSC**  
MEMBER

570-207-4100

www.hinerfeldcommercial.com

REALTORS

1934

SINCE 1934

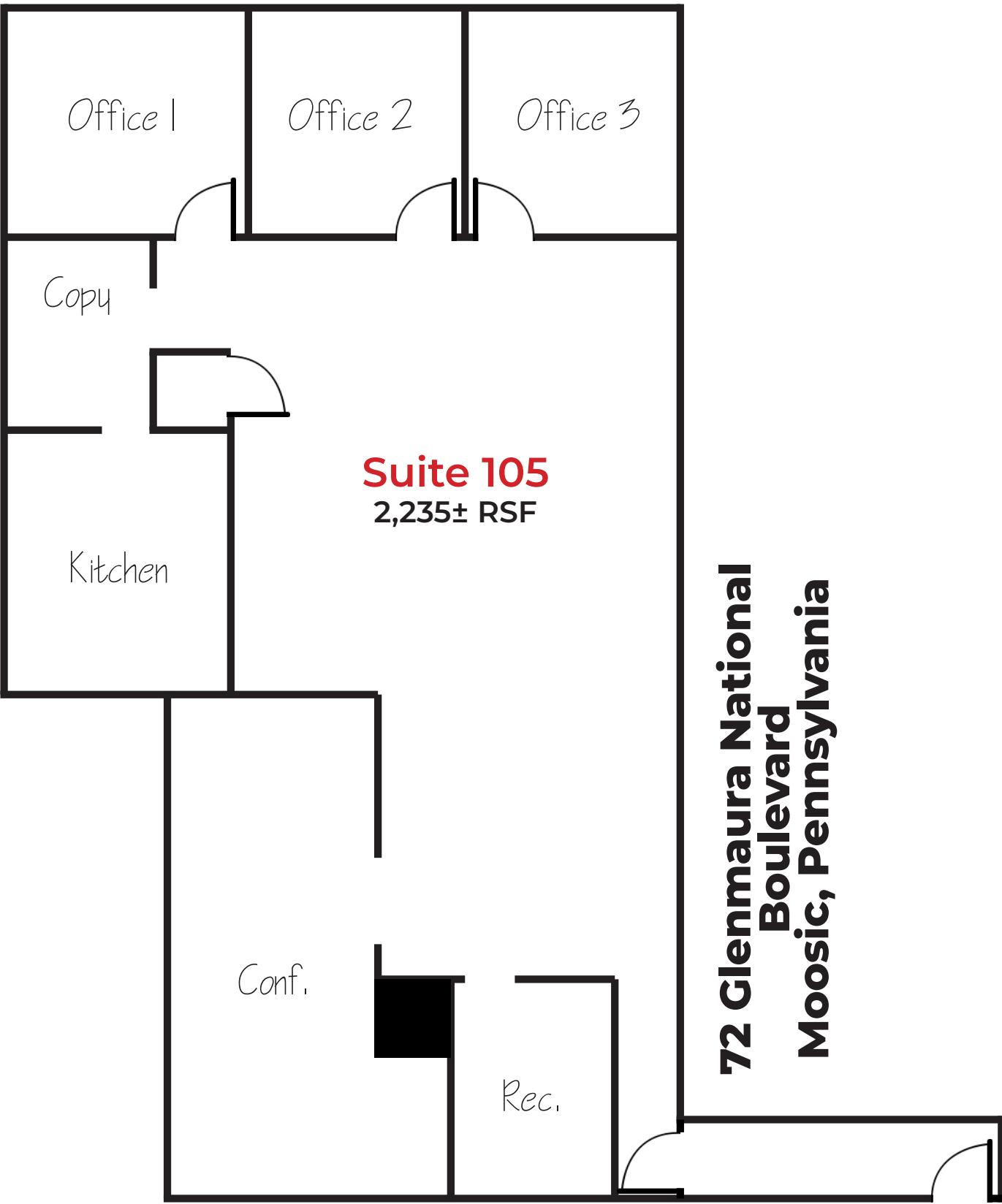

**72 Glenmaura National  
Boulevard  
Moosic, Pennsylvania**