



B.S.E. CONSULTANTS, INC.
CONSULTING - ENGINEERING -
LAND SURVEYING

312 SOUTH HARBOR CITY BOULEVARD, SUITE 4
MELBOURNE, FLORIDA 32951
PHONE: (321) 726-3074 FAX: (321) 723-1159
CERTIFICATE OF PROFESSIONAL ENGINEERS
BUSINESS AUTHORIZATION: 4905
CERTIFICATE OF LAND SURVEYING
BUSINESS AUTHORIZATION: LB004905

SCOTT M. GALBITZ, P.E. & P.L.S.
STATE OF FLORIDA, No. 33059 No. 4191

HASSAN A. KAMAL, P.E.
STATE OF FLORIDA, No. 41951

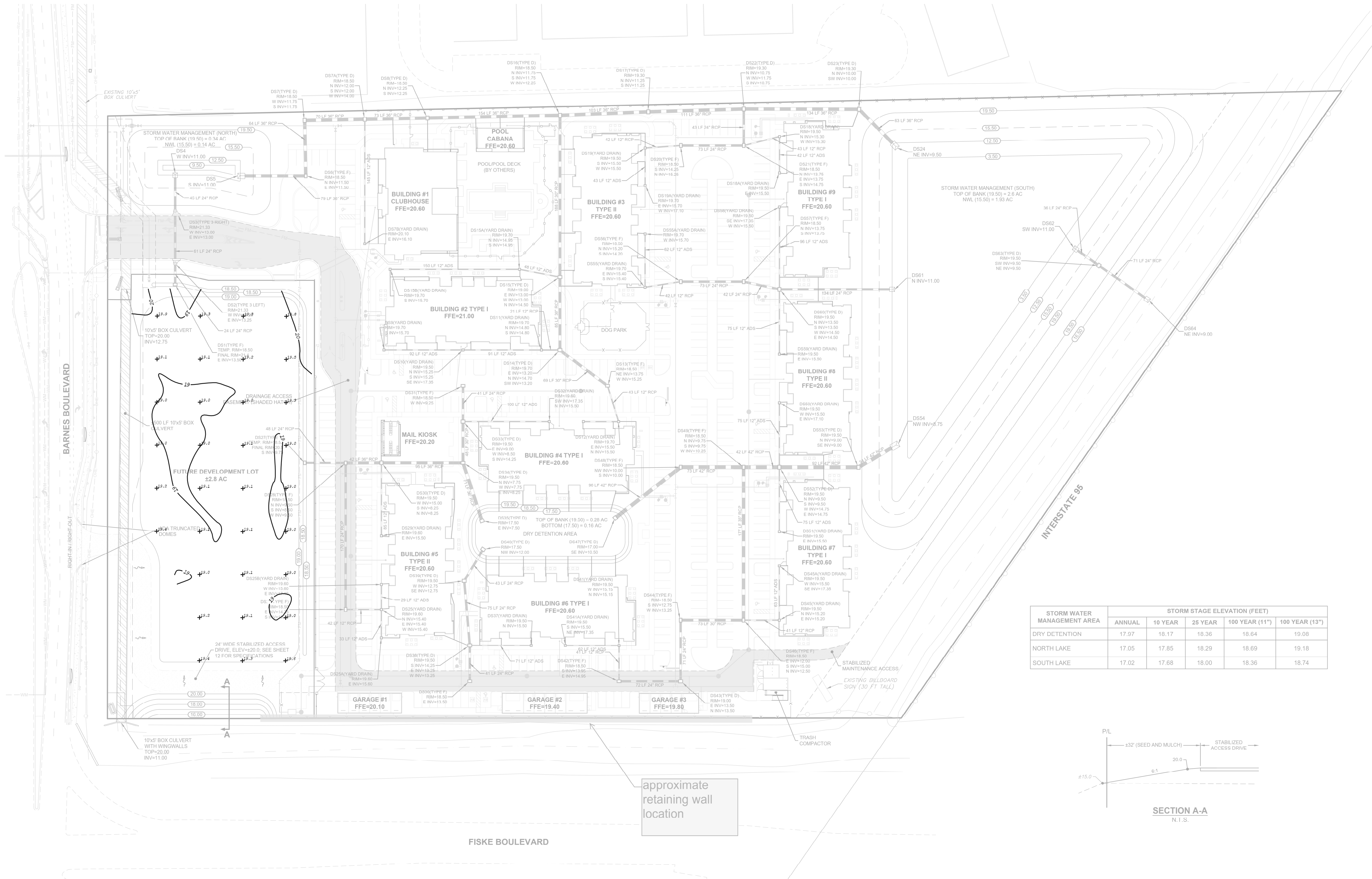

STORM WATER MANAGEMENT AREA	STORM STAGE ELEVATION (FEET)				
	ANNUAL	10 YEAR	25 YEAR	100 YEAR (11")	100 YEAR (13")
DRY DETENTION	17.97	18.17	18.36	18.64	19.08
NORTH LAKE	17.05	17.85	18.29	18.69	19.18
SOUTH LAKE	17.02	17.68	18.00	18.36	18.74

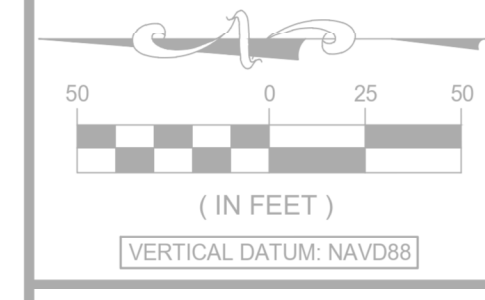

CLUBHOUSE FIRE LINE	11/01/22
DOWNSPOUT CONNECTIONS	04/21/22
CITY COMMENTS	03/04/22
FIRE MM	01/02/22
SJRWMD REVISION	01/26/22
CITY COMMENTS	12/20/21
DATE:	08/18/21
DESIGN/DRAWN:	ALS/DRB

PROJECT TITLE

**ASCEND
ROCKLEDGE**

SHEET TITLE

**OVERALL PAVING,
GRADING, AND
DRAINAGE PLAN**

PROJECT NO.
11594

DRAWING NO.
11594_400_008

SHEET
8 of 26

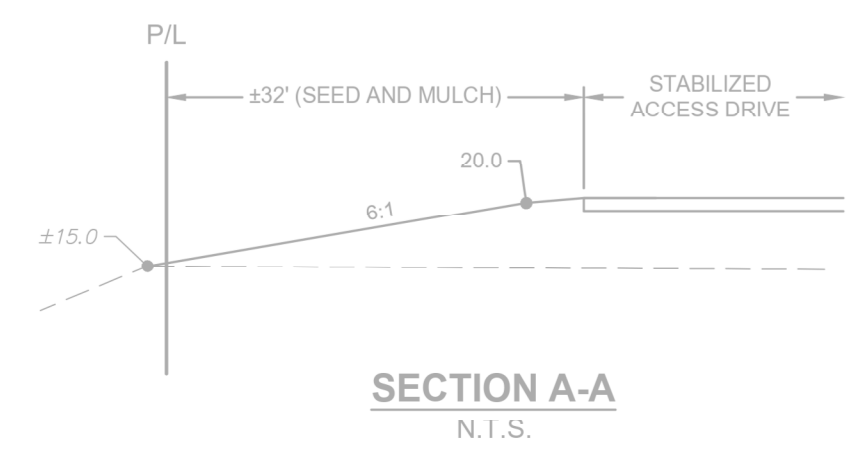

approximate retaining wall location

H:\Projects\Fiddler\11594\Drawings\11594_400_008.dwg November 8, 2022 12:26:35 PM DB