

# FOR LEASE

Retail or Office | +/-25,000- 50,000 Square Feet



## 200 Town Center East | Santa Maria, CA

- El Super Grocery Store anchored building
- Being completely remodeled
- Surrounded by new residential projects
- Co-Tenants include Macy's and Regal Cinema

Chris Garner

805.928.2800 ext. 104

CGarner@PacificaCRE.com

Lic #01010310

Brian LaCabe

805.928.2800 ext. 103

BLaCabe@PacificaCRE.com

Lic #01026699



PO Box 250 | Santa Maria, CA 93456 | [PacificaCommercialRealty.com](http://PacificaCommercialRealty.com)

Information contained herein has been obtained from the owner of the property or from other sources deemed reliable. We have no reason to doubt its accuracy, but we do not guarantee it.

# FOR LEASE 200 Town Center East | Santa Maria, CA

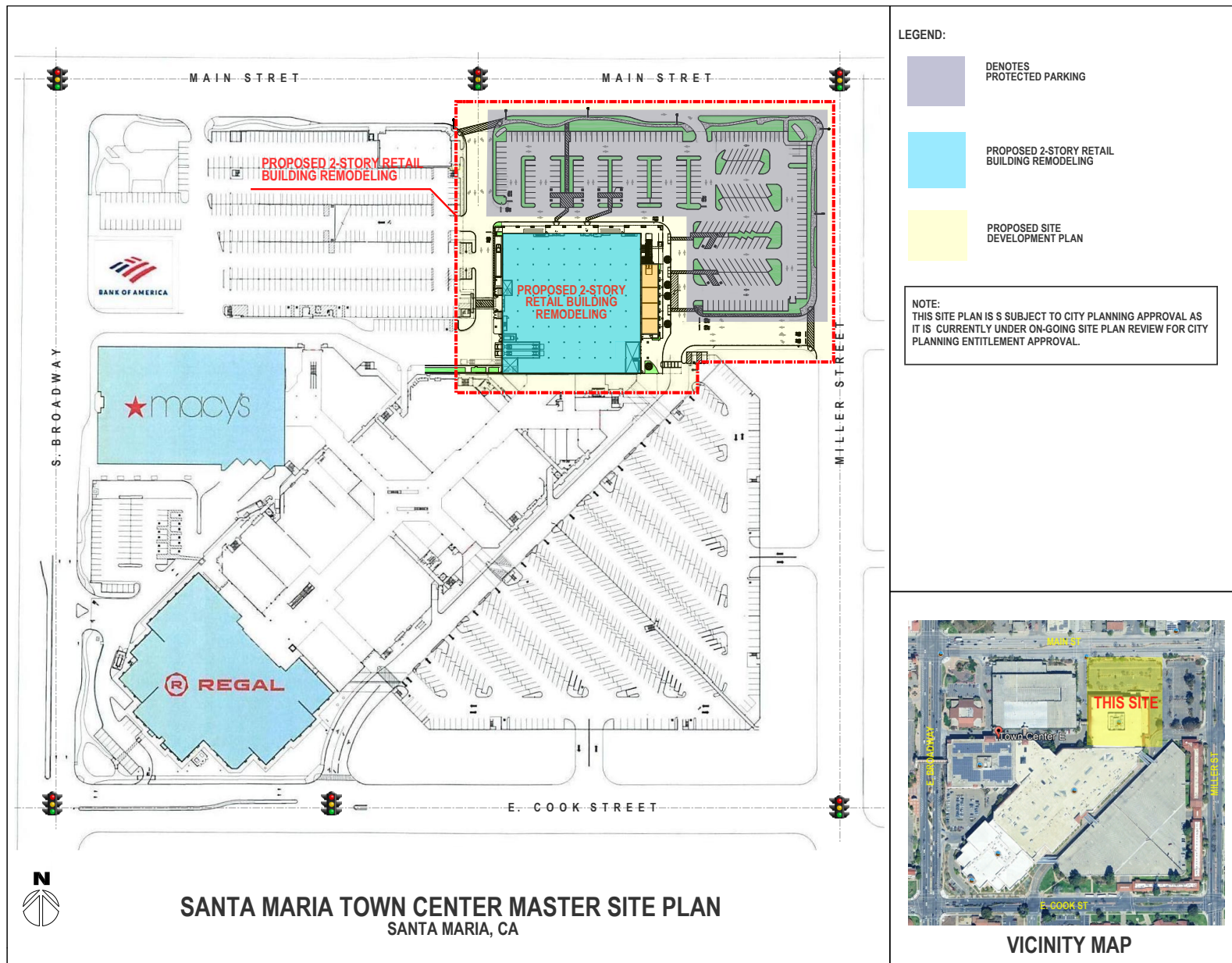



# FOR LEASE

200 Town Center East | Santa Maria, CA



## VICINITY MAP

### Lease Details

- Lease Price: \$1.25/SF/Month, NNN
- Estimated NNN: TBD
- TIA: TBD

### Property Details

- Building Size: +/-25,000 to 50,000 SF
- Space Location: All or part of the 2nd Floor
- Estimated Delivery: Late Q4 2025
- Delivery Condition: Improved Grey Shell
- Zoning: PD-C2

Chris Garner

805.928.2800 ext. 104

CGarner@PacificaCRE.com

Lic #01010310

Brian LaCabe

805.928.2800 ext. 103

BLaCabe@PacificaCRE.com

Lic #01026699



PO Box 250 | Santa Maria, CA 93456 | PacificaCommercialRealty.com

Information contained herein has been obtained from the owner of the property or from other sources deemed reliable. We have no reason to doubt its accuracy, but we do not guarantee it.



# FOR LEASE 200 Town Center East | Santa Maria, CA

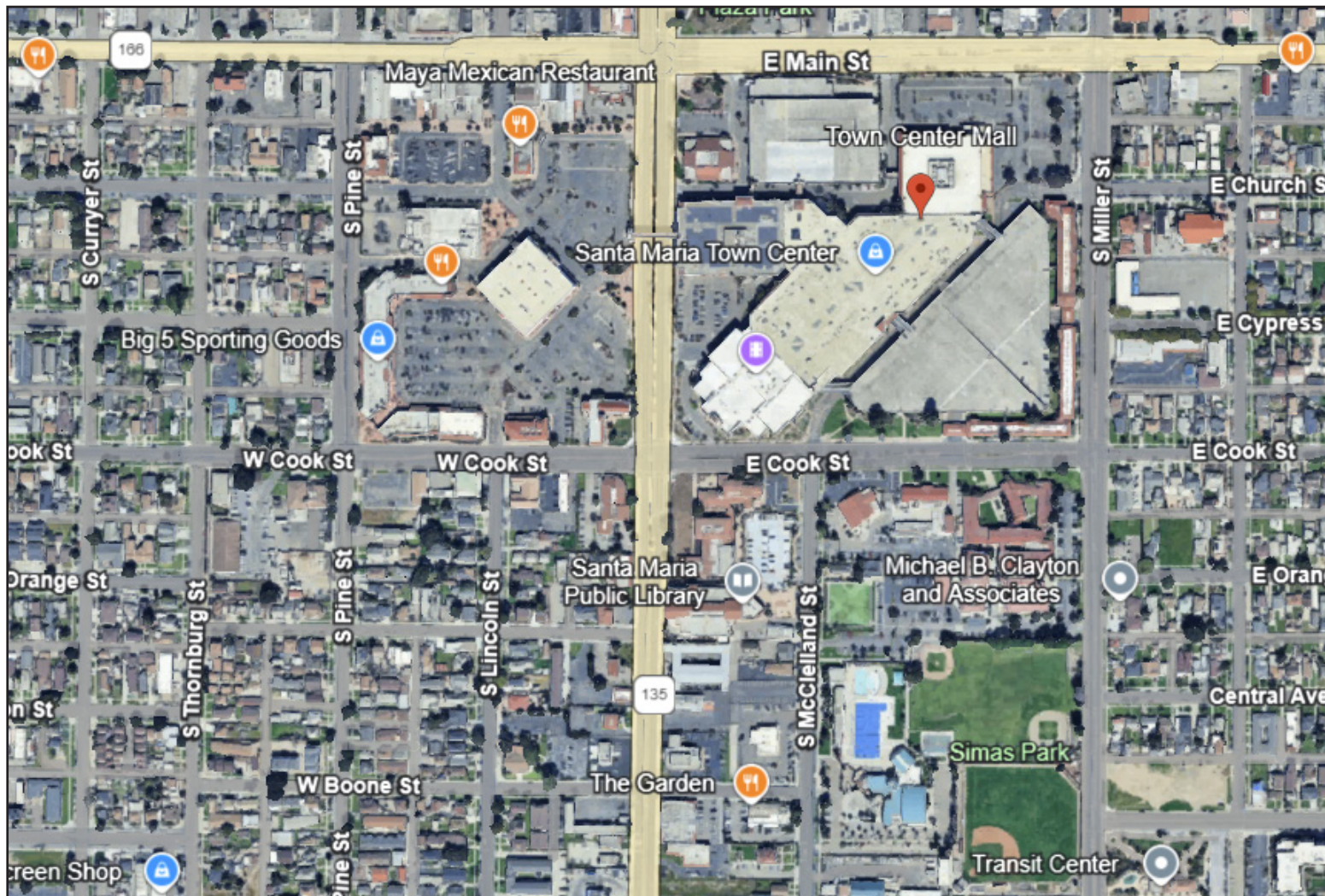

# FOR LEASE 200 Town Center East | Santa Maria, CA

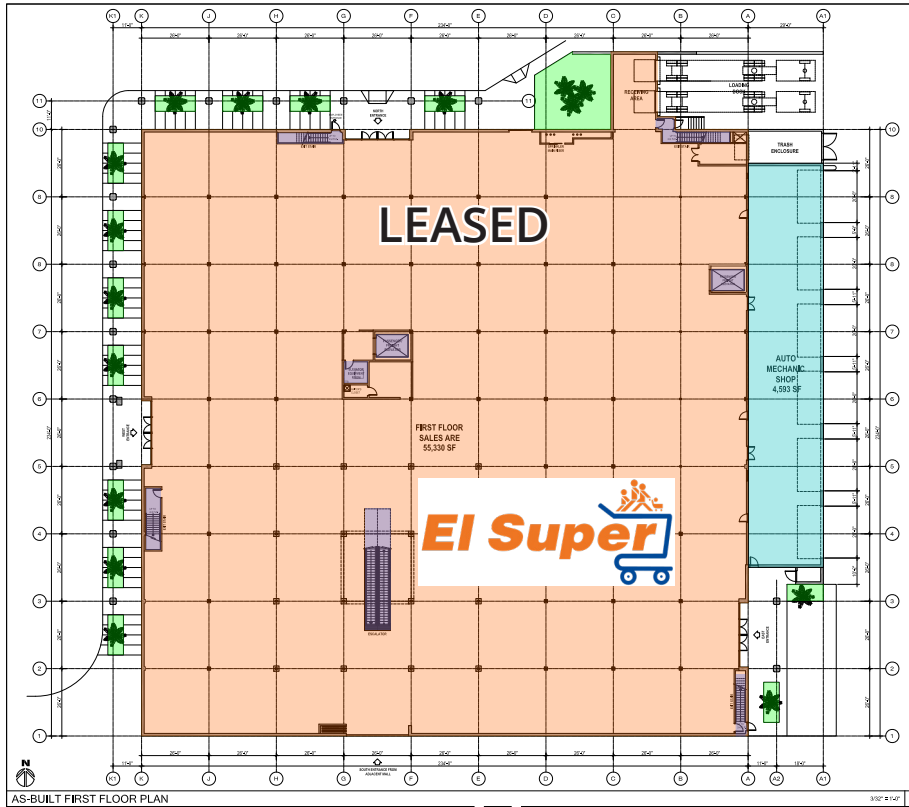

Ground Floor

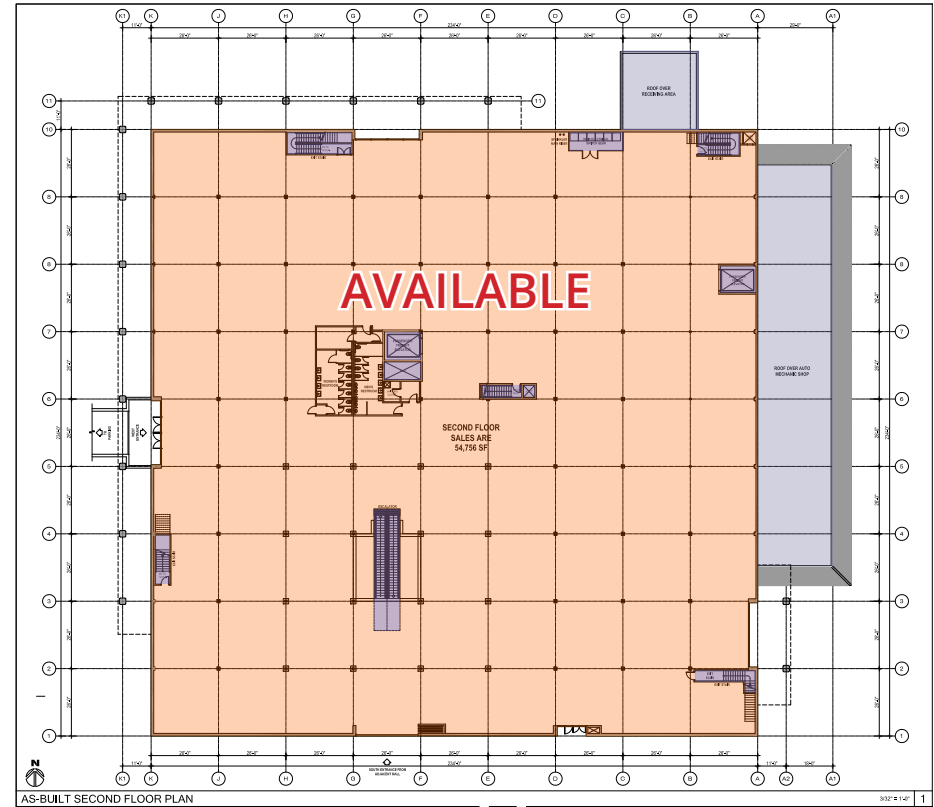

Second Floor

Chris Garner

805.928.2800 ext. 104

CGarner@PacificaCRE.com

Lic #01010310

Brian LaCabe

805.928.2800 ext. 103

BLaCabe@PacificaCRE.com

Lic #01026699



PO Box 250 | Santa Maria, CA 93456 | PacificaCommercialRealty.com

Information contained herein has been obtained from the owner of the property or from other sources deemed reliable. We have no reason to doubt its accuracy, but we do not guarantee it.

# FOR LEASE

200 Town Center East | Santa Maria, CA



NOTE:  
THIS SITE PLAN IS SUBJECT TO CITY PLANNING APPROVAL AS  
IT IS CURRENTLY UNDER ON-GOING SITE PLAN REVIEW FOR CITY  
PLANNING ENTITLEMENT APPROVAL.

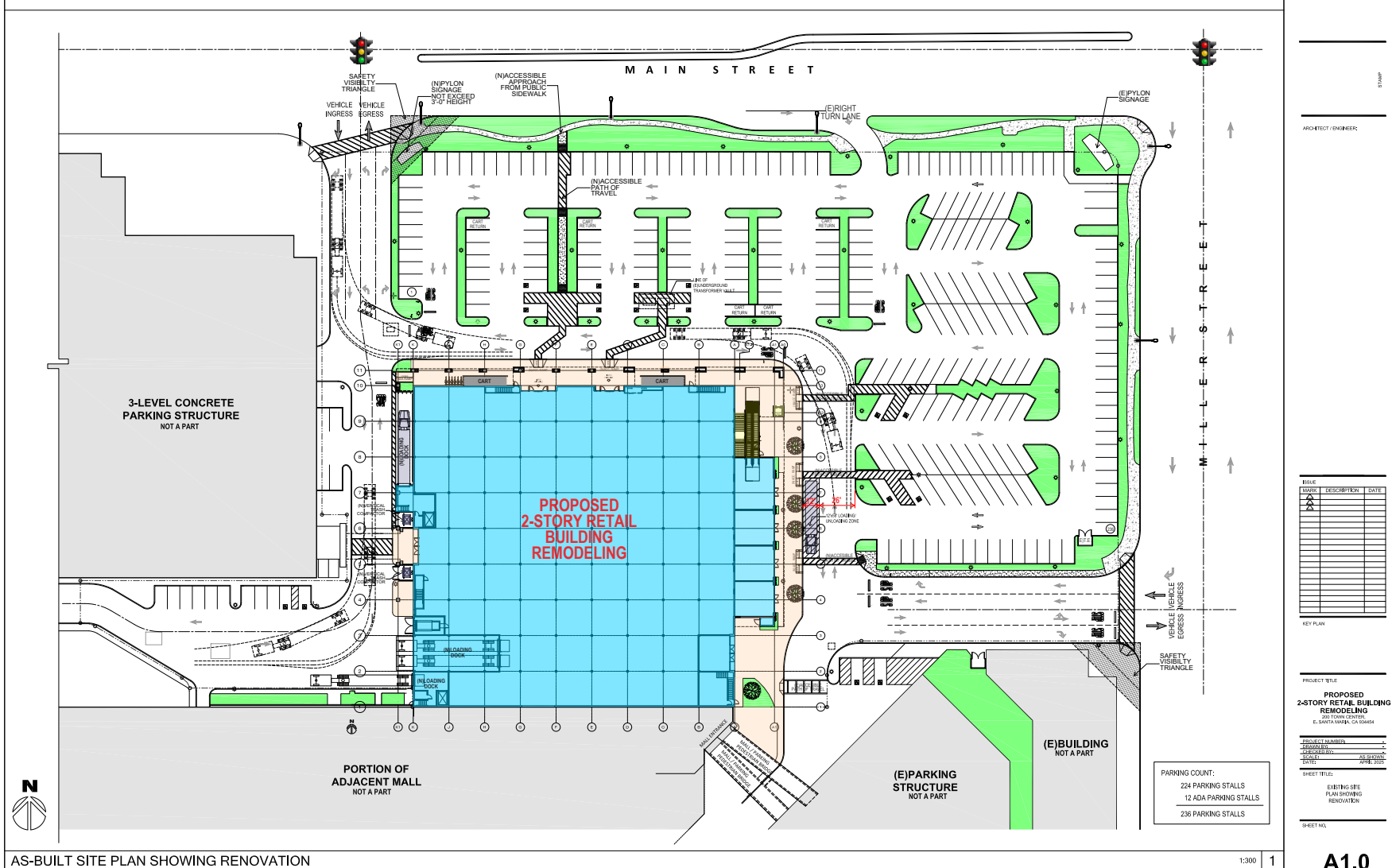



# FOR LEASE 200 Town Center East | Santa Maria, CA

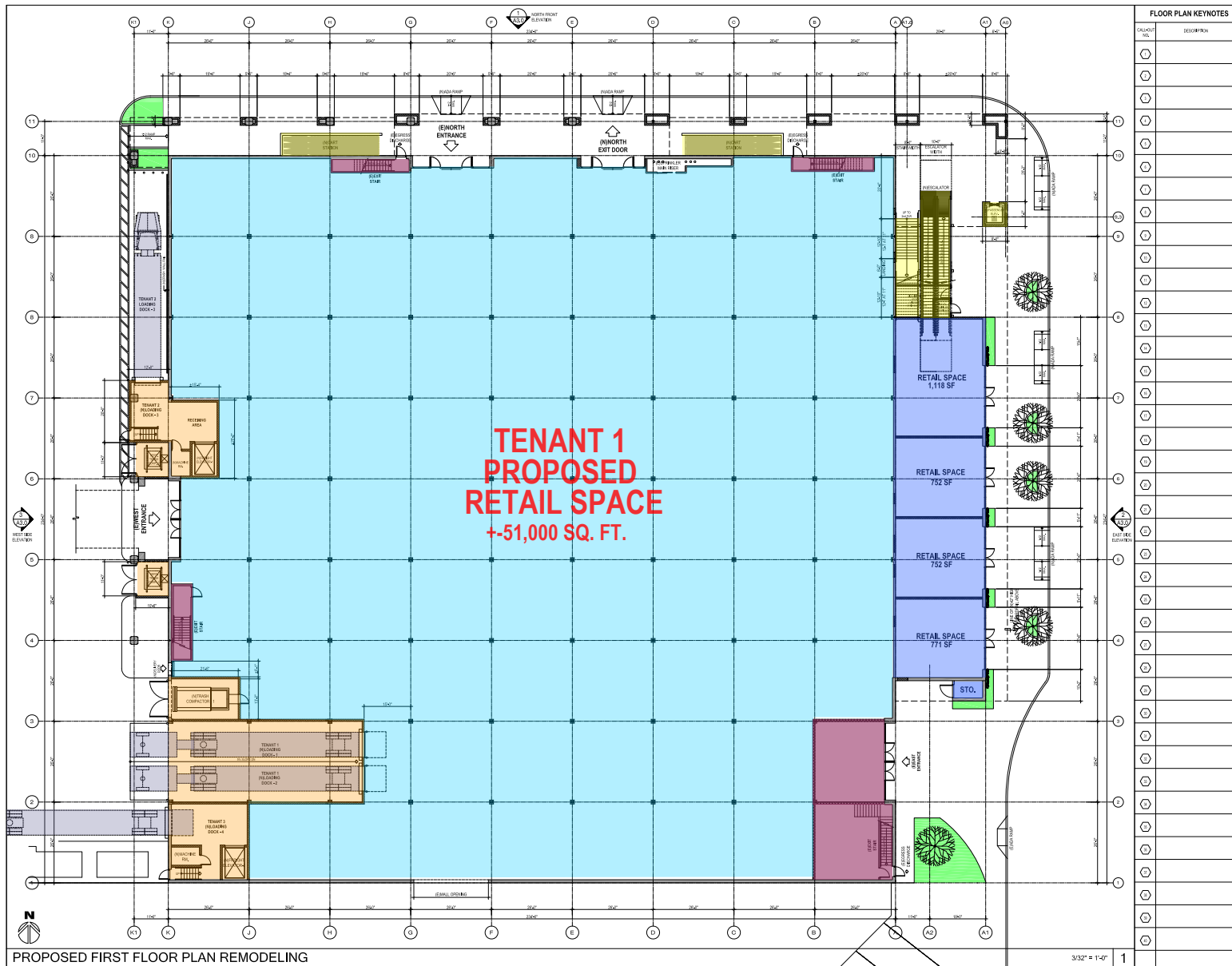

FLOOR PLAN KEYNOTES	
CALLOUT NO.	DESCRIPTION
1	
2	
3	
4	
5	
6	
7	
8	
9	
10	
11	
12	
13	
14	
15	
16	
17	
18	
19	
20	
21	
22	
23	
24	
25	
26	
27	
28	
29	
30	
31	
32	
33	
34	
35	
36	
37	
38	
39	
40	
41	
42	
43	
44	
45	
46	
47	
48	
49	
50	
51	
52	
53	
54	
55	
56	
57	
58	
59	
60	
61	
62	
63	
64	
65	
66	
67	
68	
69	
70	
71	
72	
73	
74	
75	
76	
77	
78	
79	
80	
81	
82	
83	
84	
85	
86	
87	
88	
89	
90	
91	
92	
93	
94	
95	
96	
97	
98	
99	
100	

**EXCEL**  
PROPERTY MANAGEMENT SERVICES, INC.  
9034 W. SUNSET BLVD.  
WEST HOLLYWOOD, CA 90069  
P 310 347-0800 F 310 347-0325  
www.excelcompany.com

ARCHITECT/ENGINEER

KEY PLAN

NO.	REVISION	DATE
1	ISSUED FOR PERMIT	01/11/2024
2	ISSUED FOR PERMIT	01/11/2024
3	ISSUED FOR PERMIT	01/11/2024
4	ISSUED FOR PERMIT	01/11/2024
5	ISSUED FOR PERMIT	01/11/2024
6	ISSUED FOR PERMIT	01/11/2024
7	ISSUED FOR PERMIT	01/11/2024
8	ISSUED FOR PERMIT	01/11/2024
9	ISSUED FOR PERMIT	01/11/2024
10	ISSUED FOR PERMIT	01/11/2024
11	ISSUED FOR PERMIT	01/11/2024
12	ISSUED FOR PERMIT	01/11/2024
13	ISSUED FOR PERMIT	01/11/2024
14	ISSUED FOR PERMIT	01/11/2024
15	ISSUED FOR PERMIT	01/11/2024
16	ISSUED FOR PERMIT	01/11/2024
17	ISSUED FOR PERMIT	01/11/2024
18	ISSUED FOR PERMIT	01/11/2024
19	ISSUED FOR PERMIT	01/11/2024
20	ISSUED FOR PERMIT	01/11/2024
21	ISSUED FOR PERMIT	01/11/2024
22	ISSUED FOR PERMIT	01/11/2024
23	ISSUED FOR PERMIT	01/11/2024
24	ISSUED FOR PERMIT	01/11/2024
25	ISSUED FOR PERMIT	01/11/2024
26	ISSUED FOR PERMIT	01/11/2024
27	ISSUED FOR PERMIT	01/11/2024
28	ISSUED FOR PERMIT	01/11/2024
29	ISSUED FOR PERMIT	01/11/2024
30	ISSUED FOR PERMIT	01/11/2024
31	ISSUED FOR PERMIT	01/11/2024
32	ISSUED FOR PERMIT	01/11/2024
33	ISSUED FOR PERMIT	01/11/2024
34	ISSUED FOR PERMIT	01/11/2024
35	ISSUED FOR PERMIT	01/11/2024
36	ISSUED FOR PERMIT	01/11/2024
37	ISSUED FOR PERMIT	01/11/2024
38	ISSUED FOR PERMIT	01/11/2024
39	ISSUED FOR PERMIT	01/11/2024
40	ISSUED FOR PERMIT	01/11/2024
41	ISSUED FOR PERMIT	01/11/2024
42	ISSUED FOR PERMIT	01/11/2024
43	ISSUED FOR PERMIT	01/11/2024
44	ISSUED FOR PERMIT	01/11/2024
45	ISSUED FOR PERMIT	01/11/2024
46	ISSUED FOR PERMIT	01/11/2024
47	ISSUED FOR PERMIT	01/11/2024
48	ISSUED FOR PERMIT	01/11/2024
49	ISSUED FOR PERMIT	01/11/2024
50	ISSUED FOR PERMIT	01/11/2024
51	ISSUED FOR PERMIT	01/11/2024
52	ISSUED FOR PERMIT	01/11/2024
53	ISSUED FOR PERMIT	01/11/2024
54	ISSUED FOR PERMIT	01/11/2024
55	ISSUED FOR PERMIT	01/11/2024
56	ISSUED FOR PERMIT	01/11/2024
57	ISSUED FOR PERMIT	01/11/2024
58	ISSUED FOR PERMIT	01/11/2024
59	ISSUED FOR PERMIT	01/11/2024
60	ISSUED FOR PERMIT	01/11/2024
61	ISSUED FOR PERMIT	01/11/2024
62	ISSUED FOR PERMIT	01/11/2024
63	ISSUED FOR PERMIT	01/11/2024
64	ISSUED FOR PERMIT	01/11/2024
65	ISSUED FOR PERMIT	01/11/2024
66	ISSUED FOR PERMIT	01/11/2024
67	ISSUED FOR PERMIT	01/11/2024
68	ISSUED FOR PERMIT	01/11/2024
69	ISSUED FOR PERMIT	01/11/2024
70	ISSUED FOR PERMIT	01/11/2024
71	ISSUED FOR PERMIT	01/11/2024
72	ISSUED FOR PERMIT	01/11/2024
73	ISSUED FOR PERMIT	01/11/2024
74	ISSUED FOR PERMIT	01/11/2024
75	ISSUED FOR PERMIT	01/11/2024
76	ISSUED FOR PERMIT	01/11/2024
77	ISSUED FOR PERMIT	01/11/2024
78	ISSUED FOR PERMIT	01/11/2024
79	ISSUED FOR PERMIT	01/11/2024
80	ISSUED FOR PERMIT	01/11/2024
81	ISSUED FOR PERMIT	01/11/2024
82	ISSUED FOR PERMIT	01/11/2024
83	ISSUED FOR PERMIT	01/11/2024
84	ISSUED FOR PERMIT	01/11/2024
85	ISSUED FOR PERMIT	01/11/2024
86	ISSUED FOR PERMIT	01/11/2024
87	ISSUED FOR PERMIT	01/11/2024
88	ISSUED FOR PERMIT	01/11/2024
89	ISSUED FOR PERMIT	01/11/2024
90	ISSUED FOR PERMIT	01/11/2024
91	ISSUED FOR PERMIT	01/11/2024
92	ISSUED FOR PERMIT	01/11/2024
93	ISSUED FOR PERMIT	01/11/2024
94	ISSUED FOR PERMIT	01/11/2024
95	ISSUED FOR PERMIT	01/11/2024
96	ISSUED FOR PERMIT	01/11/2024
97	ISSUED FOR PERMIT	01/11/2024
98	ISSUED FOR PERMIT	01/11/2024
99	ISSUED FOR PERMIT	01/11/2024
100	ISSUED FOR PERMIT	01/11/2024

PROJECT TITLE  
**PROPOSED 2-STORY RETAIL BUILDING REMODELING**

PROJECT LOCATION  
200 TOWN CENTER  
E. SANTA MARIA, CA 93456

DATE  
01/11/2024

SHEET NO.  
**A2.0**

# FOR LEASE

200 Town Center East | Santa Maria, CA





# FOR LEASE 200 Town Center East | Santa Maria, CA

Population	2 miles	5 miles	10 miles
2020 Population	87,600	122,470	177,558
2024 Population	85,914	120,507	173,558
2029 Population Projection	85,103	119,446	171,838
Annual Growth 2020-2024	-0.5%	-0.4%	-0.6%
Annual Growth 2024-2029	-0.2%	-0.2%	-0.2%
Median Age	29.3	30.9	33.3
Bachelor's Degree or Higher	10%	14%	19%
U.S. Armed Forces	87	319	373

Population By Race	2 miles	5 miles	10 miles
White	21,490	36,198	66,319
Black	1,056	1,767	2,262
American Indian/Alaskan Native	3,537	4,335	5,487
Asian	2,975	5,033	6,890
Hawaiian & Pacific Islander	90	121	217
Two or More Races	56,766	73,052	92,384
Hispanic Origin	69,831	89,262	112,297

Housing	2 miles	5 miles	10 miles
Median Home Value	\$398,044	\$427,274	\$474,193
Median Year Built	1975	1979	1981

Households	2 miles	5 miles	10 miles
2020 Households	22,286	33,167	52,095
2024 Households	21,801	32,590	50,718
2029 Household Projection	21,571	32,275	50,148
Annual Growth 2020-2024	0.4%	0.6%	0.4%
Annual Growth 2024-2029	-0.2%	-0.2%	-0.2%
Owner Occupied Households	9,642	17,001	30,073
Renter Occupied Households	11,929	15,274	20,076
Avg Household Size	3.7	3.5	3.3
Avg Household Vehicles	2	2	2
Total Specified Consumer Spending (\$)	\$732.8M	\$1.2B	\$1.9B

Income	2 miles	5 miles	10 miles
Avg Household Income	\$80,827	\$91,857	\$100,893
Median Household Income	\$67,661	\$77,118	\$81,591
< \$25,000	3,810	4,866	6,920
\$25,000 - 50,000	4,223	5,527	7,978
\$50,000 - 75,000	4,052	5,412	8,347
\$75,000 - 100,000	4,073	5,784	8,016
\$100,000 - 125,000	2,076	3,622	5,316
\$125,000 - 150,000	1,377	2,607	4,655
\$150,000 - 200,000	1,208	2,790	5,128
\$200,000+	983	1,982	4,357

Chris Garner  
805.928.2800 ext. 104  
CGarner@PacificaCRE.com  
Lic #01010310

Brian LaCabe  
805.928.2800 ext. 103  
BLaCabe@PacificaCRE.com  
Lic #01026699



PO Box 250 | Santa Maria, CA 93456 | PacificaCommercialRealty.com

Information contained herein has been obtained from the owner of the property or from other sources deemed reliable. We have no reason to doubt its accuracy, but we do not guarantee it.

# FOR LEASE 200 Town Center East | Santa Maria, CA

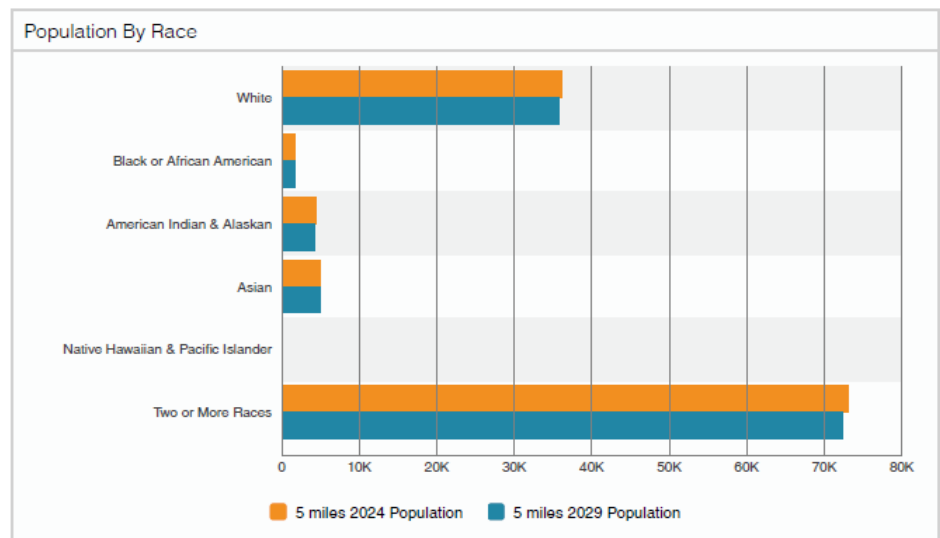
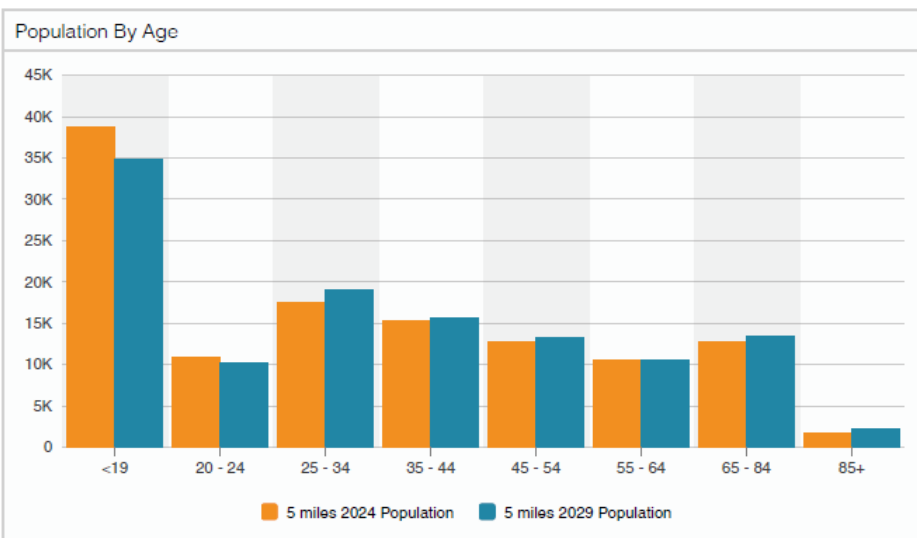
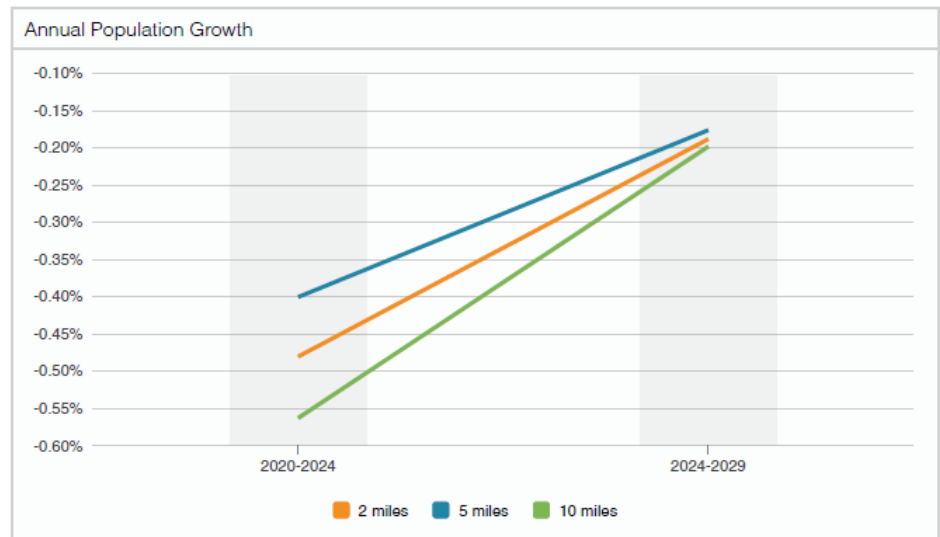
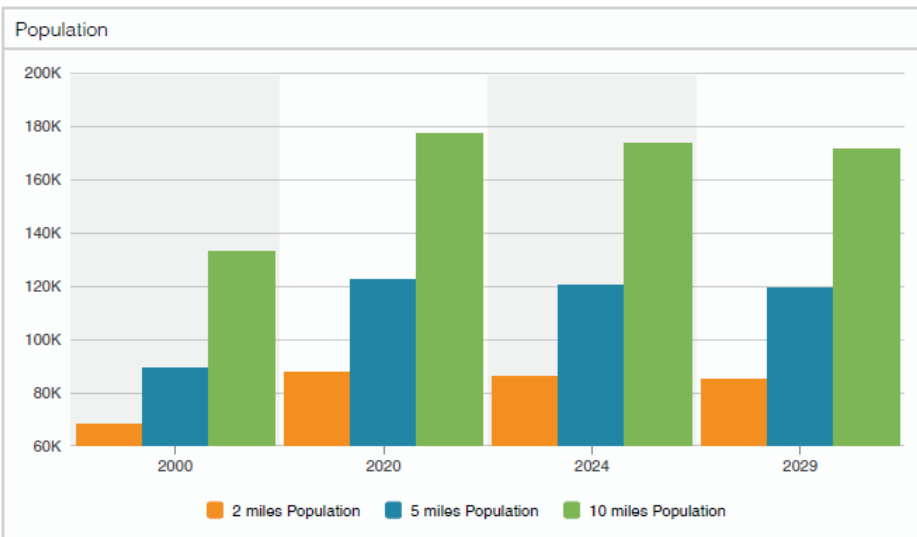

# FOR LEASE 200 Town Center East | Santa Maria, CA

Population By Race & Hispanic Origin

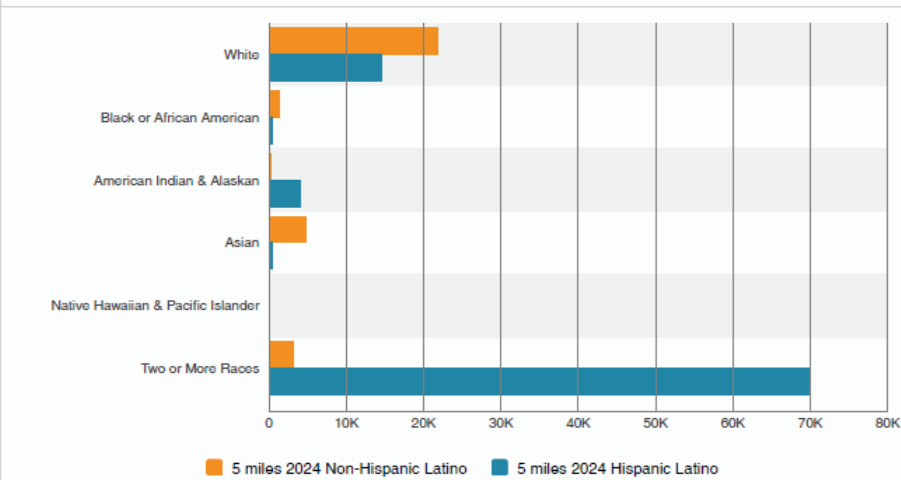

Educational Attainment

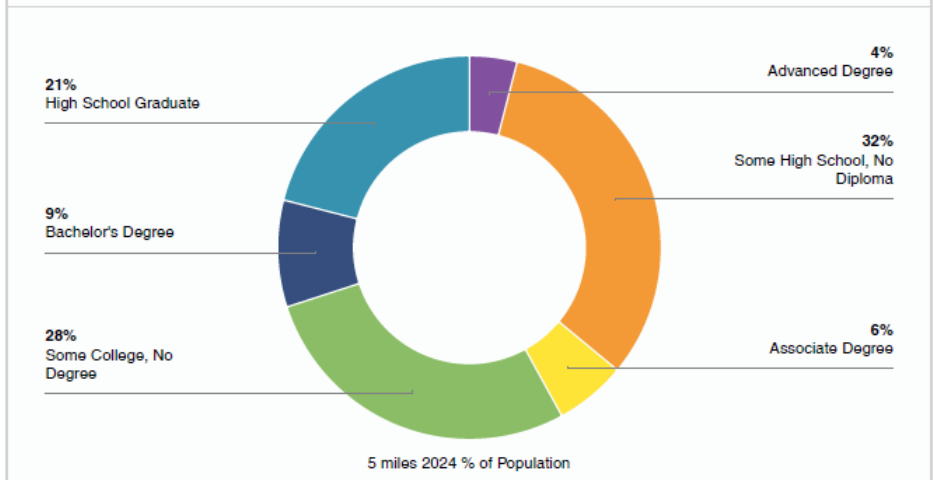

Households

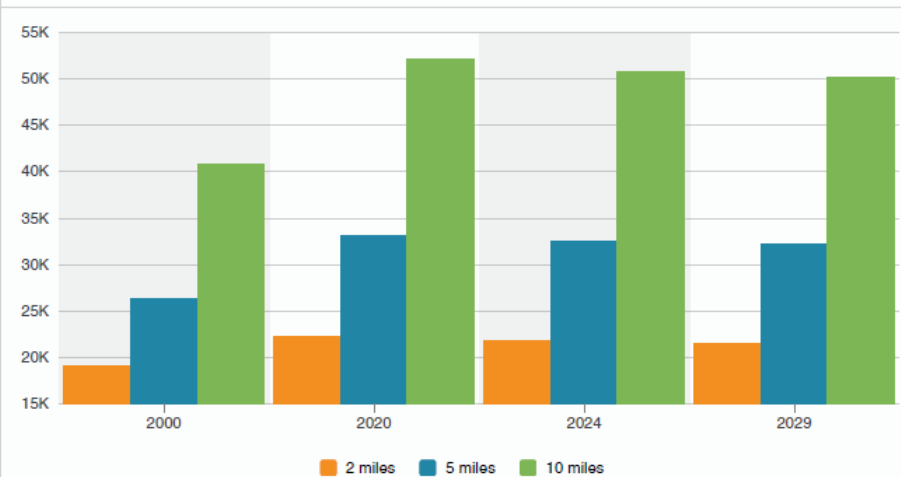

Household Size

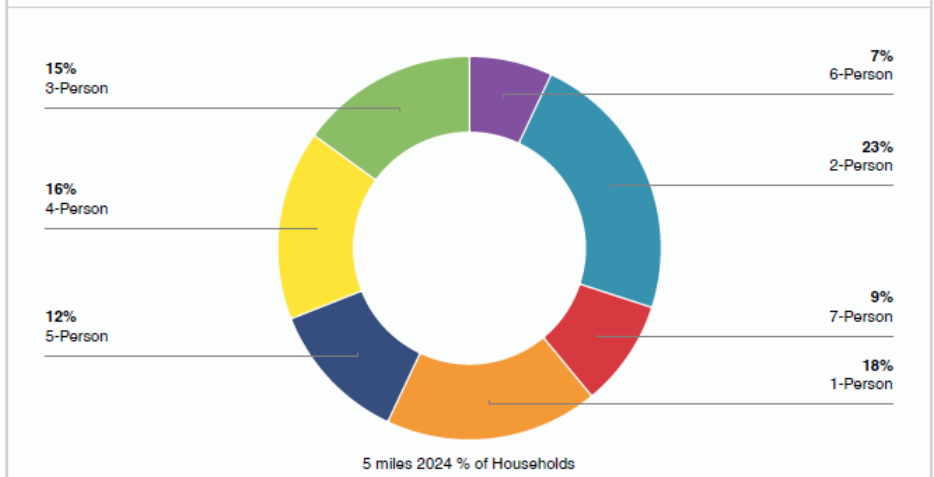



# FOR LEASE 200 Town Center East | Santa Maria, CA

Household Income

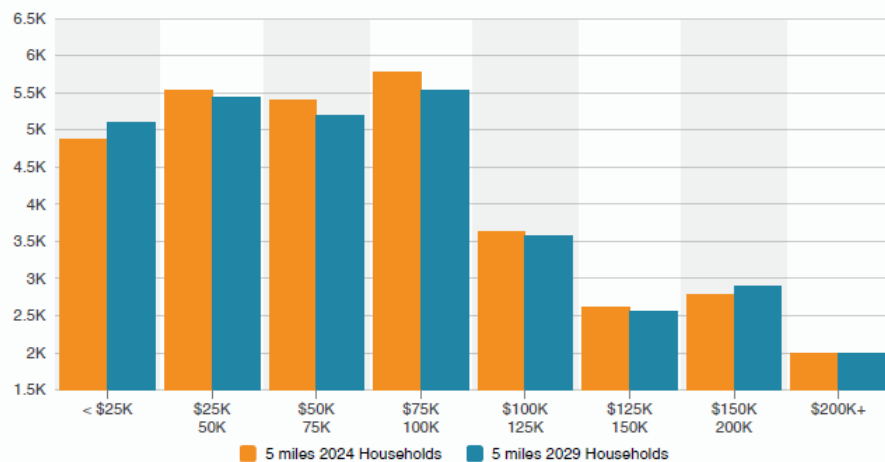

Household Income By Age

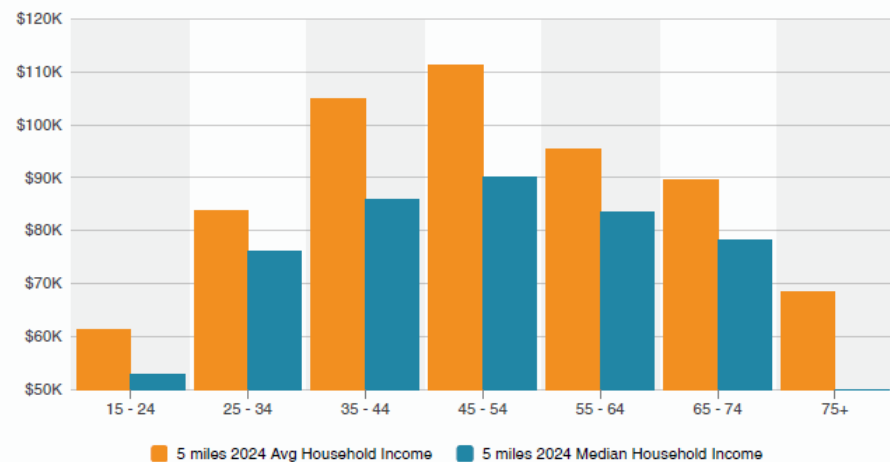

Housing Occupancy

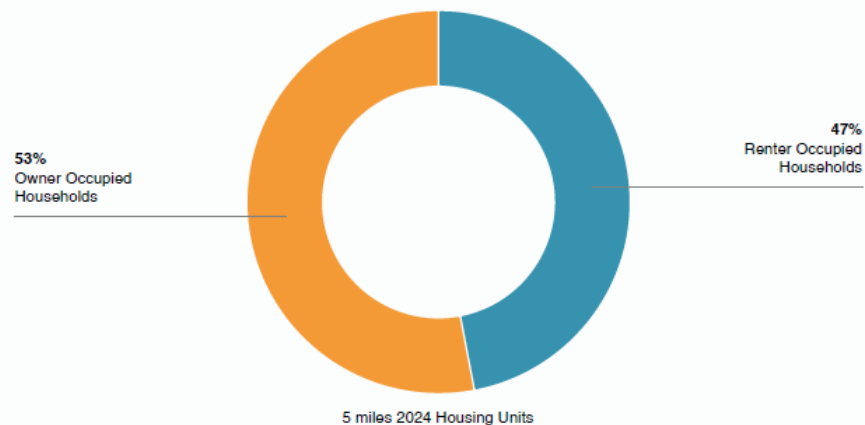

Home Values

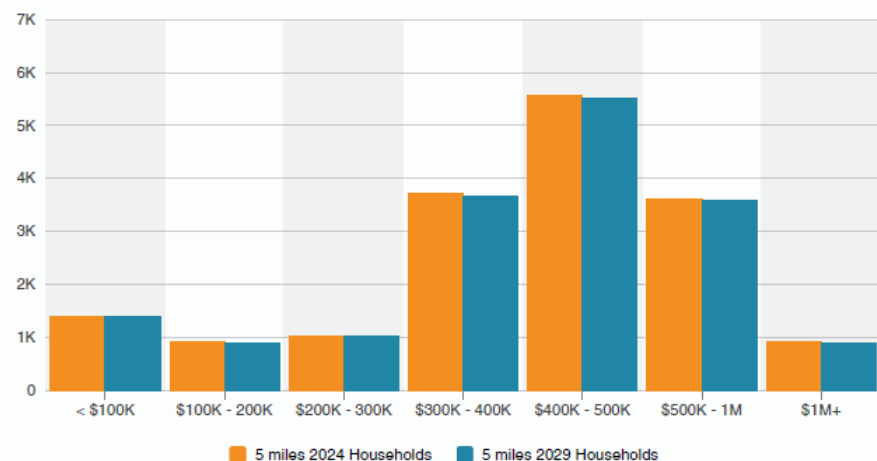

# FOR LEASE 200 Town Center East | Santa Maria, CA

Homes By Year Built

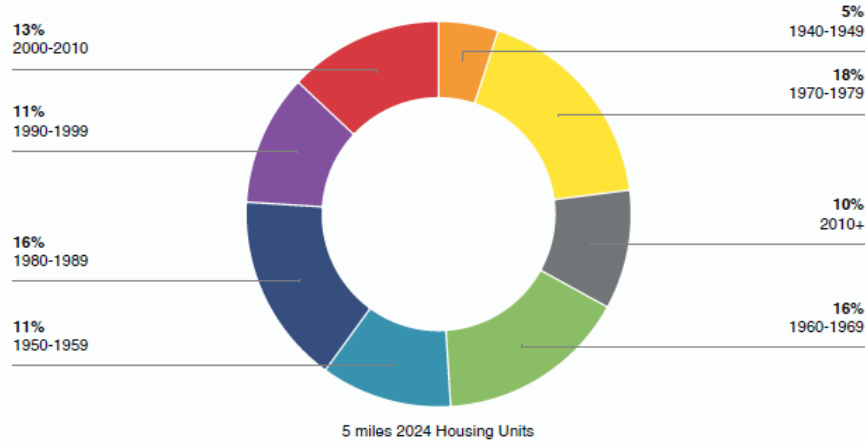

Housing Type

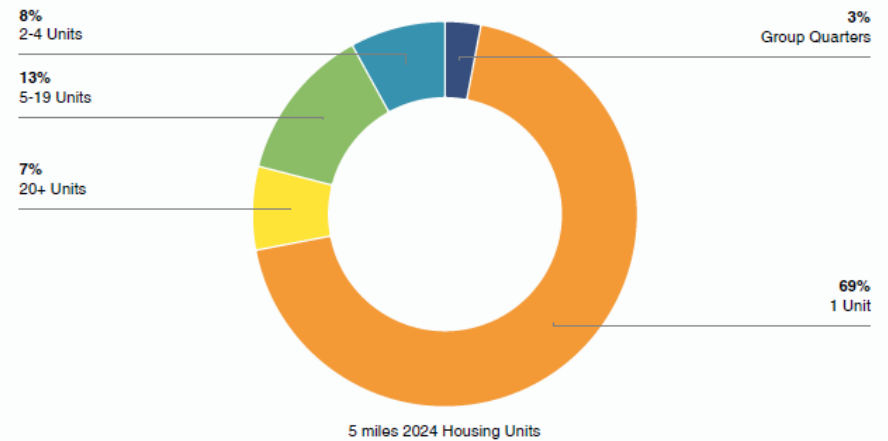

Population Travel To Work

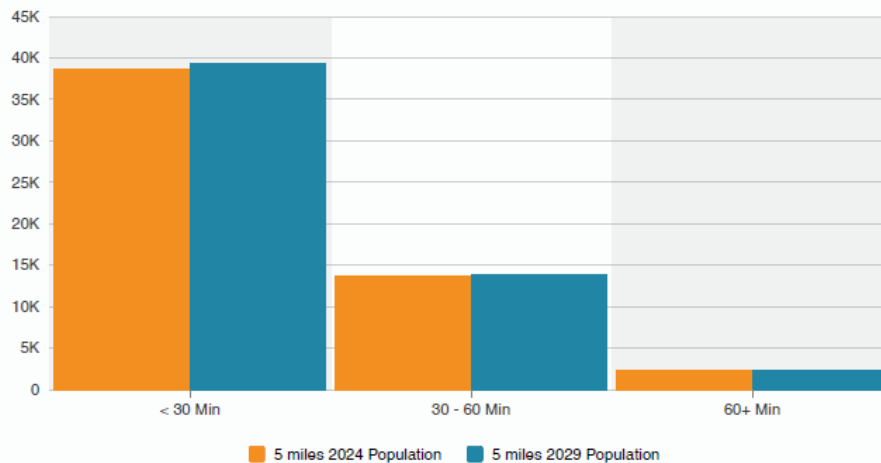

Chris Garner

805.928.2800 ext. 104

CGarner@PacificaCRE.com

Lic #01010310

Brian LaCabe

805.928.2800 ext. 103

BLaCabe@PacificaCRE.com

Lic #01026699

PO Box 250 | Santa Maria, CA 93456 | PacificaCommercialRealty.com



Information contained herein has been obtained from the owner of the property or from other sources deemed reliable. We have no reason to doubt its accuracy, but we do not guarantee it.

# FOR LEASE 200 Town Center East | Santa Maria, CA

Daytime Employment									
Radius	2 miles			5 miles			10 miles		
	Employees	Businesses	Employees Per Business	Employees	Businesses	Employees Per Business	Employees	Businesses	Employees Per Business
Service-Producing Industries	23,004	3,292	7	36,430	4,843	8	44,013	6,119	7
Trade Transportation & Utilit...	5,310	453	12	8,986	745	12	10,813	981	11
Information	581	74	8	1,374	116	12	1,443	133	11
Financial Activities	1,805	373	5	2,766	574	5	3,306	724	5
Professional & Business Se...	1,900	352	5	3,639	599	6	4,754	824	6
Education & Health Services	8,367	1,383	6	11,230	1,786	6	13,191	2,102	6
Leisure & Hospitality	2,856	223	13	4,287	329	13	5,477	450	12
Other Services	1,528	385	4	2,337	581	4	3,035	780	4
Public Administration	657	49	13	1,811	113	16	1,994	125	16
Goods-Producing Industries	3,278	237	14	7,452	499	15	9,369	779	12
Natural Resources & Mining	1,424	45	32	1,825	83	22	2,403	132	18
Construction	1,167	144	8	2,551	272	9	3,520	450	8
Manufacturing	687	48	14	3,076	144	21	3,446	197	17
Total	26,282	3,529	7	43,882	5,342	8	53,382	6,898	8

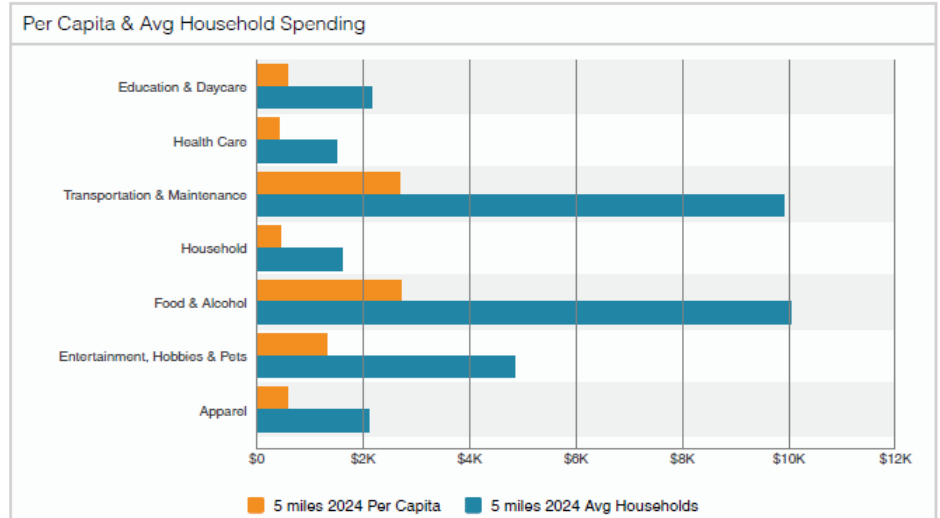
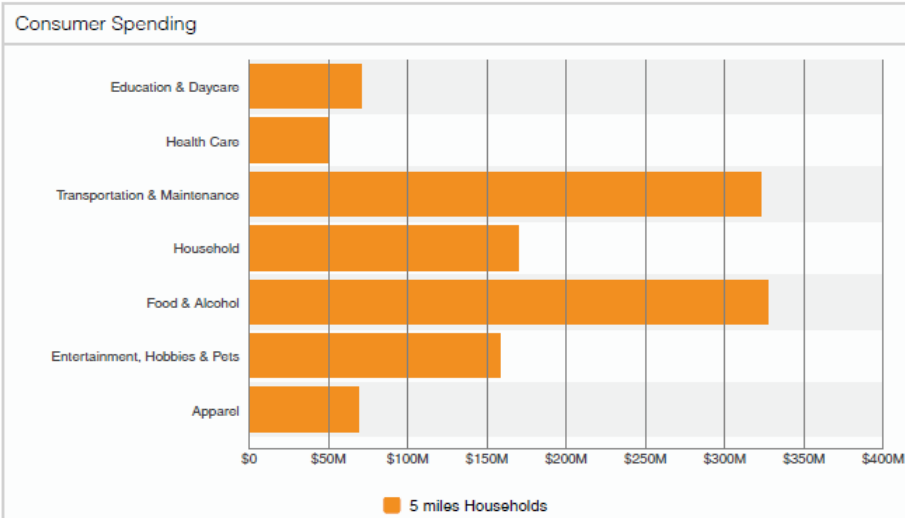



# FOR LEASE 200 Town Center East | Santa Maria, CA

## Consumer Spending Details

2024 2029

Radius	2 miles			5 miles			10 miles		
Expand All	Total Spending	Avg Household	Per Capita	Total Spending	Avg Household	Per Capita	Total Spending	Avg Household	Per Capita
Apparel	\$45,870,165	\$2,104	\$534	\$68,669,073	\$2,107	\$570	\$104,622,409	\$2,063	\$603
Entertainment, Hobbies & P...	\$96,358,674	\$4,420	\$1,122	\$157,851,733	\$4,844	\$1,310	\$266,382,012	\$5,252	\$1,535
Food & Alcohol	\$213,463,820	\$9,791	\$2,485	\$327,155,494	\$10,039	\$2,715	\$514,680,384	\$10,148	\$2,965
Household	\$99,059,621	\$4,544	\$1,153	\$169,707,822	\$5,207	\$1,408	\$296,851,126	\$5,853	\$1,710
Transportation & Maintenance	\$205,779,388	\$9,439	\$2,395	\$323,045,768	\$9,912	\$2,681	\$518,385,817	\$10,221	\$2,987
Health Care	\$30,440,820	\$1,396	\$354	\$49,255,768	\$1,511	\$409	\$84,236,365	\$1,661	\$485
Education & Daycare	\$41,849,321	\$1,920	\$487	\$70,631,178	\$2,167	\$586	\$122,357,056	\$2,412	\$705
Total Specified Consumer S...	\$732,821,809	\$33,614	\$8,530	\$1,166,316,836	\$35,788	\$9,678	\$1,907,515,169	\$37,610	\$10,991

## Traffic

Collection Street	Cross Street	Traffic Volume	Count Year	Distance from Property
E Main St	Miller St E	16,944	2025	0.08 mi
Miller St	E Church St S	11,223	2025	0.09 mi
E Main St	McClelland St E	19,560	2025	0.13 mi
E Main St	Miller St W	19,277	2025	0.14 mi
N Miller St	Chapel St N	8,418	2025	0.16 mi
Cook St	Miller St E	7,569	2025	0.17 mi
South Broadway	-	29,163	2025	0.17 mi
West Main Street	S Broadway W	25,071	2025	0.18 mi
CA 166	S Broadway W	25,300	2021	0.18 mi
166	-	18,941	2025	0.18 mi

Chris Garner

805.928.2800 ext. 104

CGarner@PacificaCRE.com

Lic #01010310

Brian LaCabe

805.928.2800 ext. 103

BLaCabe@PacificaCRE.com

Lic #01026699



PO Box 250 | Santa Maria, CA 93456 | PacificaCommercialRealty.com

Information contained herein has been obtained from the owner of the property or from other sources deemed reliable. We have no reason to doubt its accuracy, but we do not guarantee it.

# FOR LEASE

200 Town Center East | Santa Maria, CA



Chris Garner

805.928.2800 ext. 104

CGarner@PacificaCRE.com

Lic #01010310

Brian LaCabe

805.928.2800 ext. 103

BLaCabe@PacificaCRE.com

Lic #01026699



PO Box 250 | Santa Maria, CA 93456 | [PacificaCommercialRealty.com](http://PacificaCommercialRealty.com)

Information contained herein has been obtained from the owner of the property or from other sources deemed reliable. We have no reason to doubt its accuracy, but we do not guarantee it.