

FOR LEASE

FRUIT VALLEY COMMERCE CENTER

4817 Fruit Valley Road | Vancouver, WA 98660



900 Washington St, Suite 850, Vancouver, WA
360.750.5595 | www.fg-cre.com



PROPERTY HIGHLIGHTS

Available 7/1/2026

- Suite 100 – 1,000 SF, includes 240 SF office and private restroom
- Utilities: 3 Phase power in suite
- Ceiling height: 16' - 18' clear height
- Loading: 12' x 14' insulated roll-up doors
- Heat: Gas heat available in warehouse
- Rate: Call broker for details

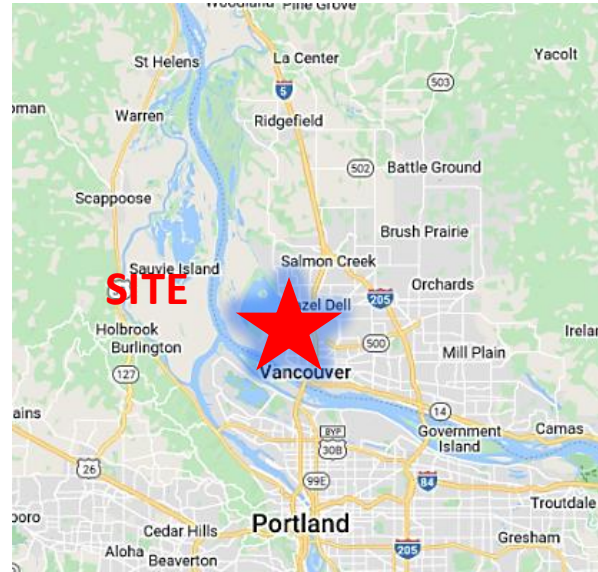

FOR MORE INFORMATION:

Reilly Hennessey
360.607.1143 | rhennessy@fg-cre.com

FOR LEASE

FRUIT VALLEY COMMERCE CENTER

4817 Fruit Valley Road | Vancouver, WA 98660



900 Washington St, Suite 850, Vancouver, WA
360.750.5595 | www.fg-cre.com



Suite 100 1,000 SF

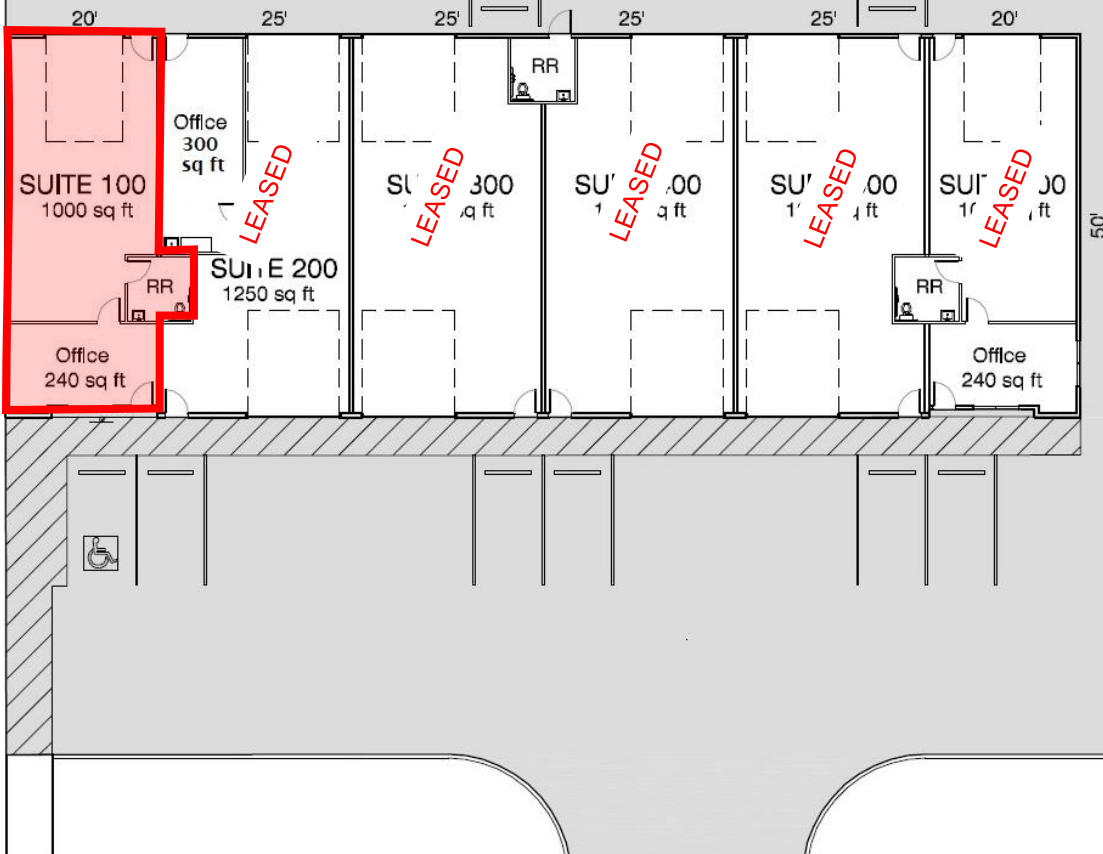

This statement with the information it contains is given with the understanding that all the negotiations relating to the purchase, rental or leasing of the property described above shall be conducted through this office. The above information, while not guaranteed, has been secured from sources we believe to be reliable.