

FND. 5/8" I.R.

S 00°50'36" E
174.34'

155.3892 ACRES
TEXAS CAPITAL BANK, N.A.
PER C.F. NO. N613310

ROBIN
A.B.S.T. RACT
FND. 5/8" I.R.
SURVEY
NO. 571

JOHN S. RICKETTS SURVEY

853.76'

783.64'

REMAINING PORTION
151.4583 ACRES
LLYOD A. WHITE, TRUSTEE
PER C.F. NO. P203369

**TRACT 7
3.000 ACRES**

151.4583 ACRES
LLYOD A. WHITE, TRUSTEE
PER C.F. NO. P203369

*** BEING MORE PARTICULARLY
DESCRIBED BY ATTACHED
METES & BOUNDS.

N 65°26'28" E

S 65°26'28" W

MOST SOUTHERLY CORNER
OF A 2.0 ACRE TRACT PER
VOL. 3477, PG. 562, H.C.D.R.

POINT OF BEGINNING

S 24°33'32" E 262.16'

FND. 5/8" I.R.

159.62'
N 24°33'32" W

FND. 5/8" I.R.

HUFFMEISTER ROAD (60' R.O.W.)

11/27/19

FLOOD ZONE DETERMINED BY GRAPHIC PLOTTING ONLY. WE DO NOT ASSUME RESPONSIBILITY FOR EXACT DETERMINATION.
ALL BEARINGS BASED ON METES & BOUNDS.

GF NO.: 97106519

LOT: 3.000 AC, ***	BLOCK:	SECTION:	SUBDIVISION:	This lot <u>DOES NOT</u> lie in the 100 year flood plain and is in <u>ZONE "X"</u> as located by the Federal Insurance Administration designated Flood Hazard Area by Community Panel No. <u>480287 0085H</u> dated <u>9-30-92</u>
RECORDATION:	COUNTY: HARRIS	STATE: TEXAS	SURVEY: JOHN S. RICKETTS SURVEY, A-671	
LENDER:	TITLE CO.: STEWART TITLE COMPANY			

PURCHASER: ROBIN C. LEASE AND NANCY L. LEASE
ADDRESS: VACANT LOT ON HUFFMEISTER ROAD, CYPRESS, TEXAS 77429
JOB NO.: 9701016

FIELD WORK
01-10-97-BS
DRAFTED BY
01-24-97-MA
CHECKED BY
01-24-97-MA
KEY MAP NO.
3271
REVISIONS



I hereby certify that this plat was made from an actual survey on the ground by me or under my direction; that no encroachments exist at the time of this survey unless reflected hereon; that said survey substantially conforms to the current Texas Board of Professional Land Survey Standards and Specifications.

HLS
Horne Land Surveying, L.L.C.
16760 Hedgecroft, Suite 608
Houston, Tx 77060
(Office) 281 445-4100 (Fax) 281 445-4131

EXHIBIT "A"

Being 3.0000 acres situated in the John S. Ricketts Survey, A-671, Harris County, Texas, out of a 151.4583 acre tract conveyed to Lloyd A. White, Trustee and described by deed recorded under County Clerk's File No. P203369 of the Official Public Records of Real Property of Harris County, Texas, said 3.0000 acres of land being more particularly described by metes and bounds as follows:

BEGINNING at a found 5/8 inch diameter iron rod in the Northeasterly right-of-way line of Huffmeister Road (60 feet wide), being located S 24° 33' 32" E, a distance of 262.16 feet from a 1 inch diameter iron pipe for the most Southerly corner of a 2.00 acre tract described by deed recorded in Volume 3477, Page 562, of the Deed Records of Harris County;

THENCE N 65° 26' 28" E, a distance of 853.76 feet to 5/8 inch diameter iron rod in the common boundary line between the Ricketts Survey and the A. Bodin Survey, A-133, and the East boundary line of said 151.4583 acres for the Northeast corner of this tract;

THENCE S 00° 50' 38" E along the common boundary line between the Ricketts and Bodin Surveys, and the East boundary line of said 151.4583 acres, a distance of 104.34 feet to a found 5/8 inch diameter iron rod for the Southeast corner of this tract;

THENCE S 65° 26' 28" W, a distance of 783.64 feet to a found 5/8 inch diameter iron rod in the Northeasterly right-of-way line of Huffmeister Road for the Southwest corner of this tract;

THENCE N 24° 33' 32" W along the Northeasterly right-of-way line of Huffmeister Road, a distance of 159.62 feet to the **POINT OF BEGINNING** and containing 3.0000 acres of land.

GF No. 97106519

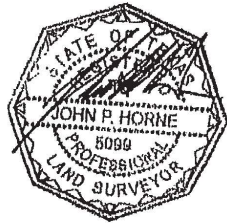

11/27/19