



RICHMOND ROAD INDUSTRIAL PARK

7812 RICHMOND RD, TOANO, VA 23168

NOW LEASING!



INDUSTRIAL WAREHOUSE, OFFICE & LAY DOWN YARD ALONG INTERSTATE 64

FEATURES

- ▶ 53,000 SF total square feet of warehouse & office space in industrial park
- ▶ Lay down yard can be divided a variety of ways for different tenant's needs
- ▶ Easy access to I-64
- ▶ 30 minutes to Richmond International Airport
- ▶ M-1 Zoning
- ▶ Direct connection to Williamsburg Area Transit Authority
- ▶ Within 43 miles of the Port of Virginia and situated within a designated Foreign Trade Zone makes this property ideal for import/export logistics
- ▶ Loading dock and drive-in roll-up doors available

SUMMARY

AVAILABLE	Building #2 Warehouse & Office	21,000 SF
	Building #4 Warehouse	5,442 SF
	Building #5A Warehouse	14,000 SF
	Building #5B Warehouse	13,000 SF

NEARBY

Port of Virginia, Colonial Williamsburg, CarQuest Auto Parts, DMV, Luck Stone, Greystone of VA, Smithfield Foods, Newport News/Williamsburg & Richmond Airports, Richmond Marine Terminal, Williamsburg Premium Outlets, Sentara Regional Medical Center, YMCA, Great Wolf Lodge

CONTACT

Sean Eichert, (804) 419-2295
seichert@realestateservicesco.com, realestateservicesco.com

Real Estate Services, Co.
13281 River's Bend Blvd, Suite 201, Chester, VA 23836

AERIAL

LAYDOWN YARD
1.50 ACRES

#5A
14,000 SF WAREHOUSE

#5B
13,000 SF WAREHOUSE

LAYDOWN YARD
1.4 ACRES

LAYDOWN YARD
0.76 ACRES

LAYDOWN YARD
2.15 ACRES

LEASED

DOCK

#2
21,000 SF WAREHOUSE, MEZZANINE & OFFICE

LEASED

LEASED

LEASED



RICHMOND RD / ROUTE 60

FLOOR PLANS

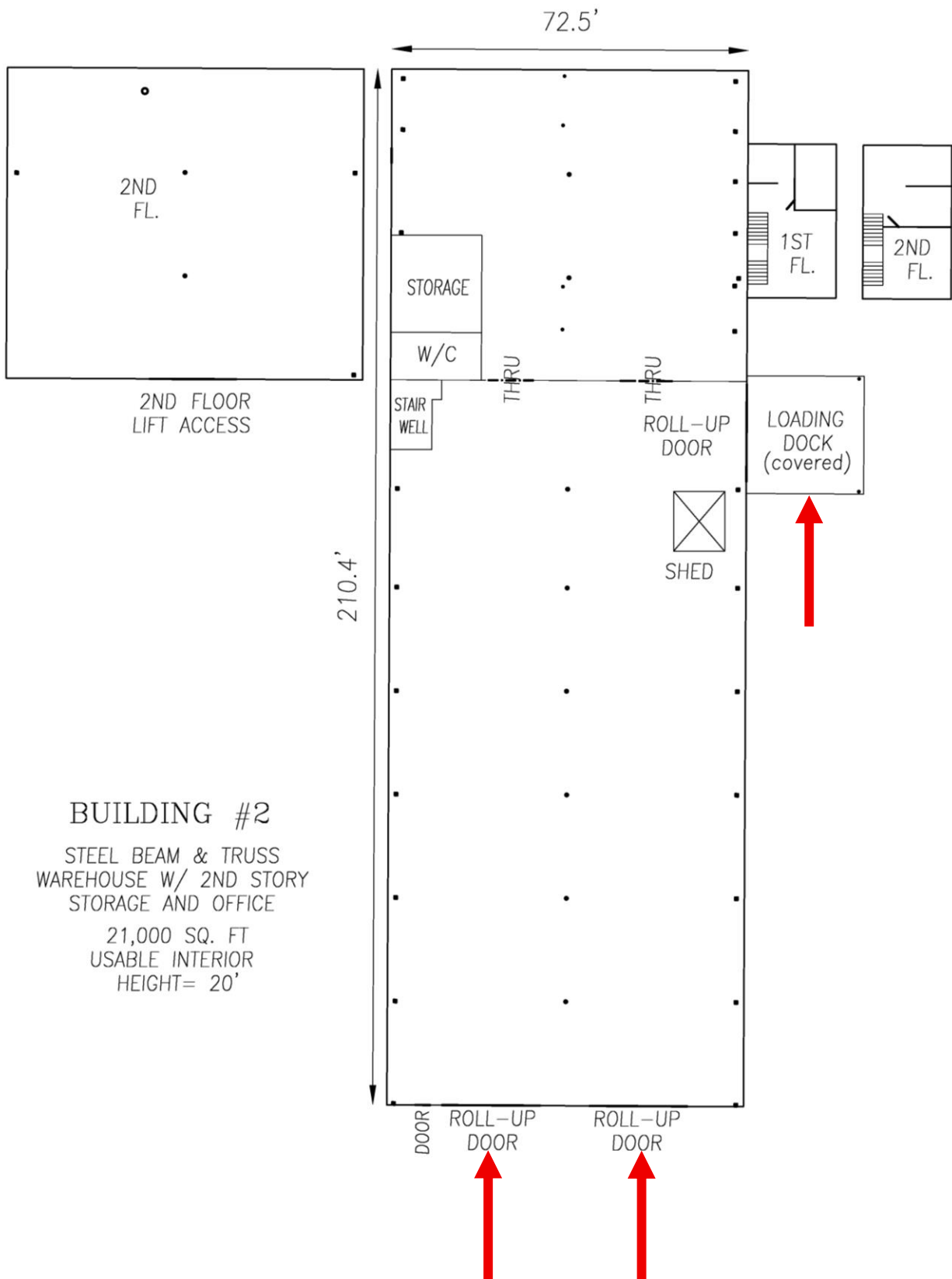

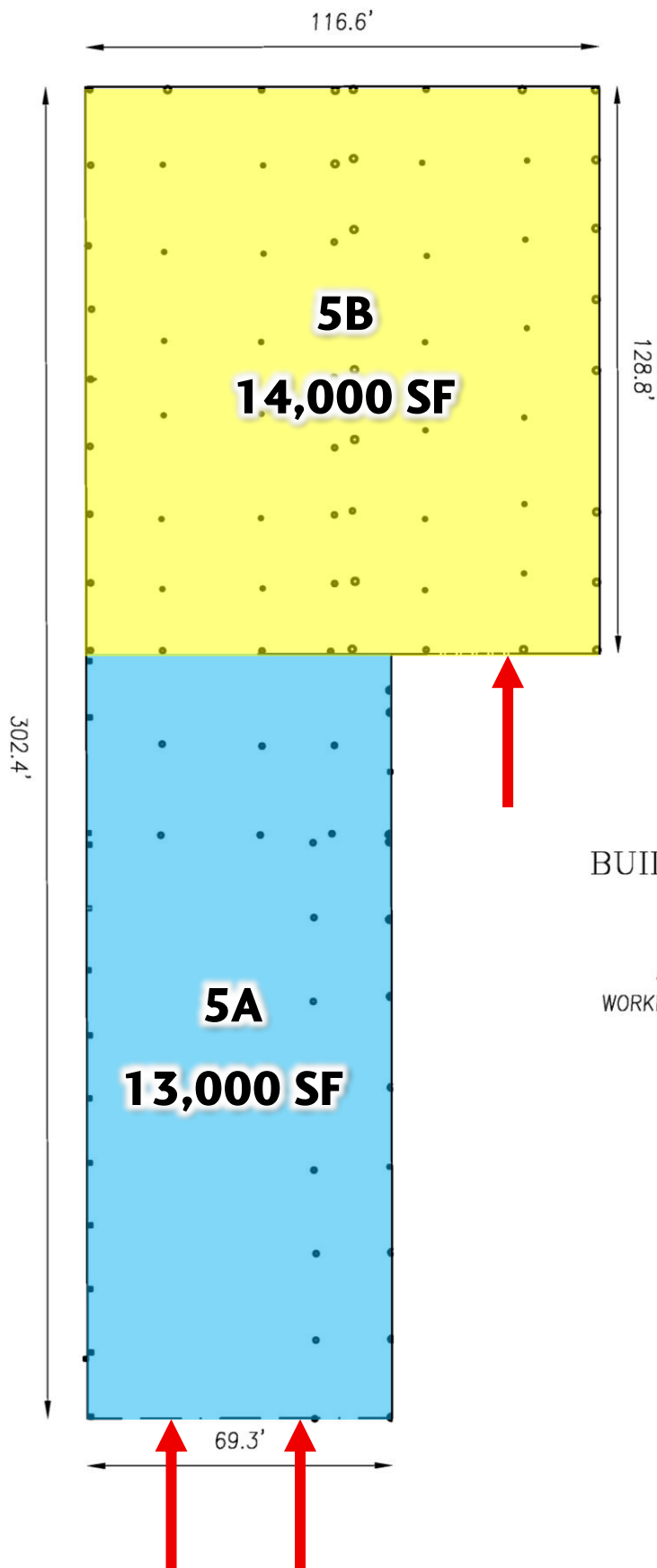

BUILDING #5A-5B

POLE & BEAM
WAREHOUSE
ASPHALT FLOOR
WORKING HEIGHT OF INTERIOR
20 FT.

27,059 SQ. FT.

PHOTOS





BUILDINGS #5A & 5B

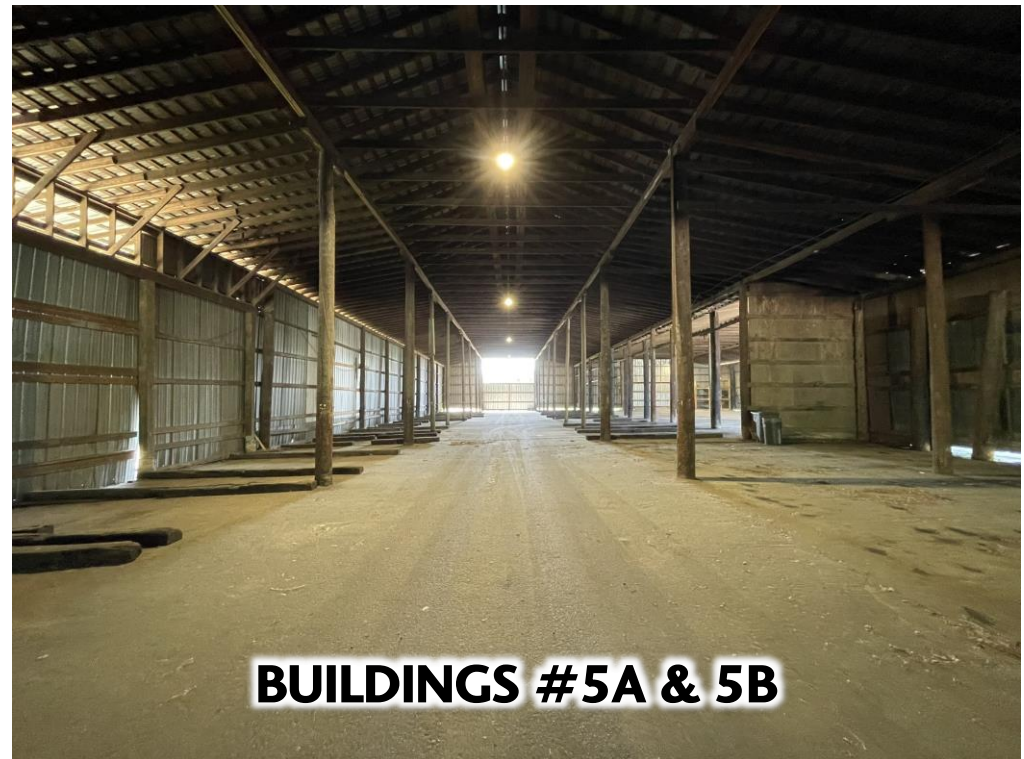

BUILDINGS #5A & 5B



BUILDING #5A



BUILDING #5B