

RETAIL FOR LEASE

RICHLAND COMMONS

6801 Rufe Snow Drive | Watauga, Texas 76148

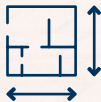

SPACE AVAILABLE
1,560-10,500 SF



PRICING
**CONTACT BROKER
(NNN EST. \$6.00 PSF)**

CONTACT

Tracy Gray | 817.629.0176 | tgray@holtlunsford.com

Ross Moncrief | 817.632.6154 | rmoncrief@holtlunsford.com

This information is deemed reliable, however Holt Lunsford Commercial makes no guarantees, warranties or representation as to the completeness or accuracy thereof.



RETAIL FOR LEASE

RICHLAND COMMONS

6801 Rufe Snow Drive | Watauga, Texas 76148

PROPERTY HIGHLIGHTS

- 32,317 SF Neighborhood Shopping Center built in 2004
- 3,209 SF 2nd-Gen Medical Space Available with X-ray room
- Positioned in Growing North Fort Worth, 7.2% Projected 5-Year Growth & \$98,954 Average Household Incomes within 3 Mile Radius
- Four Minutes North of Loop-820
- Pylon Signage Available Visible from Rufe Snow Dr & Hightower Dr Intersection
- Surrounded by National & Regional Retailers including: Pizza Hut, Walgreens, Little Caesars, O' Reilly's and More
- 10,500 SF anchor space available

DEMOGRAPHICS

	1 MILE	3 MILE	5 MILE
Population	18,193.00	131,823.00	305,702.00
Employees	2,193.00	24,917.00	98,170.00
Average Household Income	\$85,423.00	\$98,954.00	\$103,170.00
Median Age	36.4	36.6	36.3
2020-25 Projected Poulation Growth	7.2%	7.2%	7.2%
Traffic Count	30,472 VPD @ Rufe Snow Dr		

CONTACT

Tracy Gray | 817.629.0176 | tgray@holtlunsford.com

Ross Moncrief | 817.632.6154 | rmoncrief@holtlunsford.com

This information is deemed reliable, however Holt Lunsford Commercial makes no guarantees, warranties or representation as to the completeness or accuracy thereof.

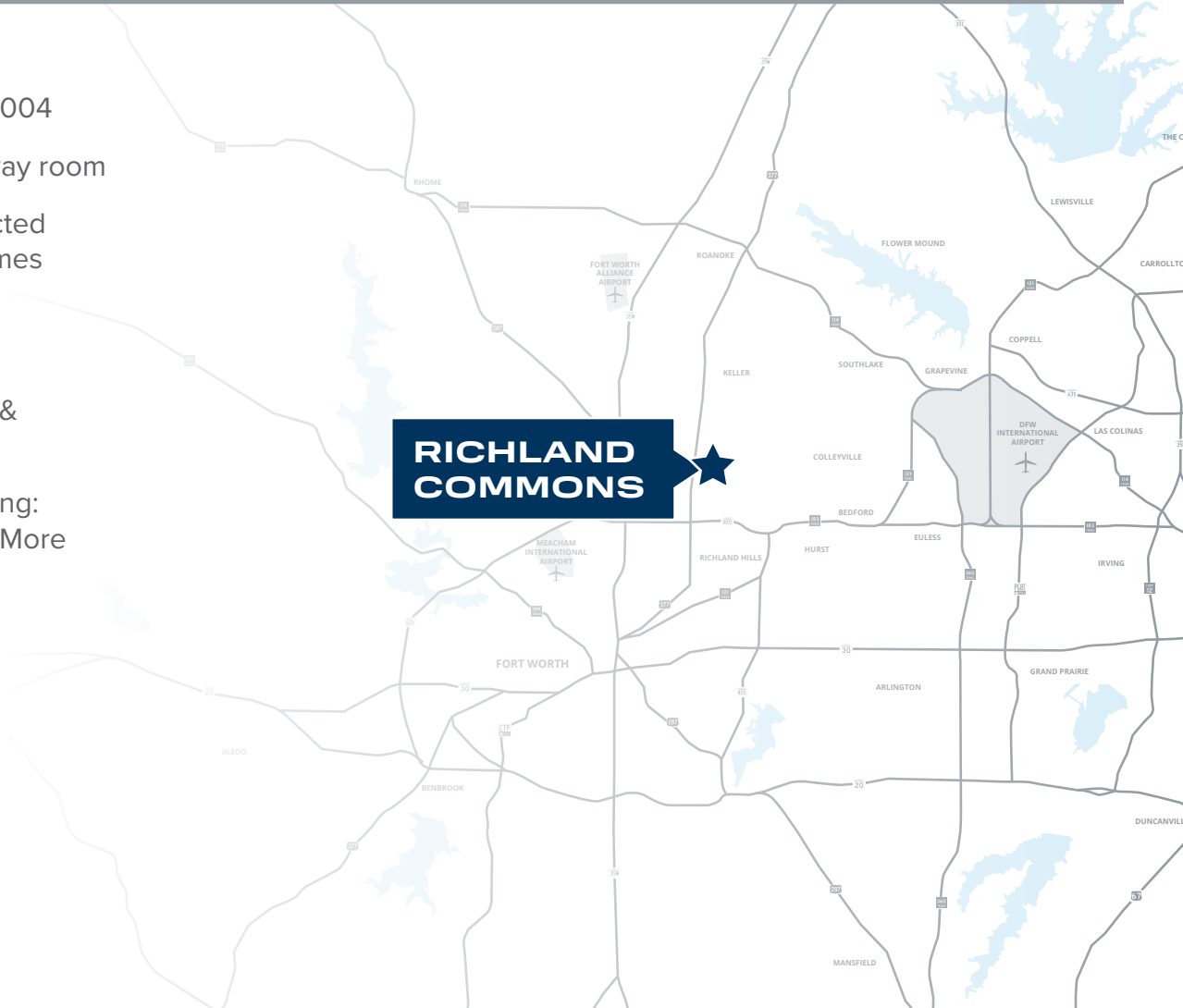

RETAIL FOR LEASE

RICHLAND COMMONS

6801 Rufe Snow Drive | Watauga, Texas 76148



CONTACT

Tracy Gray | 817.629.0176 | tgray@holtlunsford.com

Ross Moncrief | 817.632.6154 | rmoncrief@holtlunsford.com

This information is deemed reliable, however Holt Lunsford Commercial makes no guarantees, warranties or representation as to the completeness or accuracy thereof.



RETAIL FOR LEASE

RICHLAND COMMONS

6801 Rufe Snow Drive | Watauga, Texas 76148



CONTACT

Tracy Gray | 817.629.0176 | tgray@holtlunsford.com

Ross Moncrief | 817.632.6154 | rmoncrief@holtlunsford.com

This information is deemed reliable, however Holt Lunsford Commercial makes no guarantees, warranties or representation as to the completeness or accuracy thereof.



RETAIL FOR LEASE

RICHLAND COMMONS

6801 Rufe Snow Drive | Watauga, Texas 76148

LEASE DETAILS

SUITE	SIZE (SF)	STATUS
100	2,400	HK Sushi
104	1,360	Little Ceaser's
108	2,100	Spicy Nails & Spa
112	3,209	Available 2nd Gen Medical
200	1,560	Available
204	500	Great Clips
300	10,500	Available
310	4,218	Available 2nd Gen Retail Space Divisible to 1,500 SF
400	1,800	Je Vape
404	571	Nia Nia Foot Spa
408	2,250	SWAGAT Indian Cuisine

Rufe Snow Drive | 30,472 VPD

CONTACT

Tracy Gray | 817.629.0176 | tgray@holtlunsford.com

Ross Moncrief | 817.632.6154 | rmoncrief@holtlunsford.com

This information is deemed reliable, however Holt Lunsford Commercial makes no guarantees, warranties or representation as to the completeness or accuracy thereof.



RETAIL FOR LEASE

RICHLAND COMMONS

6801 Rufe Snow Drive | Watauga, Texas 76148

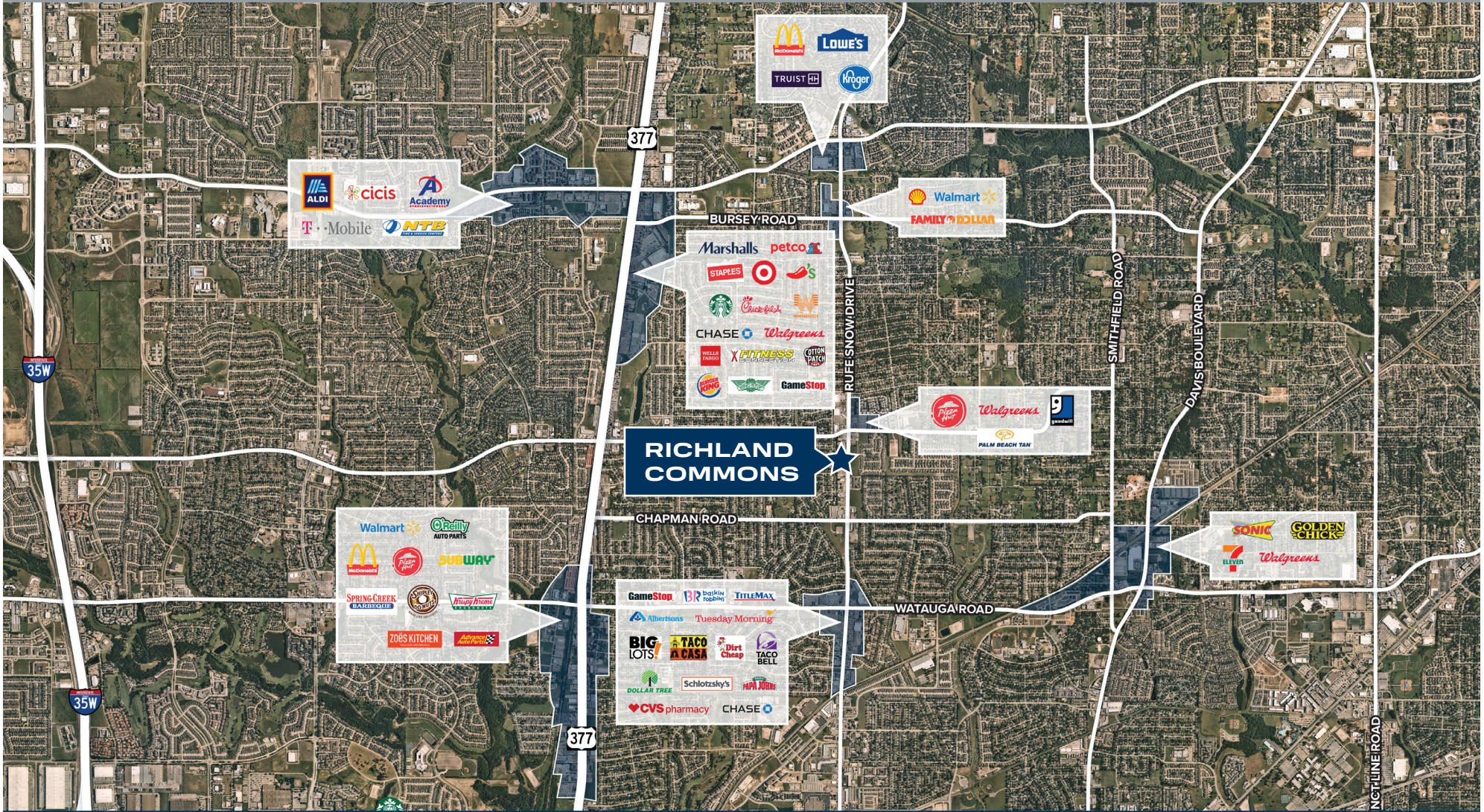

CONTACT

Tracy Gray | 817.629.0176 | tgray@holtlunsford.com

Ross Moncrief | 817.632.6154 | rmoncrief@holtlunsford.com

This information is deemed reliable, however Holt Lunsford Commercial makes no guarantees, warranties or representation as to the completeness or accuracy thereof.





Information About Brokerage Services

Texas law requires all real estate license holders to give the following information about brokerage services to prospective buyers, tenants, sellers and landlords.

11-2-2015



TYPES OF REAL ESTATE LICENSE HOLDERS:

- A **BROKER** is responsible for all brokerage activities, including acts performed by sales agents sponsored by the broker.
- A **SALES AGENT** must be sponsored by a broker and works with clients on behalf of the broker.

A BROKER'S MINIMUM DUTIES REQUIRED BY LAW (A client is the person or party that the broker represents):

- Put the interests of the client above all others, including the broker's own interests;
- Inform the client of any material information about the property or transaction received by the broker;
- Answer the client's questions and present any offer to or counter-offer from the client; and
- Treat all parties to a real estate transaction honestly and fairly.

A LICENSE HOLDER CAN REPRESENT A PARTY IN A REAL ESTATE TRANSACTION:

AS AGENT FOR OWNER (SELLER/LANDLORD): The broker becomes the property owner's agent through an agreement with the owner, usually in a written listing to sell or property management agreement. An owner's agent must perform the broker's minimum duties above and must inform the owner of any material information about the property or transaction known by the agent, including information disclosed to the agent or subagent by the buyer or buyer's agent.

AS AGENT FOR BUYER/TENANT: The broker becomes the buyer/tenant's agent by agreeing to represent the buyer, usually through a written representation agreement. A buyer's agent must perform the broker's minimum duties above and must inform the buyer of any material information about the property or transaction known by the agent, including information disclosed to the agent by the seller or seller's agent.

AS AGENT FOR BOTH - INTERMEDIARY: To act as an intermediary between the parties the broker must first obtain the written agreement of *each party* to the transaction. The written agreement must state who will pay the broker and, in conspicuous bold or underlined print, set forth the broker's obligations as an intermediary. A broker who acts as an intermediary:

- Must treat all parties to the transaction impartially and fairly;
- May, with the parties' written consent, appoint a different license holder associated with the broker to each party (owner and buyer) to communicate with, provide opinions and advice to, and carry out the instructions of each party to the transaction.
- Must not, unless specifically authorized in writing to do so by the party, disclose:
 - o that the owner will accept a price less than the written asking price;
 - o that the buyer/tenant will pay a price greater than the price submitted in a written offer; and
 - o any confidential information or any other information that a party specifically instructs the broker in writing not to disclose, unless required to do so by law.

AS SUBAGENT: A license holder acts as a subagent when aiding a buyer in a transaction without an agreement to represent the buyer. A subagent can assist the buyer but does not represent the buyer and must place the interests of the owner first.

TO AVOID DISPUTES, ALL AGREEMENTS BETWEEN YOU AND A BROKER SHOULD BE IN WRITING AND CLEARLY ESTABLISH:

- The broker's duties and responsibilities to you, and your obligations under the representation agreement.
- Who will pay the broker for services provided to you, when payment will be made and how the payment will be calculated.

LICENSE HOLDER CONTACT INFORMATION: This notice is being provided for information purposes. It does not create an obligation for you to use the broker's services. Please acknowledge receipt of this notice below and retain a copy for your records.

_____ Licensed Broker /Broker Firm Name or Primary Assumed Business Name	_____ License No.	_____ Email	_____ Phone
_____ Designated Broker of Firm	_____ License No.	_____ Email	_____ Phone
_____ Licensed Supervisor of Sales Agent/ Associate	_____ License No.	_____ Email	_____ Phone
_____ Sales Agent/Associate's Name	_____ License No.	_____ Email	_____ Phone

Buyer/Tenant/Seller/Landlord Initials

Date