

455
ROUTE 23
WANTAGE

2,900 SF RETAIL SPACE



SUBLEASE THROUGH JUNE 2027

PROPERTY DETAILS

- Part of 75,000 SF shopping center
- Anchor tenants include ACME, Snap Fitness, Friendly's, US Postal Services
- Abundant parking



PREMISES:

2,900 SF

AVAILABILITY:

Immediate

ASKING RENT:

\$30.00 PSF

TERM:

Thru 6/2027



FOR INFORMATION, PLEASE CONTACT:

PAUL E. GIANNONE

Executive Managing Director
732 452 6184
paul.giannone@cushwake.com

KEVIN CARTON

Executive Managing Director
732 452 6186
kevin.carton@cushwake.com

BRODY STRICKLAND

Associate
732 452 6163
brody.strickland@cushwake.com

99 Wood Avenue South, Suite 800
Iselin, NJ 08830
cushmanwakefield.com



**CUSHMAN &
WAKEFIELD**

455

ROUTE 23
WANTAGE

2,900 SF RETAIL SPACE

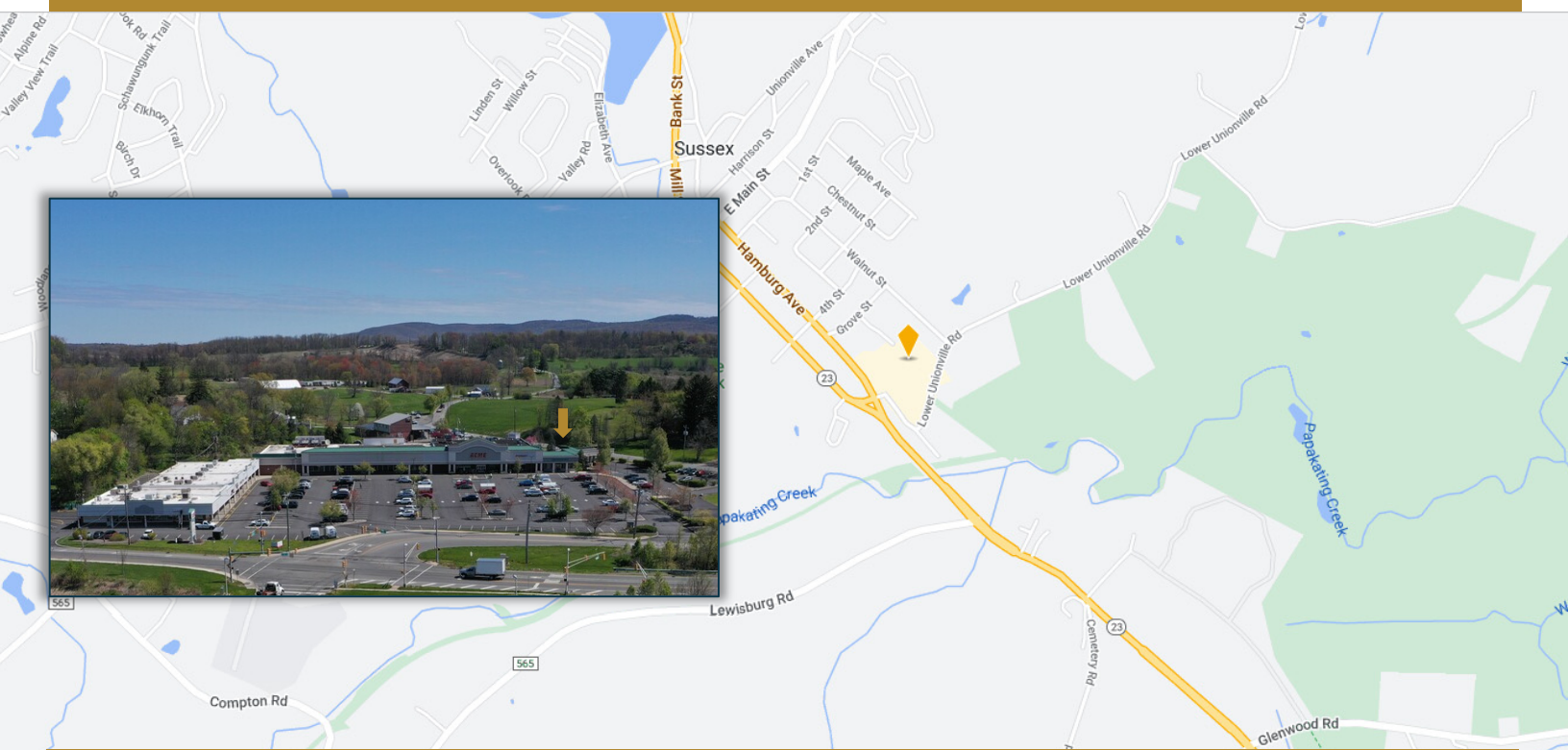
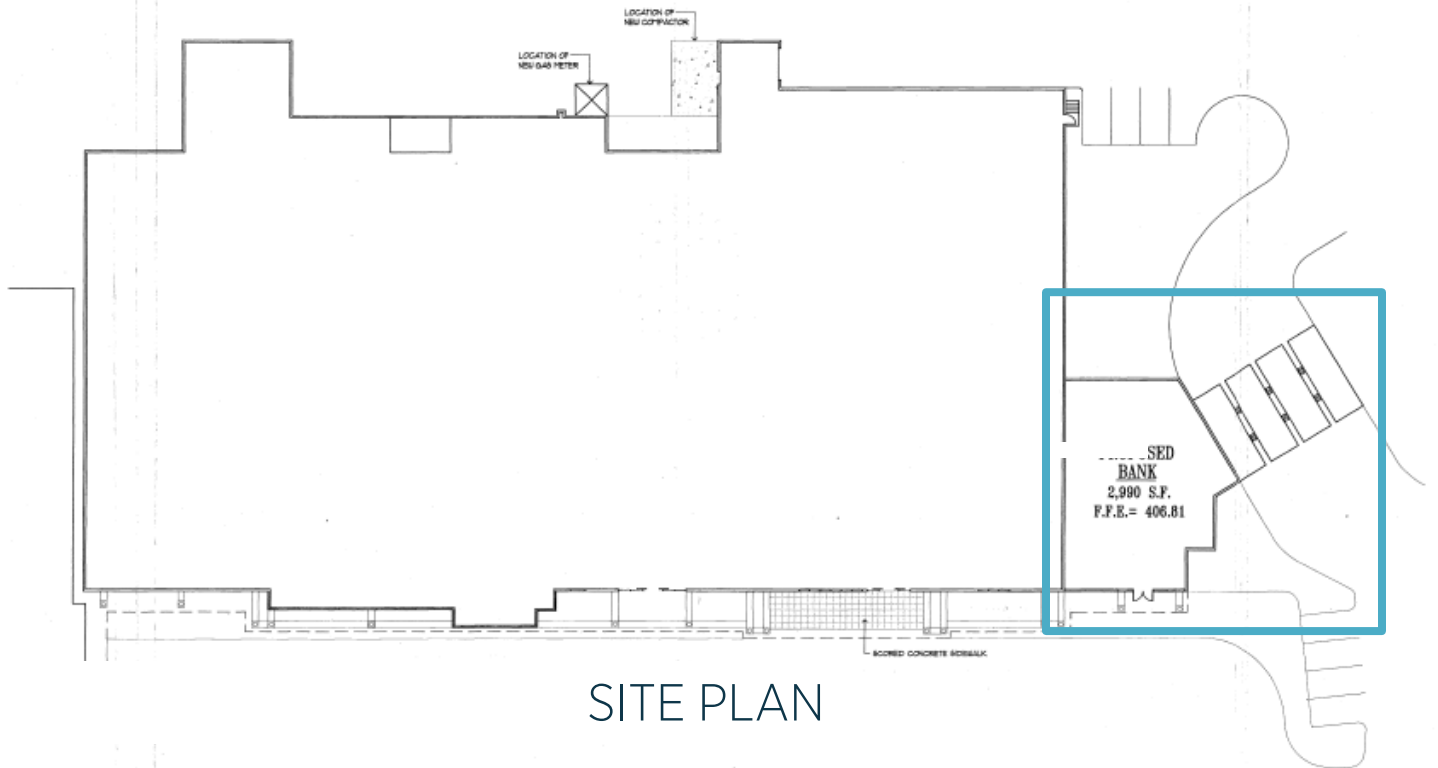

FOR INFORMATION, PLEASE CONTACT:

PAUL E. GIANNONE

Executive Managing Director

732 452 6184

paul.giannone@cushwake.com

KEVIN CARTON

Executive Managing Director

732 452 6186

kevin.carton@cushwake.com

BRODY STRICKLAND

Associate

732 452 6163

brody.strickland@cushwake.com

99 Wood Avenue South, Suite 800

Iselin, NJ 08830

cushmanwakefield.com



CUSHMAN & WAKEFIELD