

FOR SALE



3211 PEOPLES DRIVE, STE 130 | 3,750 SF | \$529,000

PROFESSIONAL PARK ON PEOPLES DRIVE IN THE **SOUTH END** OF HARRISONBURG, THIS **3,750 SF DOUBLE-UNIT** CONDOMINIUM OFFERS A FLEXIBLE, PRIMARILY **OPEN LAYOUT** WITH **TWO PRIVATE ENTRANCES** AND **STRONG FUNCTIONALITY** FOR A VARIETY OF BUSINESS USES. THE SPACE SPANS **75' DEEP BY 50' WIDE**, PROVIDING CLEAN, EFFICIENT DEPTH FOR **WORKSPACE PLANNING, OPERATIONS, OR CLIENT-FACING** ENVIRONMENTS.



JEFF ROBB | 540-478-7616
JEFFREYMROBB@GMAIL.COM

Lee & Associates
COMMERCIAL REAL ESTATE BROKERAGE

WWW.LEEANDASSOC.COM

All information herein, including square footage, is believed to be accurate, but not guaranteed or warranted. Any and all parties are responsible for verifying information prior to leasing.

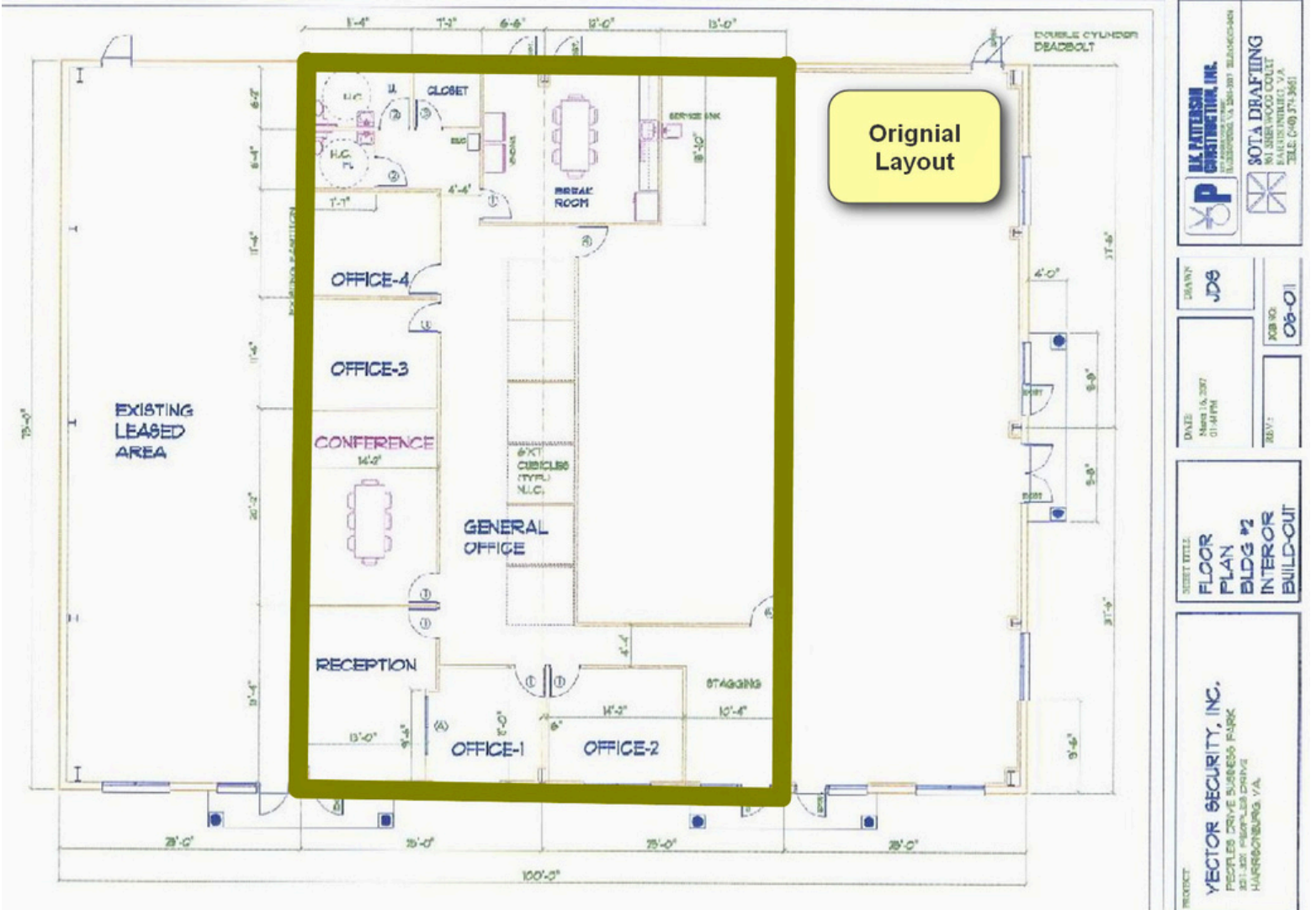

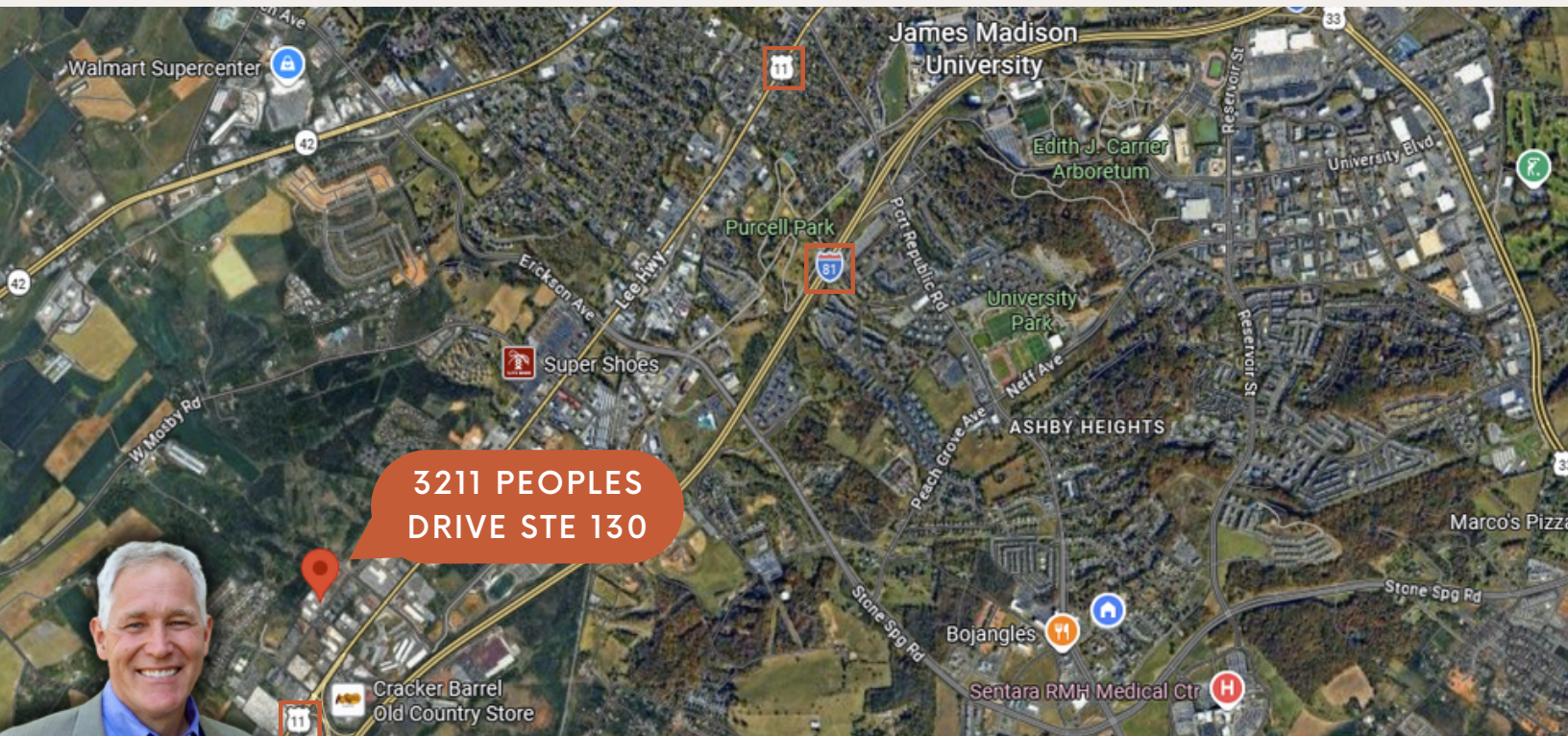

3211 PEOPLES DRIVE STE 130



JEFF ROBB | 540-478-7616
JEFFREYMROBB@GMAIL.COM

Lee & Associates
COMMERCIAL REAL ESTATE BROKERAGE

WWW.LEEANDASSOC.COM

All information herein, including square footage, is believed to be accurate, but not guaranteed or warranted. Any and all parties are responsible for verifying information prior to leasing.