

SUB-LEASE OPPORTUNITY

2500 N. SECOND STREET | MILLVILLE | CUMBERLAND COUNTY, NJ

JOIN  AT&T

[VIEW PROPERTY](#)



HIGHLIGHTS

- 1,247 SF space available for sub-lease
- Exceptional visibility along high-traffic retail corridor
- 50,662 AADT at the intersection of N. Second Street (Route 47), Old Union Road & ramps to Route 55
- Across the street from Cumberland Mall offering 941,146 SF of retail space
- Pylon signage and off-street parking

DEMOGRAPHICS

SOURCE: REGIS ONLINE

	1 MILE	3 MILE	5 MILE
POPULATION	1,553	27,299	71,895
AVERAGE HH INCOME	\$174,610	\$125,046	\$112,702
DAYTIME EMPLOYEES	3,284	17,199	33,769

TRAFFIC GENERATORS



The information contained herein has been obtained through sources deemed reliable by Soloff Realty & Development, Inc. but cannot be guaranteed for accuracy. We recommend that any information which is of special interest, should be obtained through independent verification. All measurements are approximate. Map Data @ 2023 Google | AADT provided by DVRPC

 Soloff Realty & Development, Inc.

ONE PRESIDENTIAL BLVD. SUITE 202
BALA CYNWYD, PA 19004 | SRDRE.COM

 ICSC
INNOVATING COMMERCE
SERVING COMMUNITIES

RICHARD L. SOLOFF
EXCLUSIVE AGENT
richard@srdre.com | 610-834-0400



FLOOR PLAN

1,247 SF SPACE FOR SUB-LEASE
25'10" X 46'6"

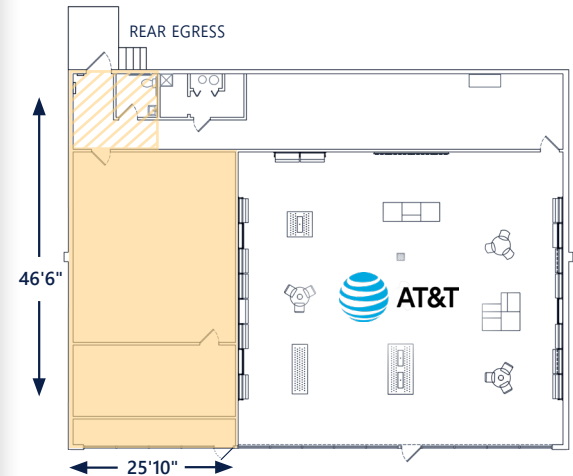

 COMMON SPACE



